

 **SCHONBEK** | 1870

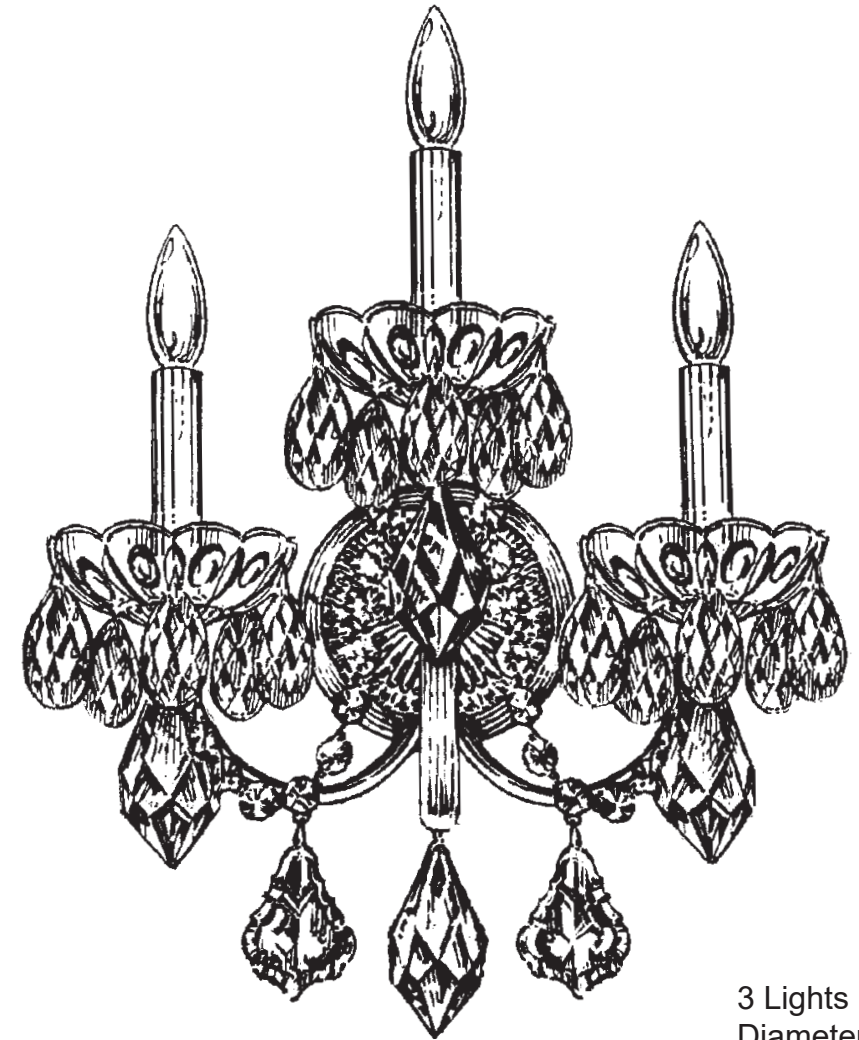









CENTURY 1703- _ _



THIS DESIGN IS THE PROPRIETARY TRADE DRESS/TRADEMARK OF W SCHONBEK LLC.

3 Lights
Diameter: 13"
Body Length: 17-1/2"
Extension: 6"
Hanging Weight: 4 lbs.

 **SCHONBEK** | 1870

								
MAX 60 W	110-120 V							

All electrical components must be installed by a licensed electrician in accordance with the National Electric Code and the appropriate local electrical codes.

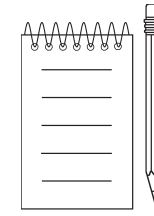
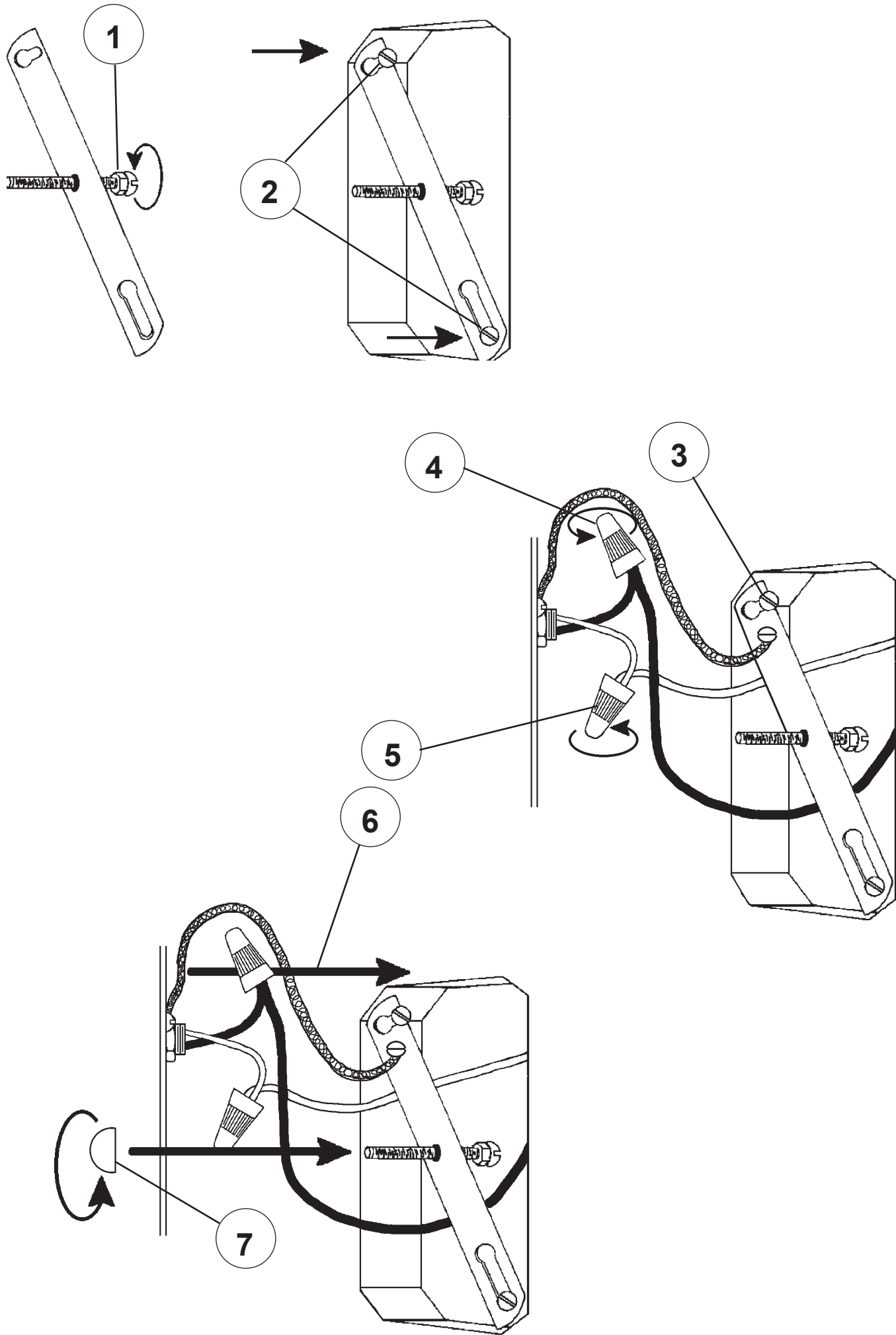



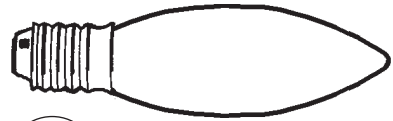

8

You will need 3 - B10
25 Watts Recommended
60 Watts Max

Install bulb and be sure
to test fixture **BEFORE**
trimming.

9763/1 = Gold Pins
9763/2 = Silver Pins

