

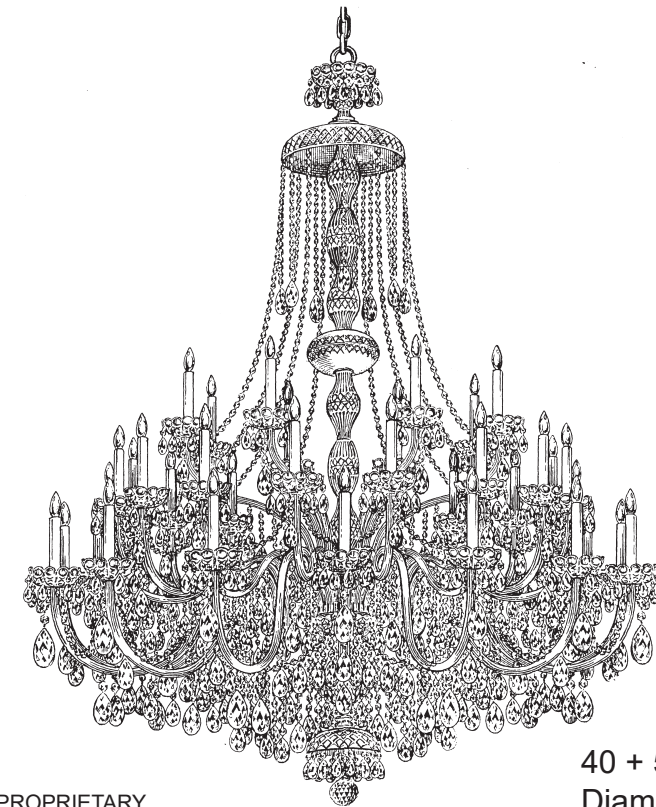

# CHANDELIER 3612- \_\_\_\_ H TRIM DIAGRAM

(Finish Option)



THIS DESIGN IS THE PROPRIETARY TRADE DRESS/TRADEMARK OF W SCHONBEK LLC.

40 + 5 Lights  
Diameter: 60"  
Body Length: 76"  
Hanging Weight: 176lbs.



CAUTION... RISK OF ELECTRICAL SHOCK. Make sure the electrical supply to the chandelier is turned off at the main fuse or circuit breaker before installing. All electrical components must be installed by a licensed electrician in accordance with the National Electric Code and the appropriate local electrical codes.

BULBS: 40 - B10, Flame shaped candelabra base bulbs, recommend 25 watts for best appearance.  
60 - Watts Maximum  
5 - B8 (Supplied), Flame shaped candelabra base bulbs, recommend 25 watts for best appearance.  
25 - Watts Maximum

WARNING: This chandelier meets UL/CSA requirements. Any tampering will void UL/CSA certification.

**IMPORTANT**  
Please record the following information for future service.

CODE # \_\_\_\_\_ Four-digit number on outside of carton.  
PACKER # \_\_\_\_\_ See crystal package label.  
ORDER # \_\_\_\_\_ See crystal package label.

**CAUTION:** Glass parts are fragile. To avoid breakage use care when assembling or cleaning.

**WHEN ORDERING REPLACEMENT ARM(S):**

- ◆ Give arm number from trim diagram
- ◆ Give color code from the arm itself

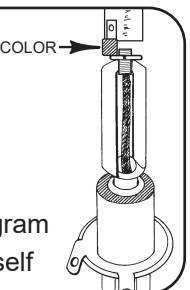

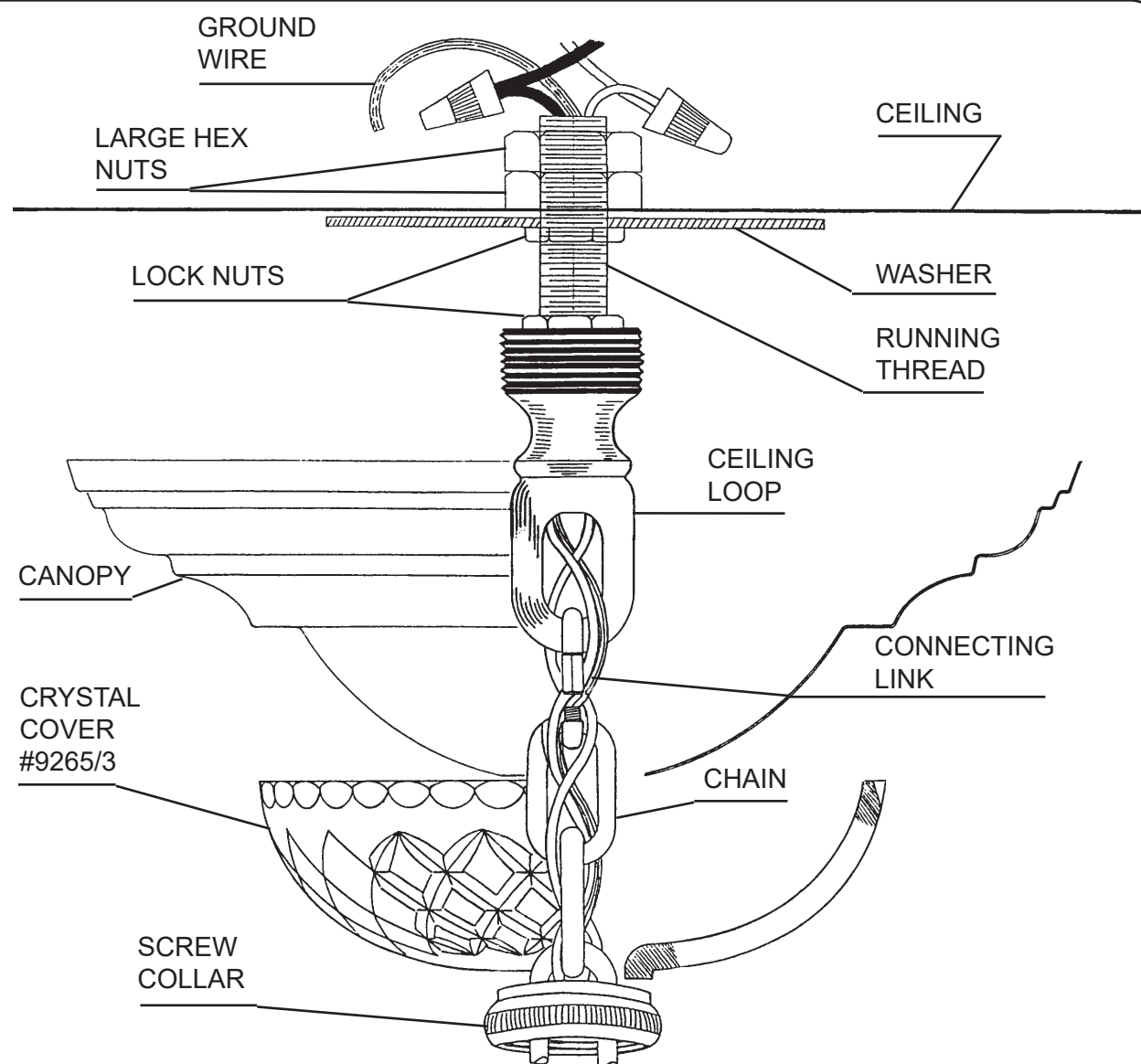

- 1 MAKE SURE THAT POWER TO THE OUTLET BOX IS DISCONNECTED!! IMPORTANT: NEUTRAL WIRE IS WHITE GROUND WIRE IS BARE OR GREEN**
- 2** Attach washer to supporting member in ceiling sufficient to support weight of fixture.
- 3** Slip screw collar, crystal cover and metal canopy over chain and then determine at what length of the fixture is to be suspended. Join the required length of fixture chain to connecting link on stem of fixture and loop attached to ceiling canopy at other end.
- 4** Insert stem wire through chain, through loop at canopy end, and attach to power wires in outlet box. Fixture **MUST** be properly grounded.
- 5** Be sure that proper distance from ceiling to loop is maintained to insure canopy is flush against ceiling. Attach canopy to ceiling with screw collar, thereby retaining complete fixture against ceiling.

## MAINTENANCE:

Use a damp chamois to clean the glass frame.  
Use a soft, lint - free cloth to clean the large arm washer.

**UNDER NO CIRCUMSTANCES SHOULD METAL POLISHES, CLEANERS, ABRASIVES OR AEROSOL SPRAYS BE USED.**

While the latest finishing techniques have been used on the metal frame, such finish cannot be unconditionally guaranteed. The main cause of deterioration, apart from certain atmospheric conditions, is improper cleaning.

To clean the crystals, polish with a damp chamois.

You are cleaning delicate jewelry... Take the greatest care.

## IMPORTANT:

Do not clean crystals in a dishwasher. The finish of the metal clips and hangers will be ruined and the crystals may be damaged.

## NOTES:

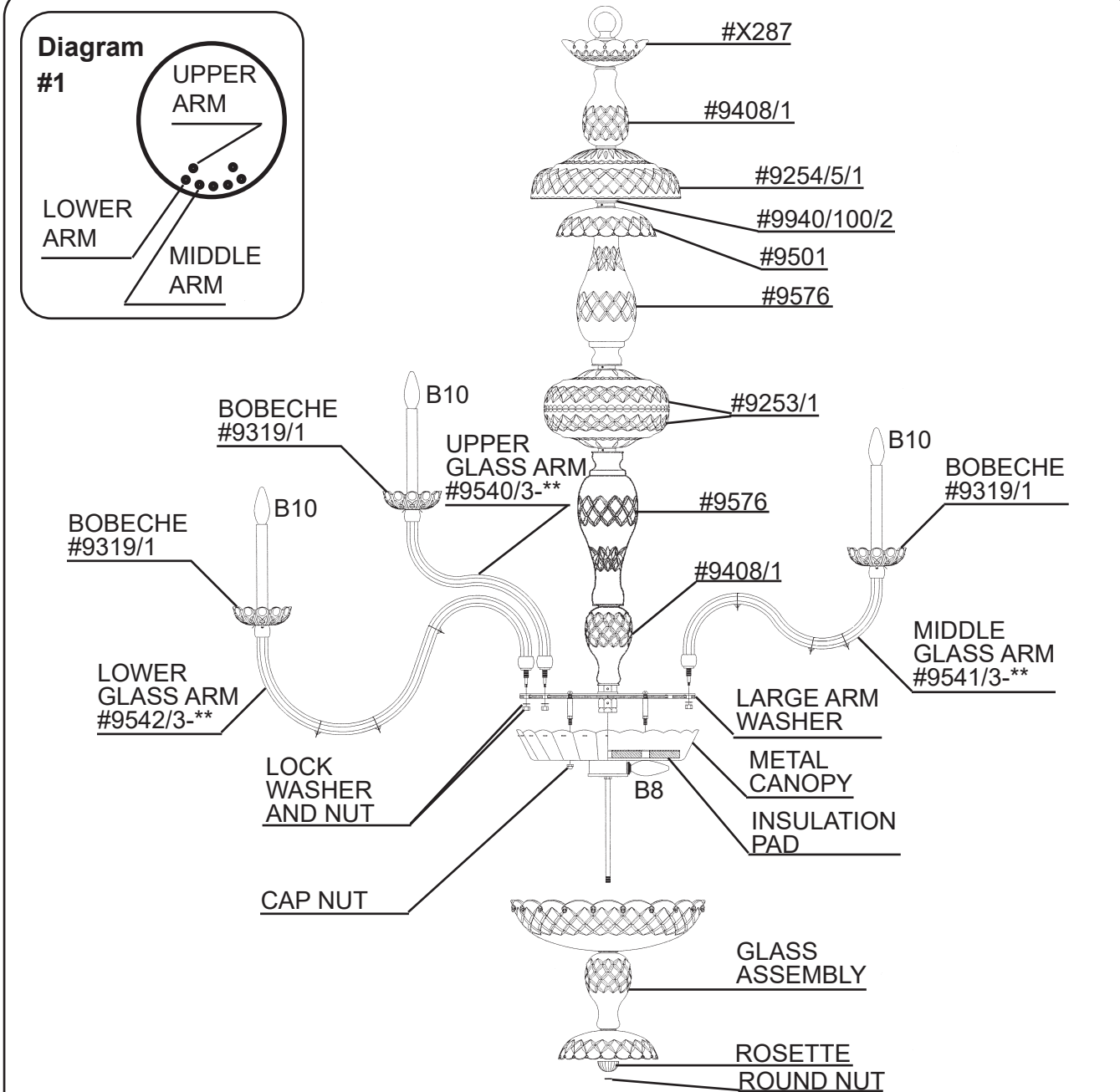

**6** Install arms into large arm washer. Line up holes in arms with dimple in washer. Use lock washer and nut to secure arms in place. **NOTE: Place 8 upper arms into inside diameter holes and ALTERNATE 16 middle and lower arms in outside diameter holes. For best appearance line-up lower arms with upper arms. See Diagram #1.**

**7** Connect bare ground wires in each arm to bare ground wire in center column. Use electrical tape to secure wire nuts. **NO MORE THAN 5 - WIRES PER WIRE NUT.** Sufficient quantities of jumper wires and wire nuts are provided.

**8** Connect white arm wires to neutral column wire (ribbed or marked is neutral). Connect black arm wires to power wire in column. Carefully press wires as close as possible to the underside of washer. Slide metal canopy with insulation pad to washer, attach with nuts to threaded studs. Install 5 - B8 bulbs (supplied) and slide glass assembly up running thread and attach with rosette and round nut.

**9** Install bulbs, connect power and test the fixture BEFORE trimming. If any of the bulbs do NOT light - DISCONNECT POWER. Double check the wire connections.

**Instructions for crystal trimming**  
**STEPS 10 - 34**

