



RENAISSANCE 3757- ___
3758- ___



3758

3757

THIS DESIGN IS THE PROPRIETARY
TRADE DRESS/TRADEMARK OF
W SCHONBEK LLC.

2 Lights
Diameter: 14"
Body Length: 22-1/2"
Extension: 4-1/2"
Hanging Weight: 5 lbs.



MAX 60 W	110-120 V							

All electrical components must be installed by a licensed electrician in accordance with the National Electric Code and the appropriate local electrical codes.

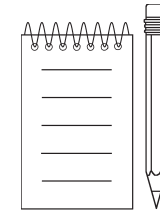
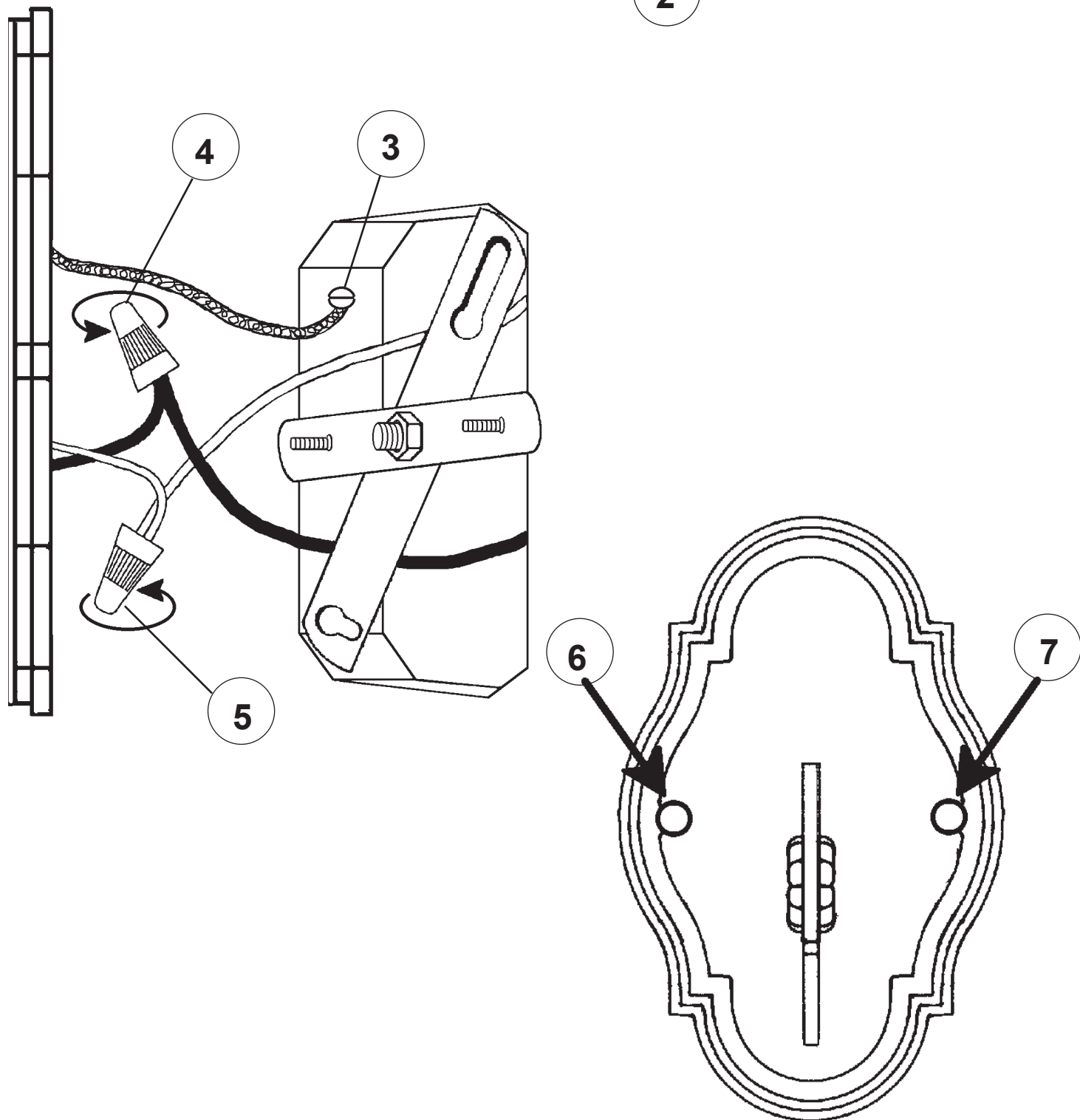
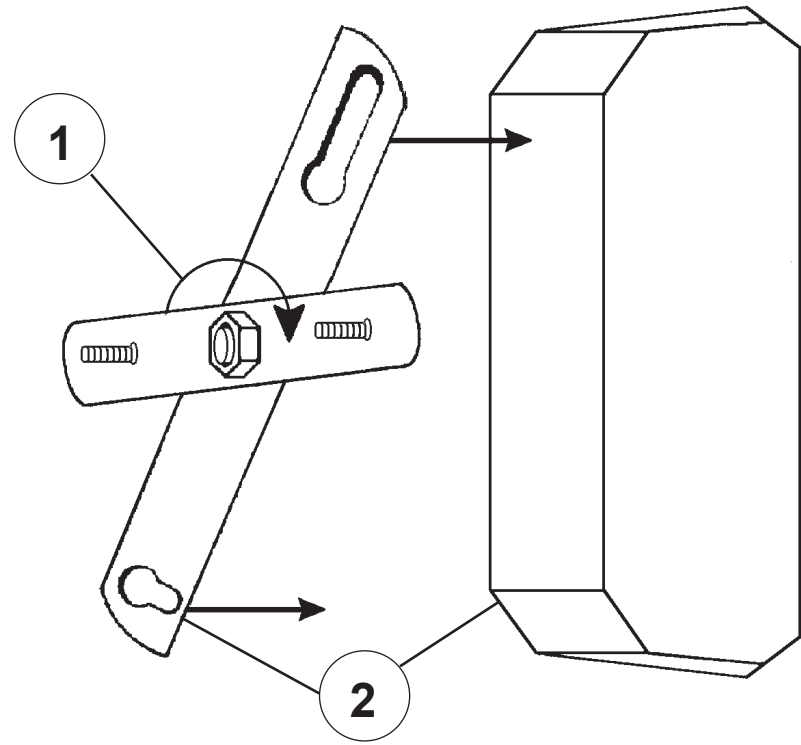

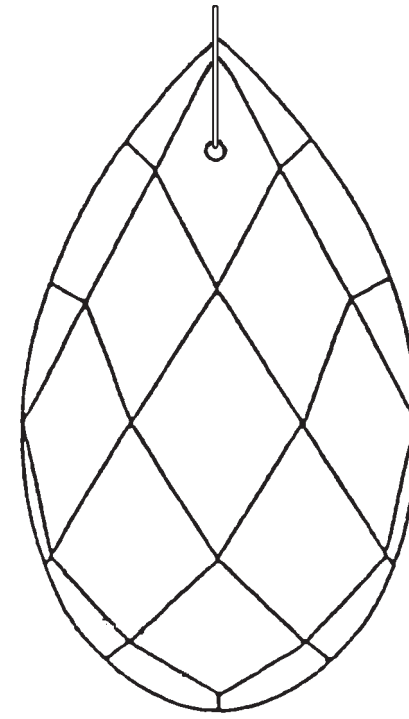

N4001
3-1/2"
89mm

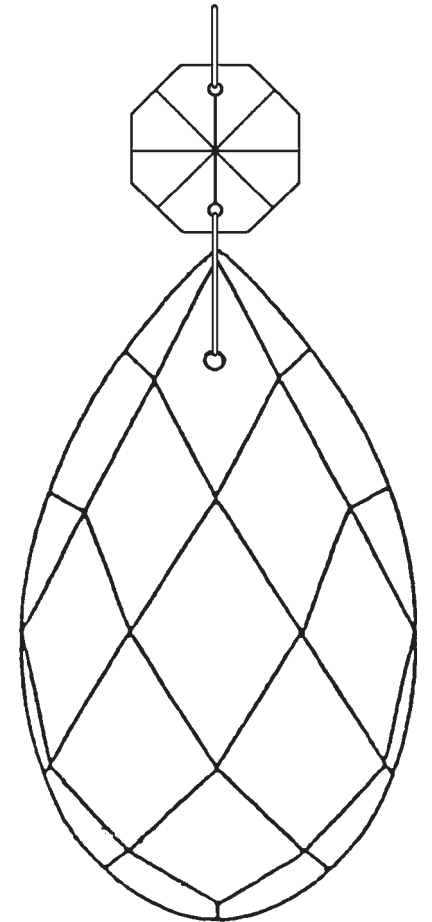

N4007
3-1/2"
89mm

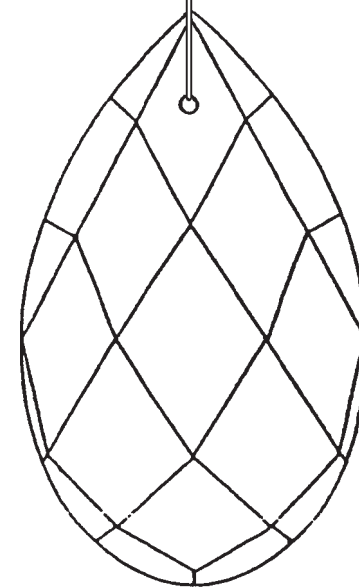
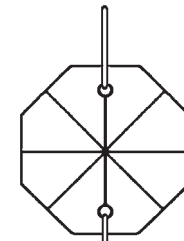

N4000
3"
76mm

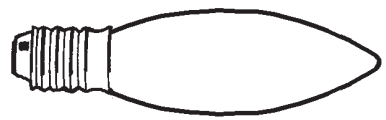

You will need 2 - B10
25 Watts Recommended
60 Watts Max

9

Install bulb and be sure
to test fixture BEFORE
trimming.

3758-___ (LT)

3757-___ (RT)

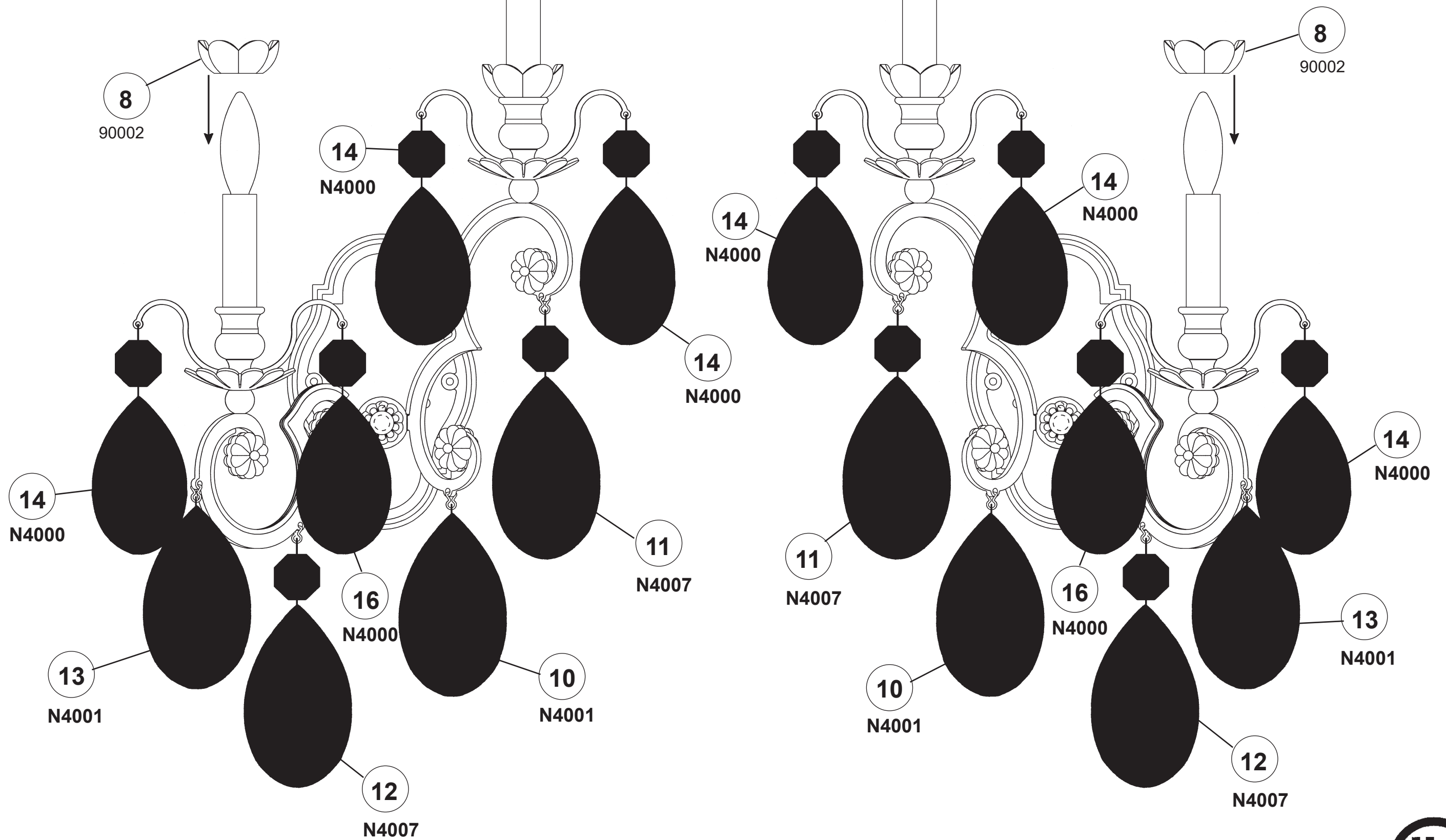

RENAISSANCE 3757- _____
 3758- _____



3758

3757

2 Lights
 Diameter: 14"
 Body Length: 22-1/2"
 Extension: 4-1/2"
 Hanging Weight: 5 lbs.

THIS DESIGN IS THE PROPRIETARY
 TRADE DRESS/TRADemark OF
 W SCHONBEK LLC.



MAX 60 W	110-120 V							

All electrical components must be installed by a licensed electrician in accordance with the National Electric Code and the appropriate local electrical codes.

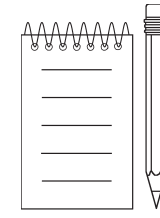
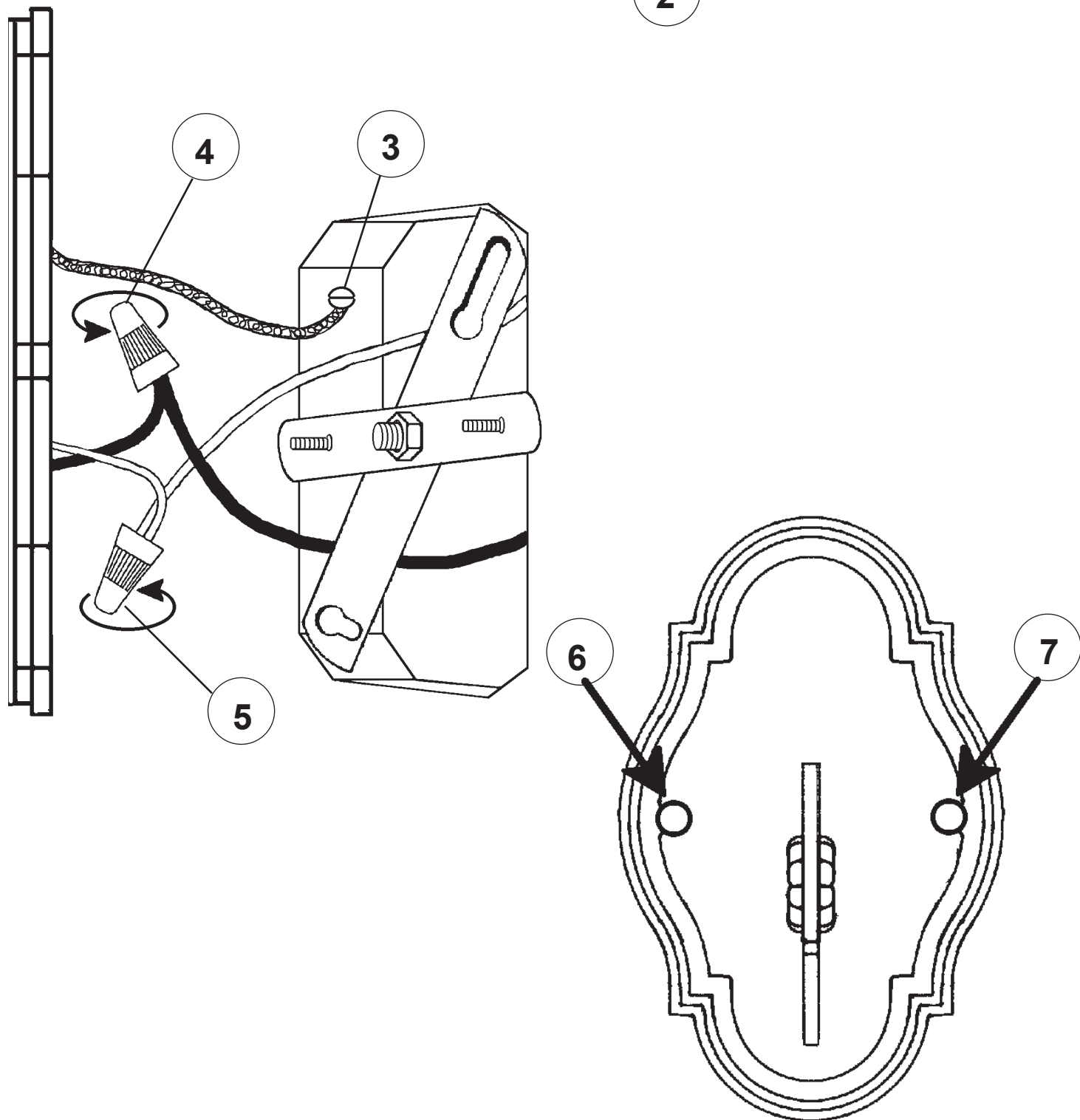
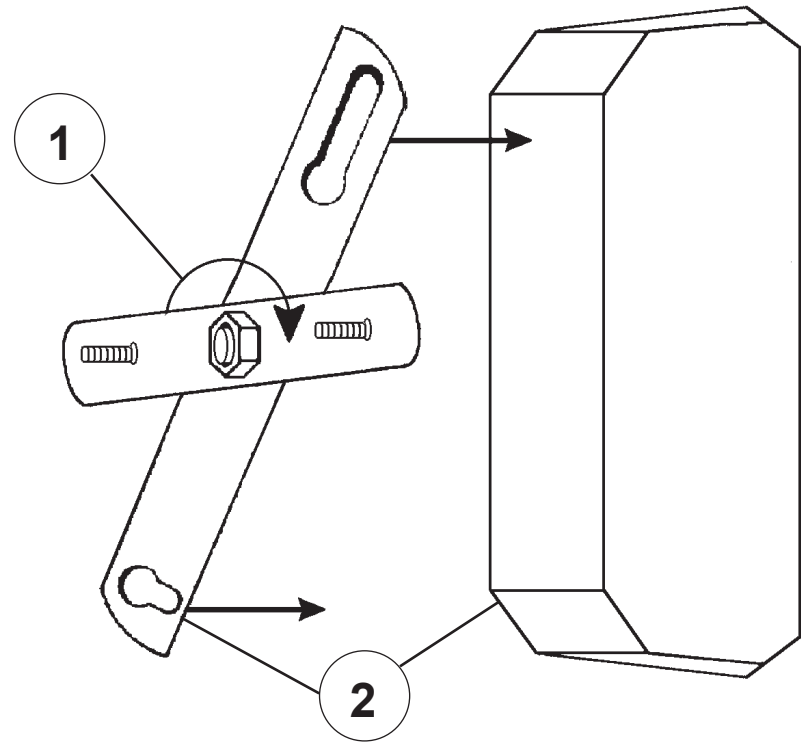

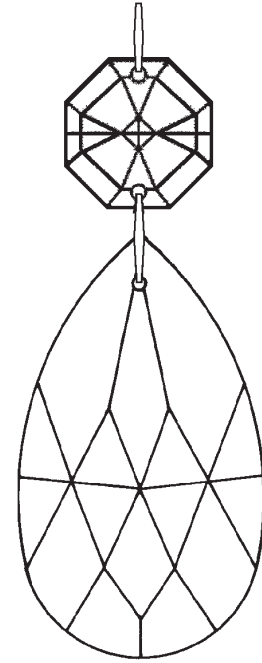
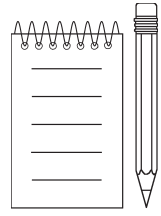

N4003-**
2-1/2"
63mm

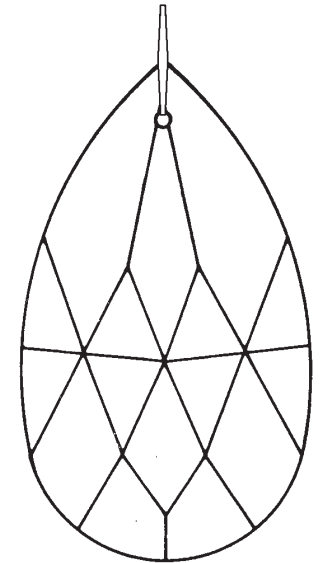

N4004-**
3"
76mm

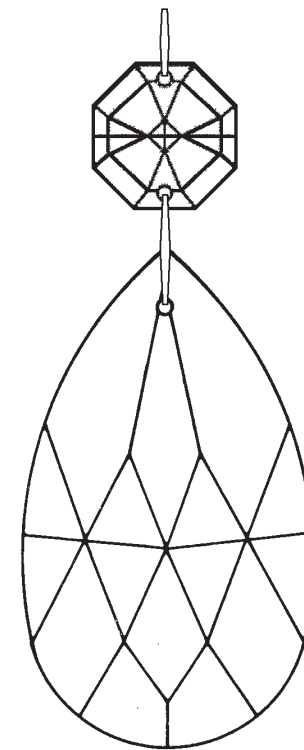

N4000-**
3"
76mm

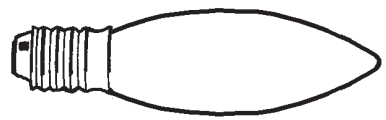

You will need 2 - B10
25 Watts Recommended
60 Watts Max

9

Install bulb and be sure
to test fixture **BEFORE**
trimming.

3758-_____(LT)

3757-_____(RT)

