

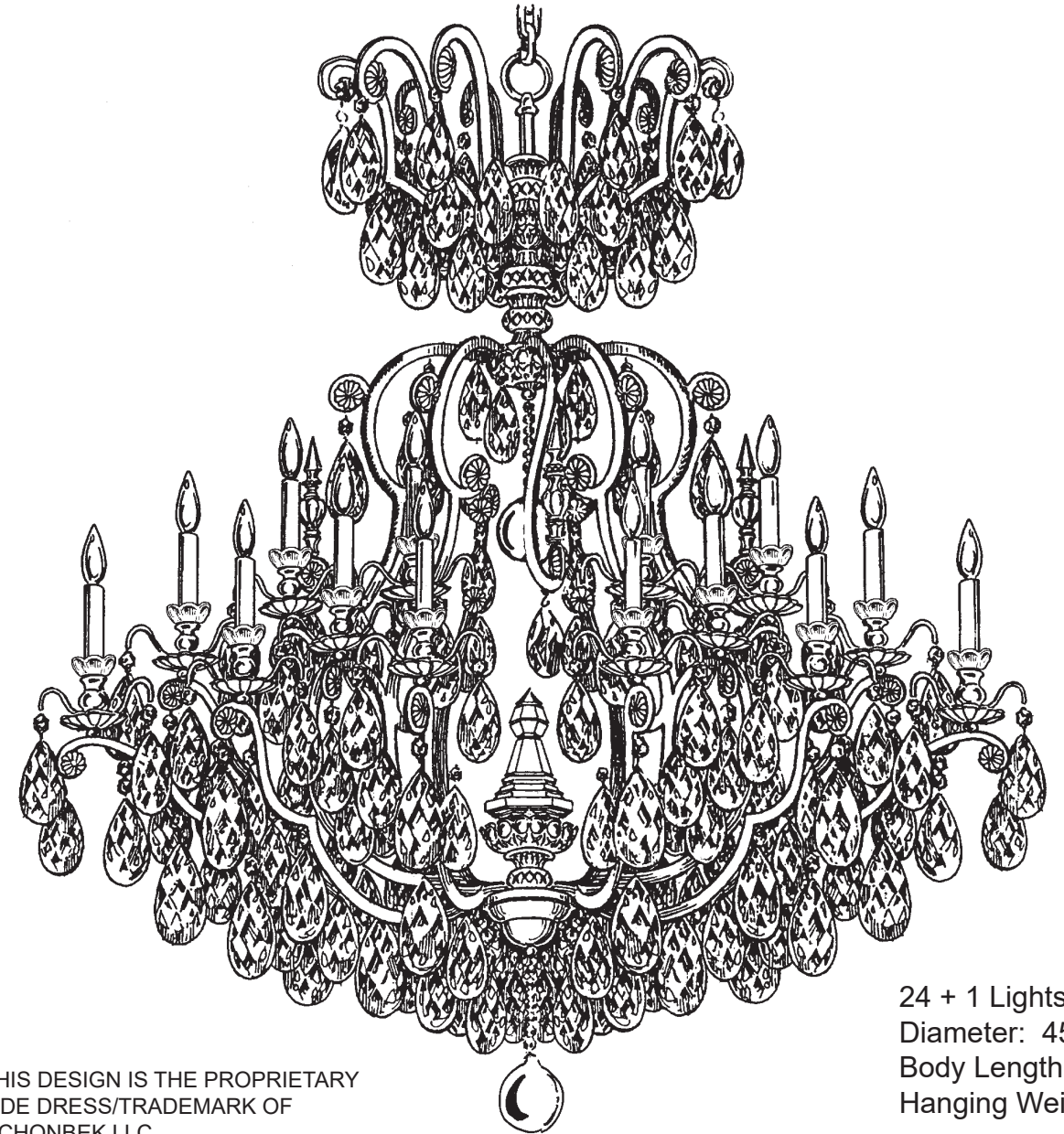

CHANDELIER 3774- _____ TRIM DIAGRAM

(Finish Option)



24 + 1 Lights
Diameter: 45"
Body Length: 52"
Hanging Weight: 137 lbs.

THIS DESIGN IS THE PROPRIETARY TRADE DRESS/TRADEMARK OF W SCHONBEK LLC.



**Follow steps in exact order
Save this trim diagram for future reference**

1

IMPORTANT

Person who opens carton should record the following information for future service.

CODE # _____ Four-digit number on outside of carton.
PACKER # _____ See crystal package label.
ORDER # _____ See crystal package label.

Instructions for electrician

STEPS 2 - 21

WARNING: THIS LUMINAIRE MUST BE MOUNTED OR SUPPORTED INDEPENDENTLY OF AN OUTLET BOX.

2 **WARNING:**

Electrical Danger Turn Power Off

All electrical components must be installed by a licensed electrician in accordance with the National Electric Code and the appropriate local electrical codes.

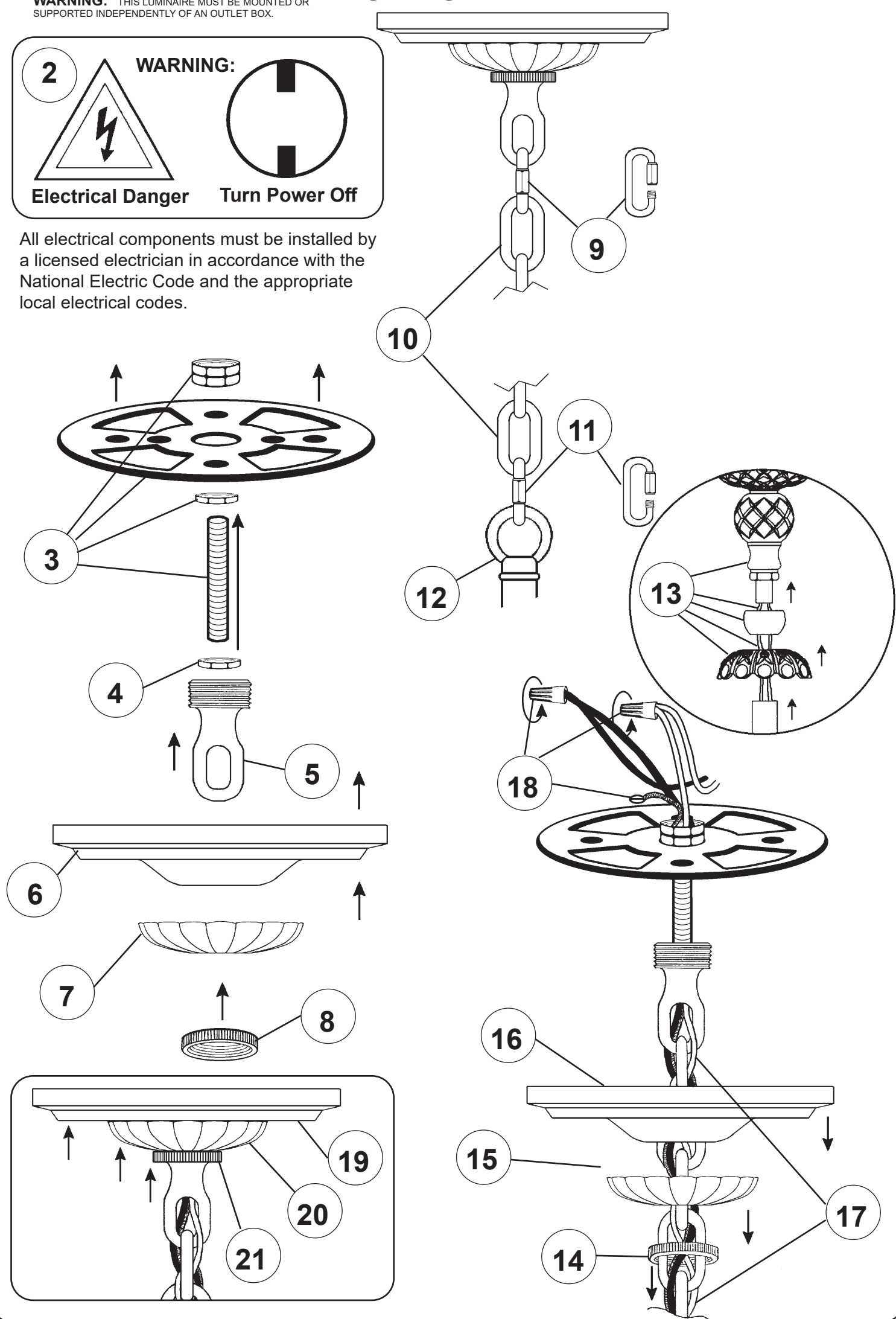

SET #1

N4004	N4000	N4023	N4002	N4007	N4012	N4025	N4024
3"	3"	3"	3-1/2"	3-1/2"	4"	4-1/2"	4-1/2"
76mm	76mm	76mm	89mm	89mm	100mm	114mm	114mm

SET #2

N4004	N4000	N4007	N4016	N4022	N4021	N4025	N4026
3"	3"	3-1/2"	4"	4"	4-1/2"	4-1/2"	4-1/2"
76mm	76mm	89mm	100mm	100mm	114mm	114mm	114mm

SET #3

N4000	N4010	N4020	N4007	N4002	N4019	N4022	N4013	N4021
3"	3"	3"	3-1/2"	3-1/2"	3-1/2"	4"	4"	4-1/2"
76mm	76mm	76mm	89mm	89mm	89mm	100mm	100mm	114mm

Crystal Set #3 in Black

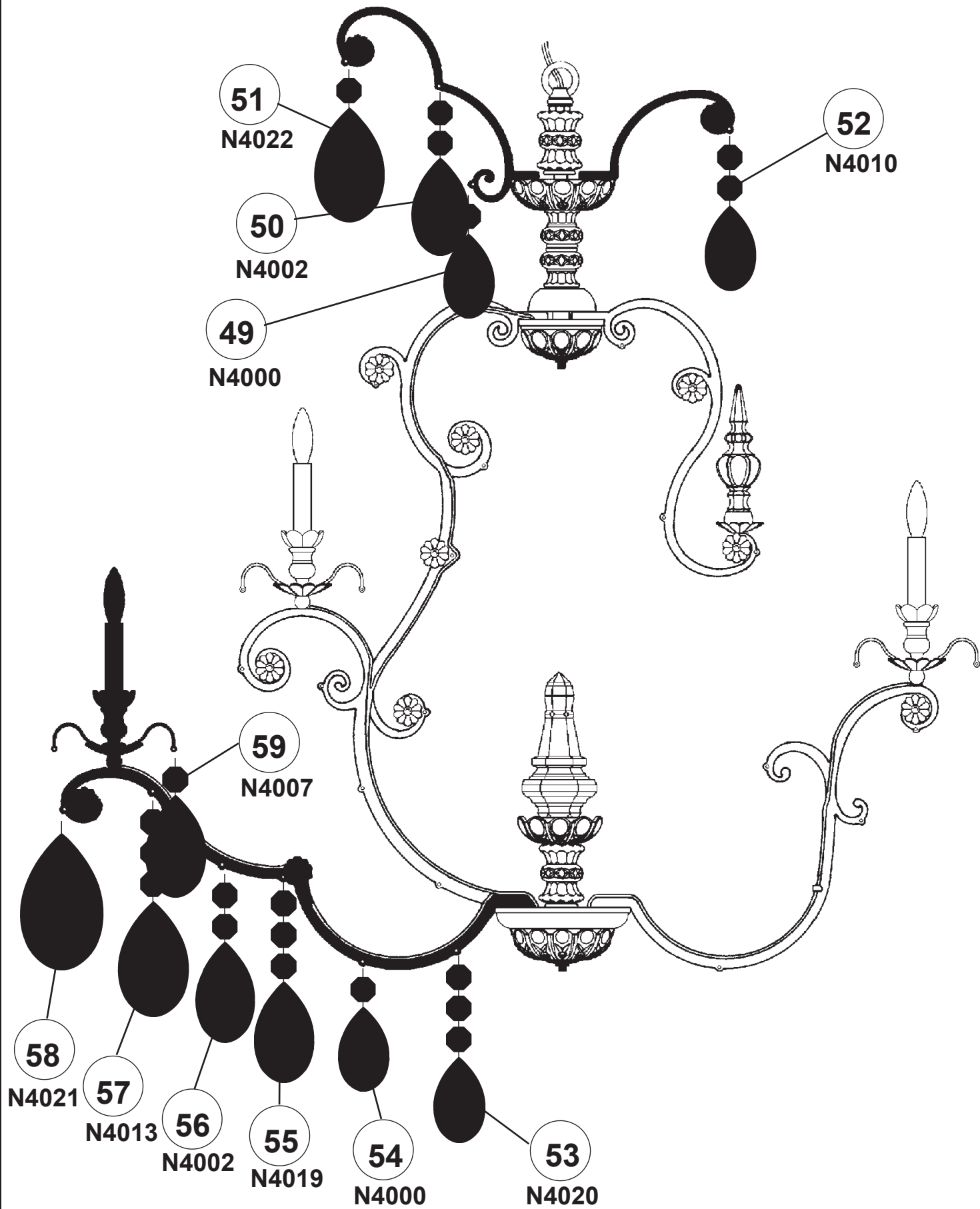

For easy removal of crystal from bubble pack, please cut along pouches on the inside of the seam. Gently remove crystal from the side of the pouch.

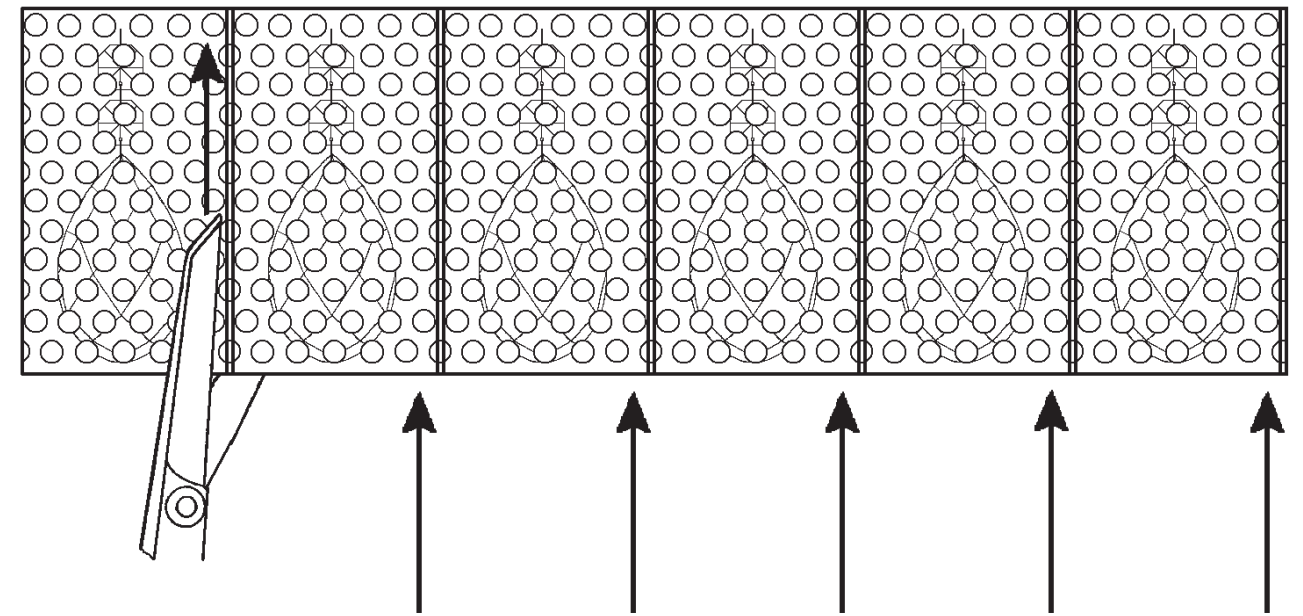

NOTE: Work on one crystal set at a time. Follow the black line from top to bottom according to the numbered steps on the trim diagram.

Instructions for crystal trimming
STEPS 22 - 59

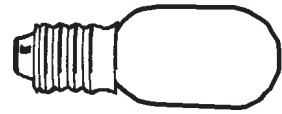

You will need 1 - T7
15 Watts Max
(Center Light)

23

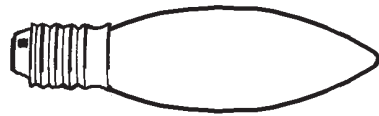

You will need 24 - B10
25 Watts Recommended
60 Watts Max

Install bulbs and be sure
to test fixture **BEFORE**
trimming.

FIXTURE INCLUDES:
Hanger Hardware
Trim - Frame
1 - T7 Light Bulb

DOES NOT INCLUDE:
B10 - Light Bulbs

27

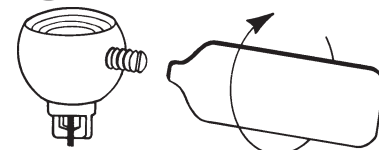

Tighten With
Tool Provided.

Crystal Set #1 in Black

28
N4000

32
N4025

26
N406

25
#9551/150/1

22
#90002

30
N4002

29
N4004

39
N4007

24
#9552/180

31
N4007

38
N4025

37
N4024

36
N4012

34

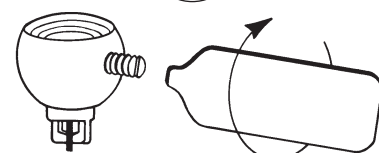

Tighten With
Tool Provided.

35
N4023

33
N405

Crystal Set #2 in Black

#9418

#9319

#9419

#9419

40

N4004

#9302

41
N4000

43

N4021

48

N4007

42
N4022

47
N4026

#9302

#9418

#9319

45
N4025

44

N4000

46

N4016



**SPARE PARTS KIT
PROVIDED.**

 **SCHONBEK** | 1870

CHANDELIER 3774- _____ TRIM DIAGRAM

(Finish Option) (Trim Option)



24 + 1 Lights
Diameter: 45"
Body Length: 52"
Hanging Weight: 137 lbs.

THIS DESIGN IS THE PROPRIETARY TRADE DRESS/TRADEMARK OF W SCHONBEK LLC.

 **SCHONBEK** | 1870

**Follow steps in exact order
Save this trim diagram for future reference**

1

IMPORTANT

Person who opens carton should record the following information for future service.

CODE # _____ Four-digit number on outside of carton.
PACKER # _____ See crystal package label.
ORDER # _____ See crystal package label.

Instructions for electrician

STEPS 2 - 21

WARNING: THIS LUMINAIRE MUST BE MOUNTED OR SUPPORTED INDEPENDENTLY OF AN OUTLET BOX.

2 **WARNING:**

Electrical Danger Turn Power Off

All electrical components must be installed by a licensed electrician in accordance with the National Electric Code and the appropriate local electrical codes.

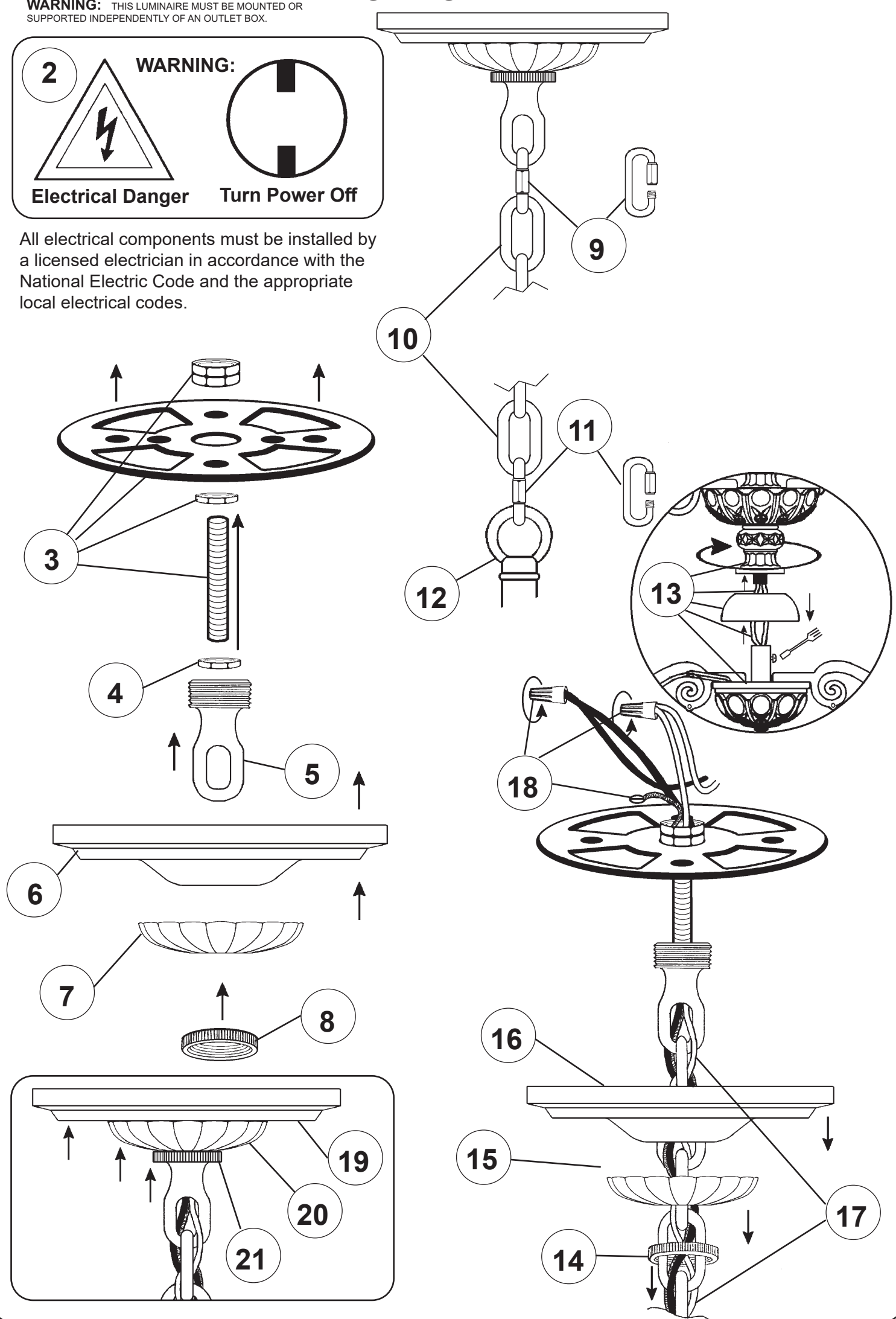

SET #1

N2793-**	N4003-**	N4015-**	N4018-**	N4020-**	N4007-**	N4002-**	N4040-**
2" 50mm	2-1/2" 63mm	2-1/2" 63mm	2-1/2" 63mm	3" 76mm	3-1/2" 89mm	3-1/2" 89mm	3-1/2" 89mm

SET #2

N4044-**	N4003-**	N4015-**	N4004-**	N4000-**	N4001-**	N4002-**	N4019-**
2" 50mm	2-1/2" 63mm	2-1/2" 63mm	3" 76mm	3" 76mm	3-1/2" 89mm	3-1/2" 89mm	3-1/2" 89mm

SET #3

N4003-**	N4015-**	N4018-**	N4010-**	N4020-**	N4007-**	N4019-**
2-1/2" 63mm	2-1/2" 63mm	2-1/2" 63mm	3" 76mm	3" 76mm	3-1/2" 89mm	3-1/2" 89mm

Crystal Set #3 in Black

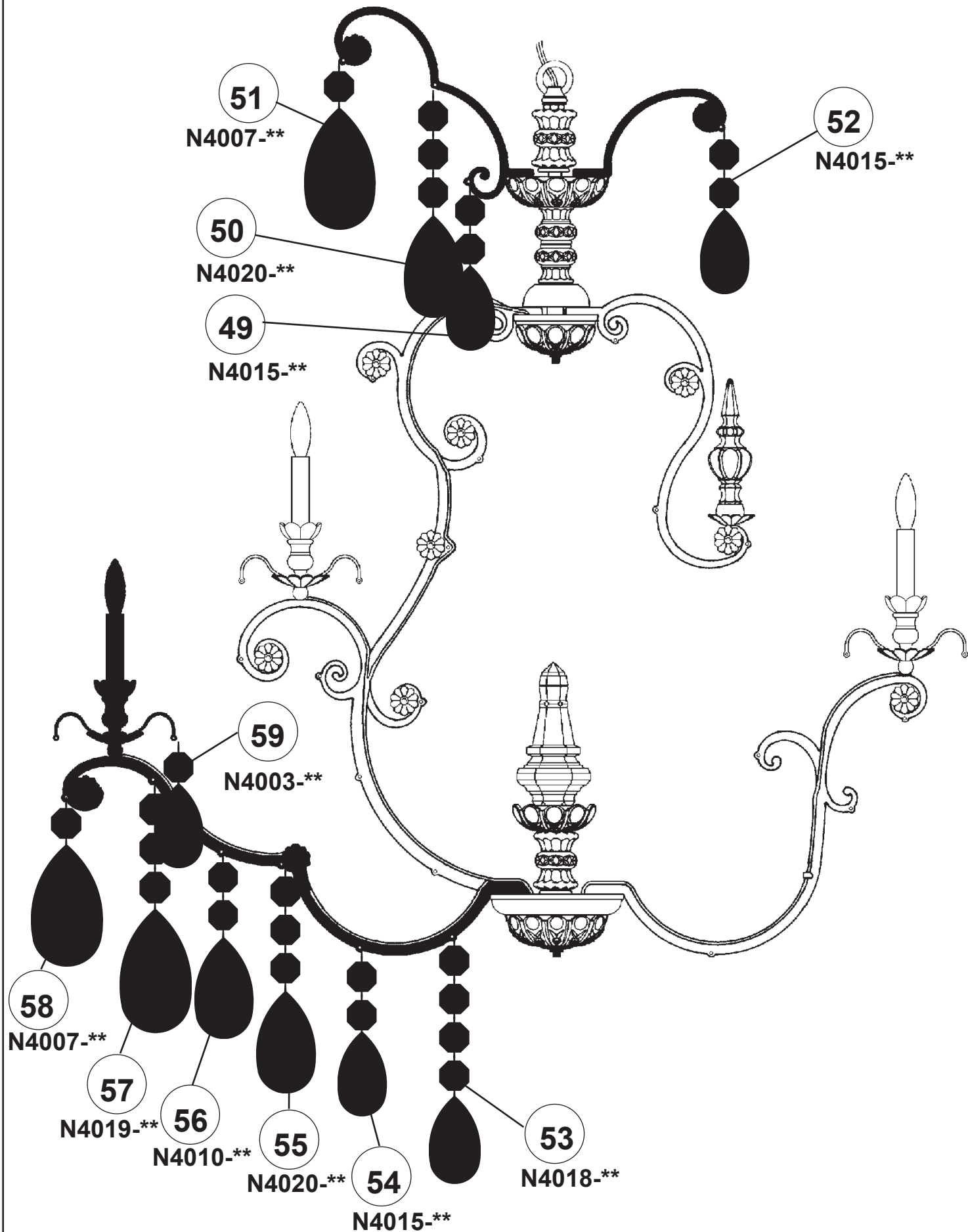

For easy removal of crystal from bubble pack, please cut along pouches on the inside of the seam. Gently remove crystal from the side of the pouch.

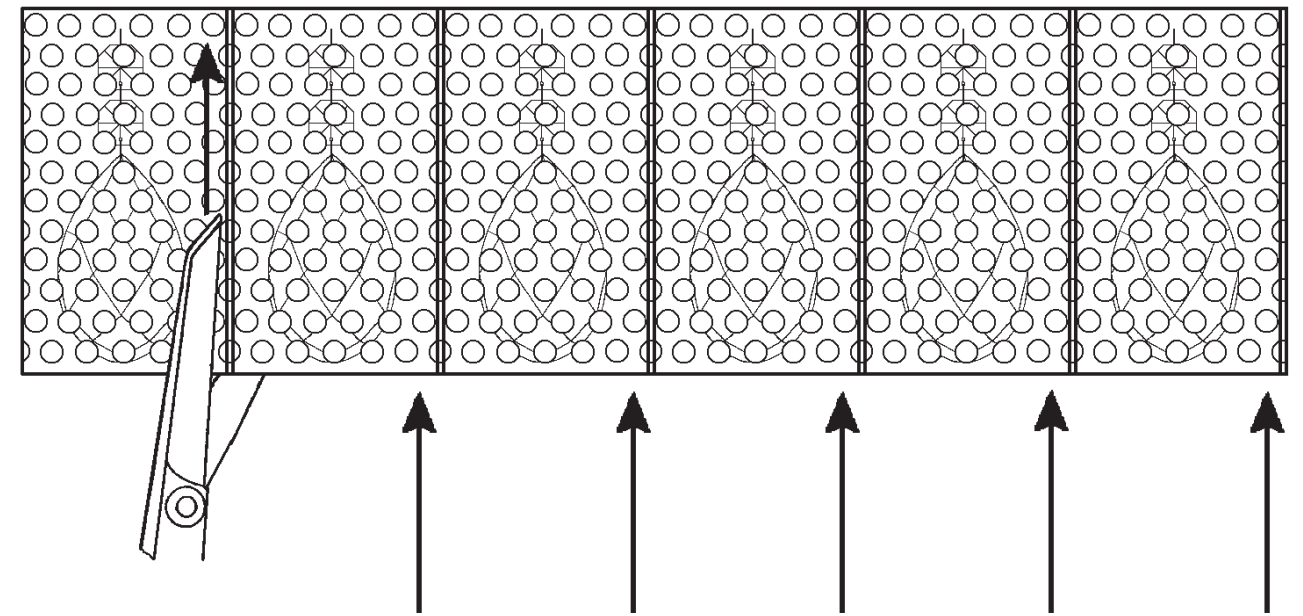

NOTE: Work on one crystal set at a time. Follow the black line from top to bottom according to the numbered steps on the trim diagram.

Instructions for crystal trimming
STEPS 22 - 59

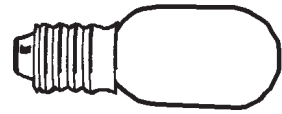

You will need 1 - T7
15 Watts Max
(Center Light)

23

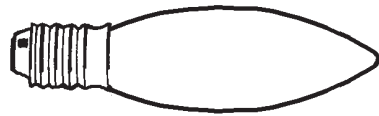

You will need 24 - B10
25 Watts Recommended
60 Watts Max

Install bulbs and be sure
to test fixture **BEFORE**
trimming.

FIXTURE INCLUDES:
Hanger Hardware
Trim - Frame
1 - T7 Light Bulb

DOES NOT INCLUDE:
B10 - Light Bulbs

27

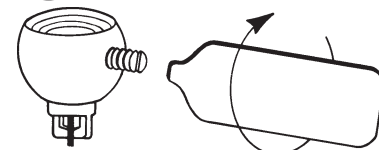

Tighten With
Tool Provided.

Crystal Set #1 in Black

28

N2793-**

32

N4007-**

30

N4015-**

22

#90002

39

N4003-**

38

N4002-**

37

N4040-**

36

N4020-**

35

N4018-**

26

N11124-**

29

N2793-**

24

#9552/180

31

N4003-**

33

N11125-**-**

25

#9551/150/1

34

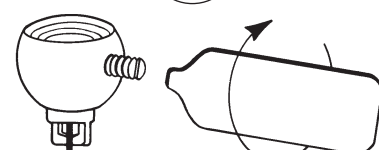

Tighten With
Tool Provided.

Crystal Set #2 in Black

#9418

#9319

#9419

#9419

#9302

#9302

#9418

#9319

40

N4044-**

41

N4044-**

43

N4001-**

48

N4003-**

42

N4000-**

47

N4019-**

45

N4002-**

46

N4004-**

44

N4015-**



**SPARE PARTS KIT
PROVIDED.**