

**Instructions for electrician
STEPS 2 - 9**

WARNING:

2

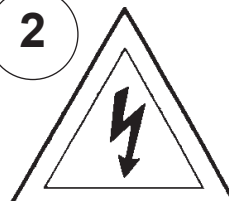

Electrical Danger

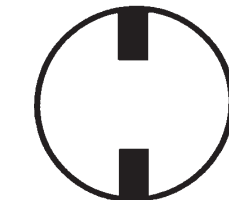

Turn Power Off

All electrical components must be installed by a licensed electrician in accordance with the National Electric Code and the appropriate local electrical codes.

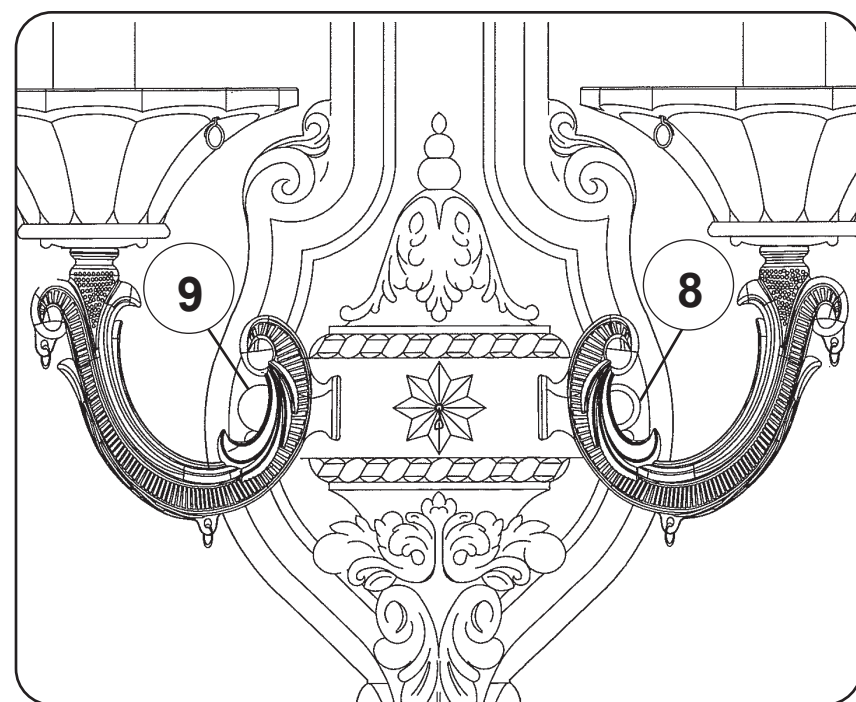
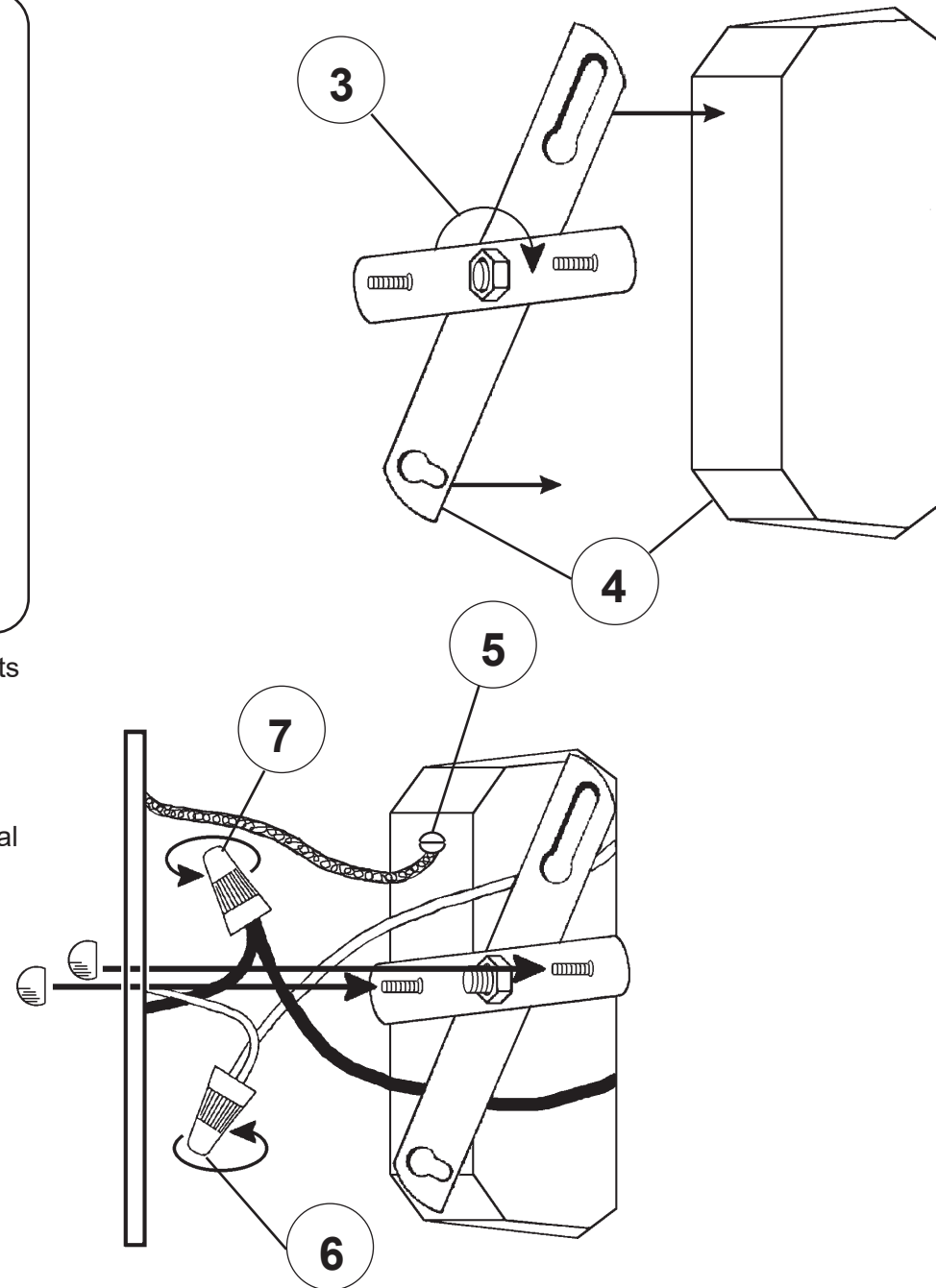

CHANDELIER 5070- _____ TRIM DIAGRAM
(Finish Option)

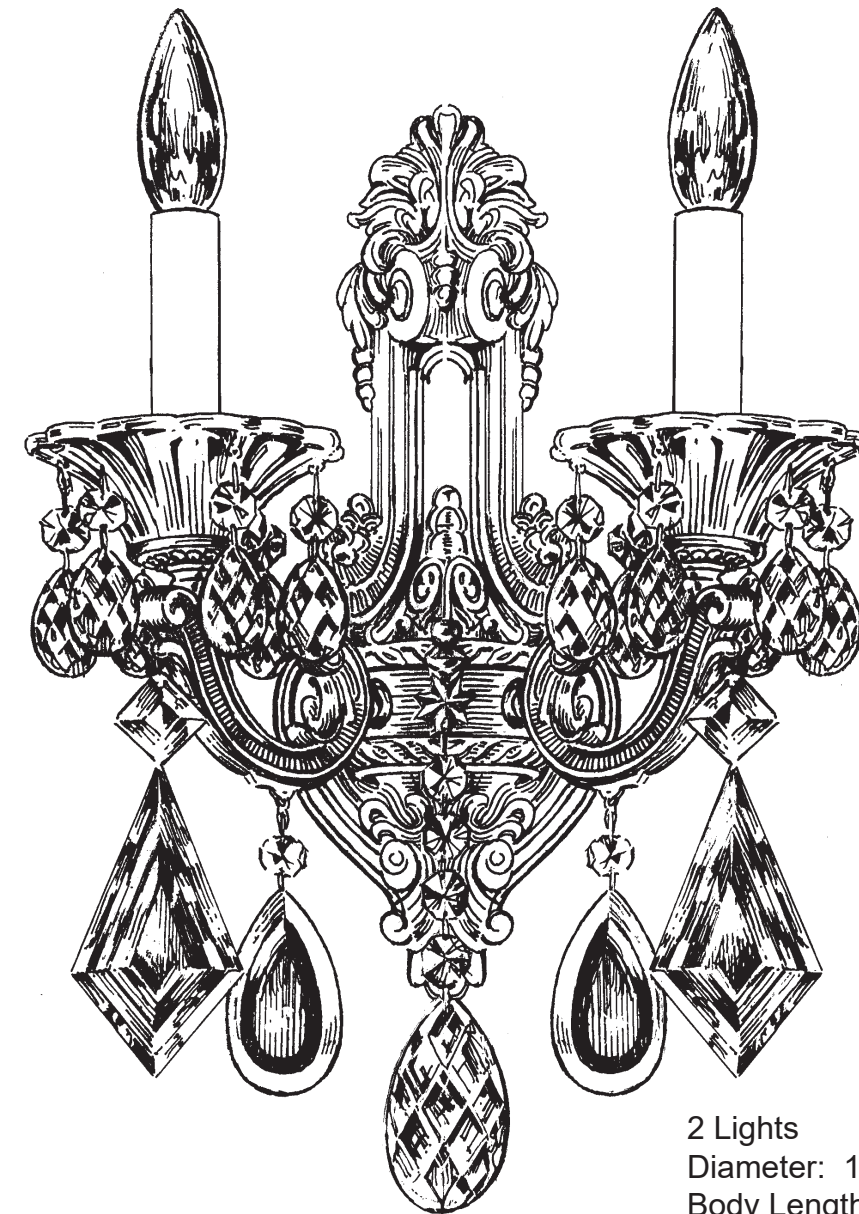

2 Lights
Diameter: 11-1/2"
Body Length: 16-1/2"
Extension: 6-1/2"
Hanging Weight: 4-1/2 pounds

THIS DESIGN IS THE PROPRIETARY TRADE DRESS/TRADemark OF W SCHONBEK LLC.



SCHONBEK | 1870

**See diagram on back page
Follow steps in exact order
Save this trim diagram for future reference**

1 **IMPORTANT**
Person who opens carton should record the following information for future service.

CODE # _____	Four-digit number on outside of carton.
PACKER # _____	See crystal package label.
ORDER # _____	See crystal package label.



Instructions for crystal trimming
STEPS 10 - 14

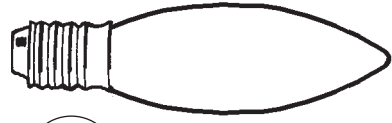

10

You will need 2 - B10
25 Watts Recommended
60 Watts Max

Install bulbs and be sure
to test fixture **BEFORE**
trimming.

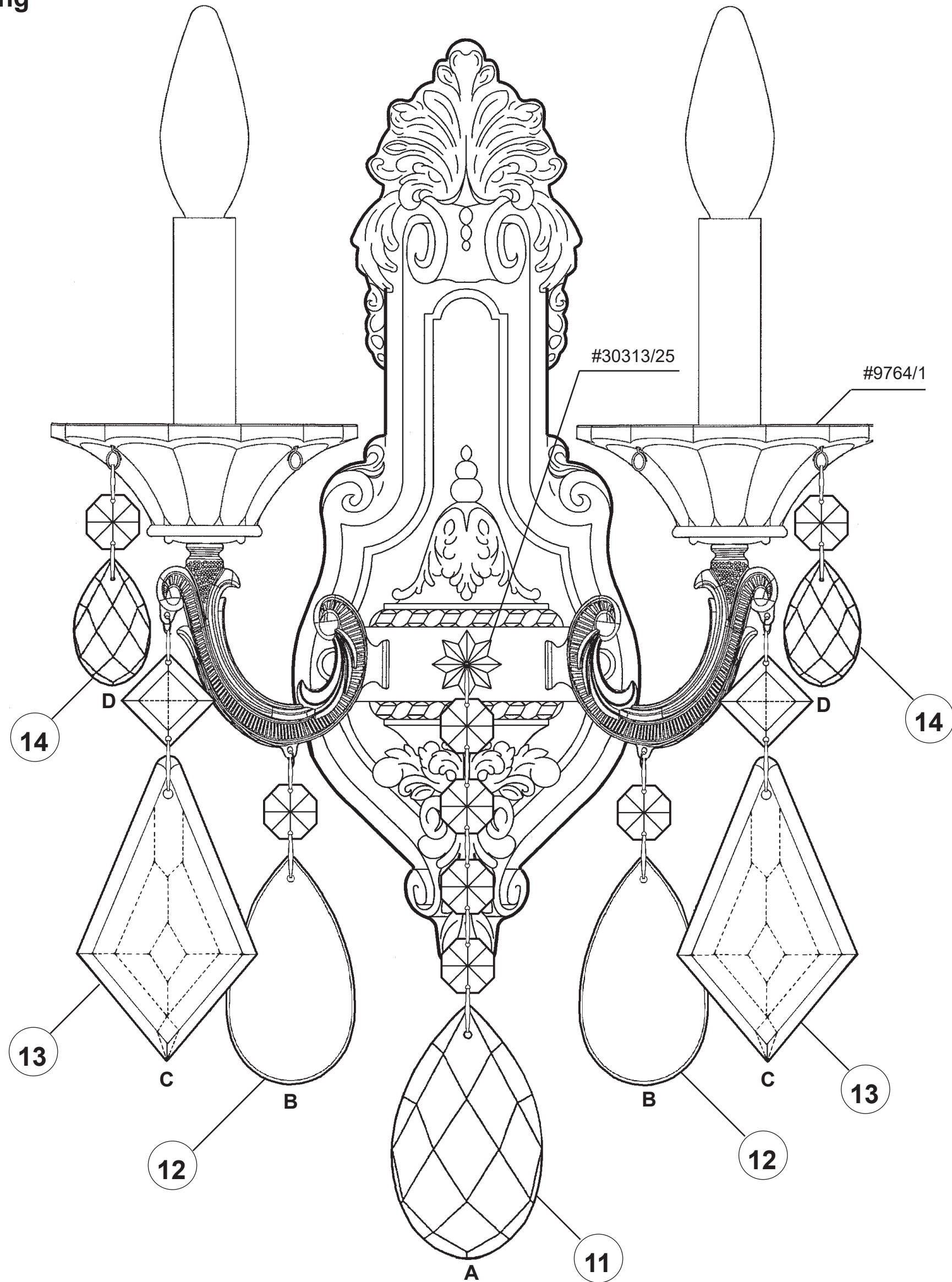

HANG
CRYSTAL
WITH FLAT
SIDE FACING
FRONT

The diagram shows a vertical crystal with a flat side. An arrow points to the right, indicating the direction to hang the crystal with the flat side facing forward.

**Instructions for electrician
STEPS 2 - 9**

WARNING:

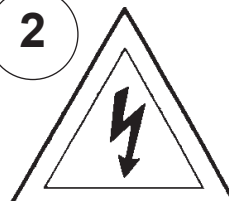
2 
Electrical Danger

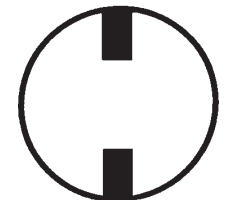
Turn Power Off

All electrical components must be installed by a licensed electrician in accordance with the National Electric Code and the appropriate local electrical codes.

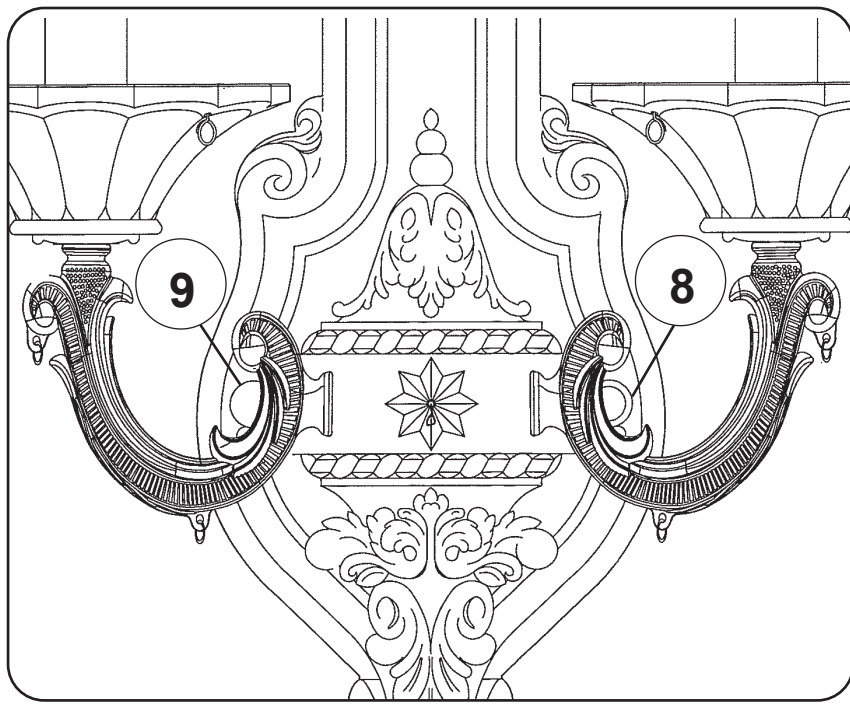
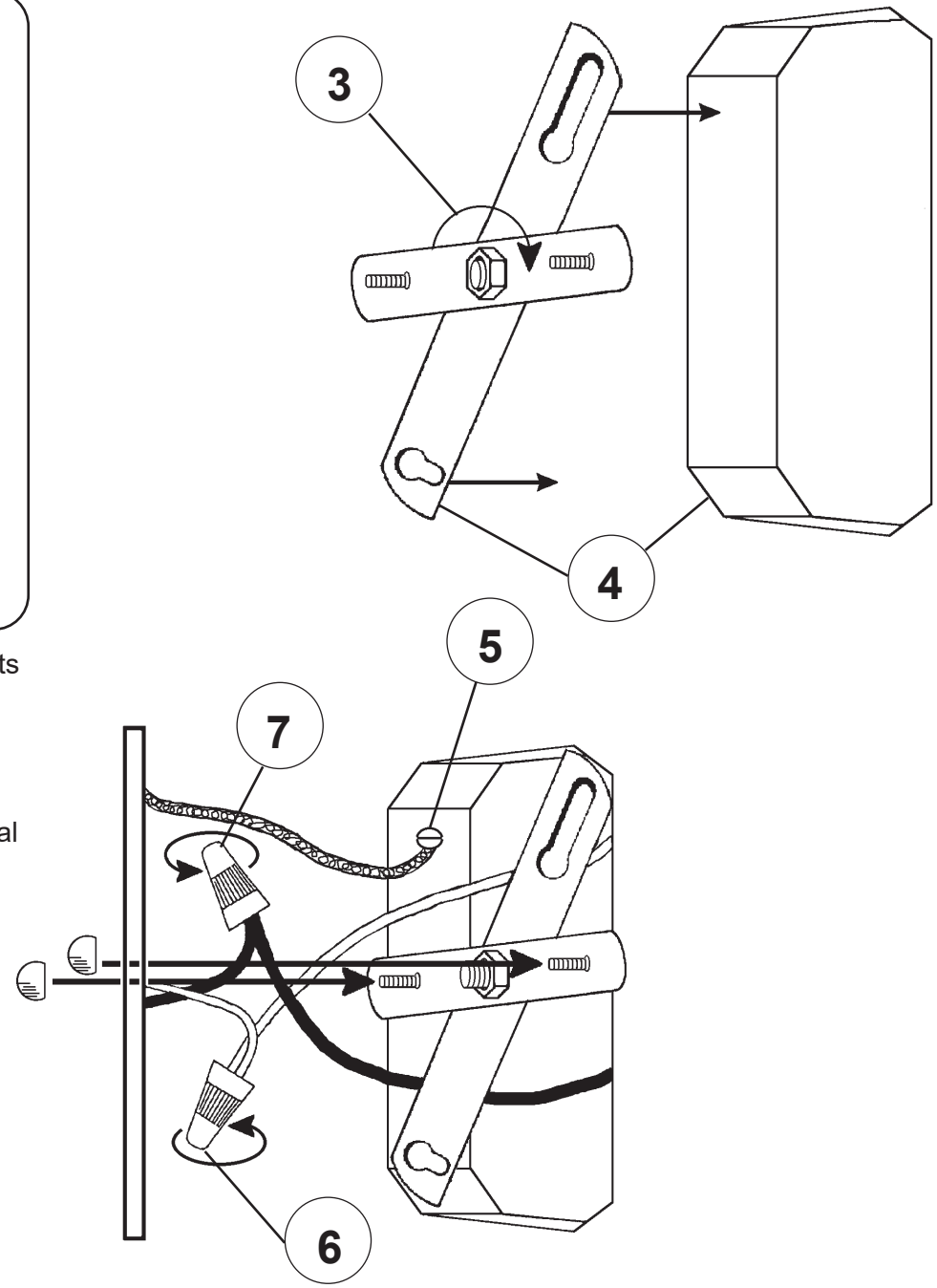

CHANDELIER 5070-____R TRIM DIAGRAM
(Finish Option)

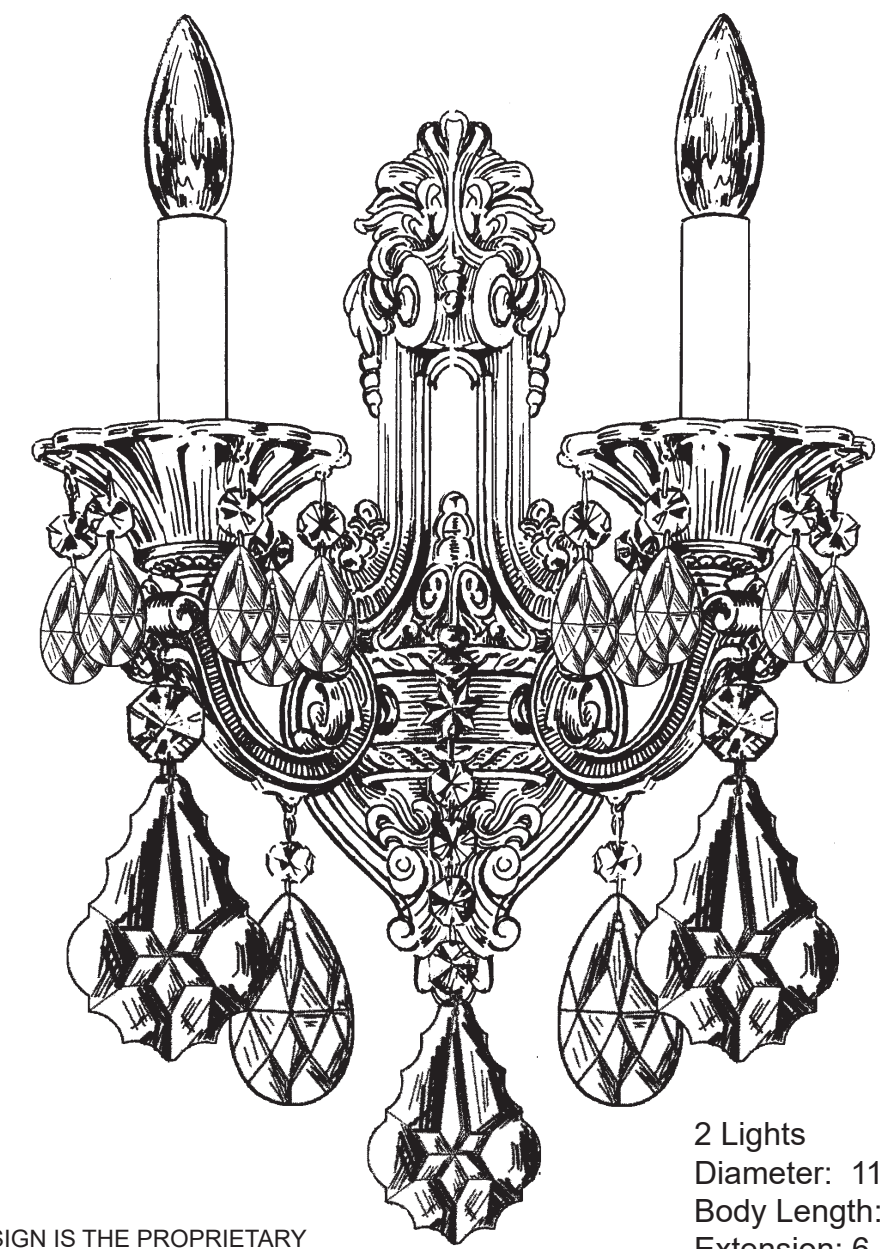

2 Lights
Diameter: 11-1/2"
Body Length: 16-1/2"
Extension: 6-1/2"
Hanging Weight: 5 lbs.

THIS DESIGN IS THE PROPRIETARY TRADE DRESS/TRADEMARK OF W SCHONBEK LLC.



**See diagram on back page
Follow steps in exact order
Save this trim diagram for future reference**

1 **IMPORTANT**
Person who opens carton should record the following information for future service.

CODE # _____ Four-digit number on outside of carton.
PACKER # _____ See crystal package label.
ORDER # _____ See crystal package label.



Instructions for crystal trimming
STEPS 10 - 14

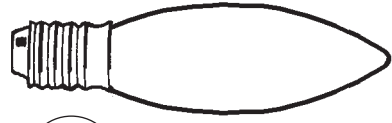

10

You will need 2 - B10
25 Watts Recommended
60 Watts Max

Install bulbs and be sure
to test fixture **BEFORE**
trimming.

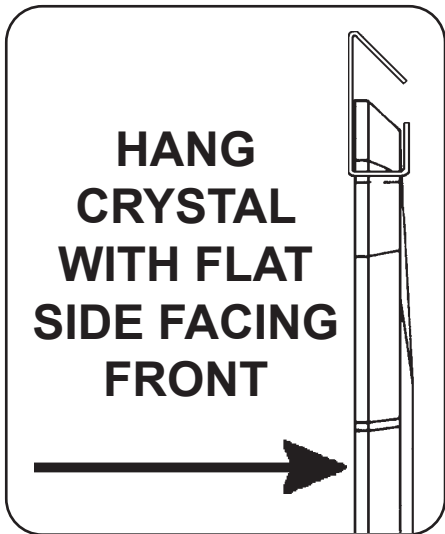
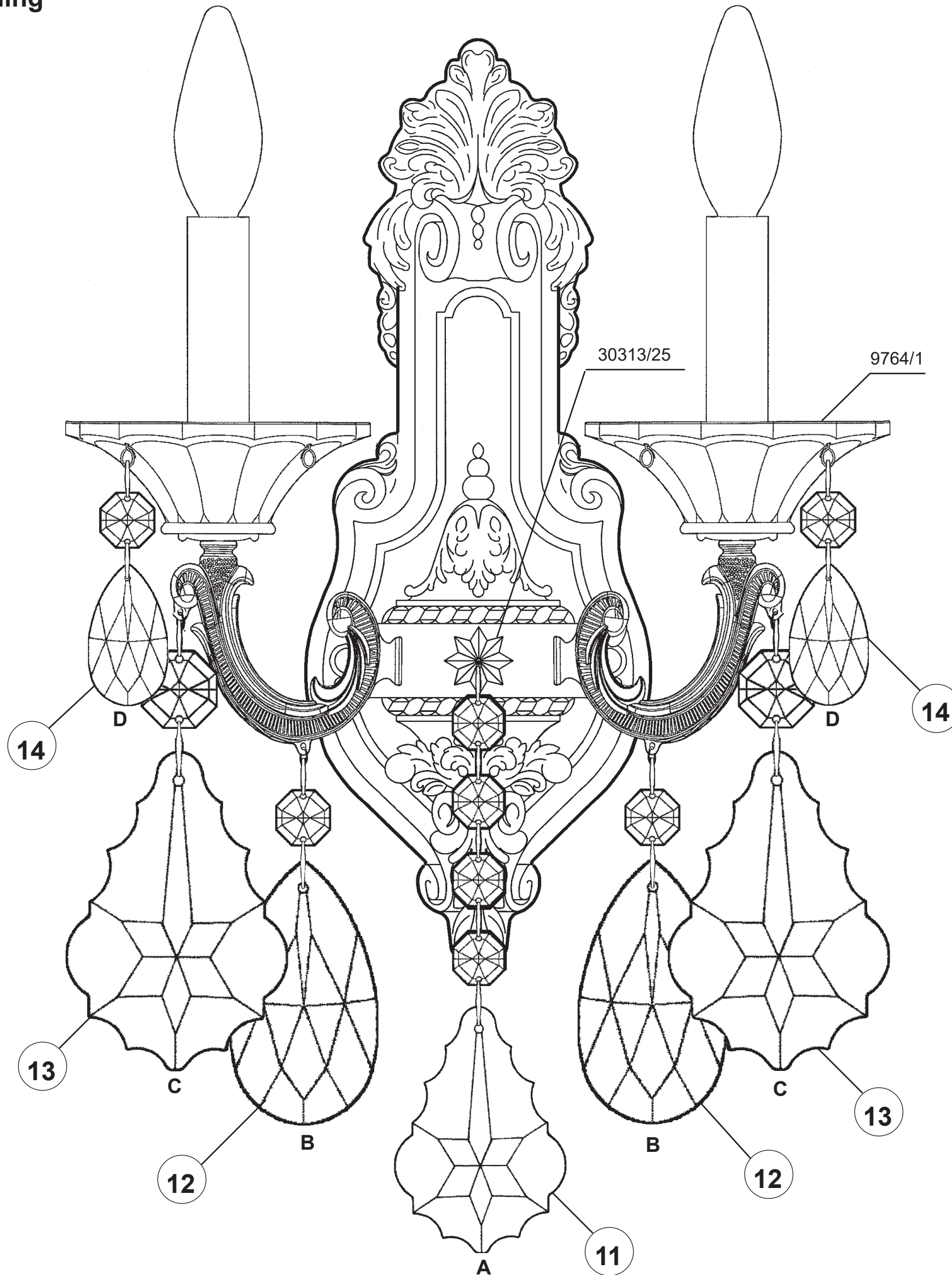

**Instructions for electrician
STEPS 2 - 9**

WARNING:

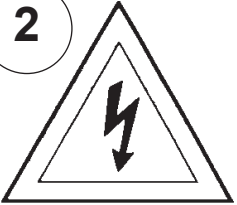
2 
Electrical Danger

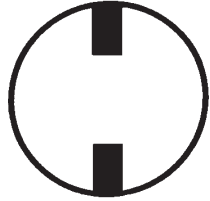
Turn Power Off

All electrical components must be installed by a licensed electrician in accordance with the National Electric Code and the appropriate local electrical codes.

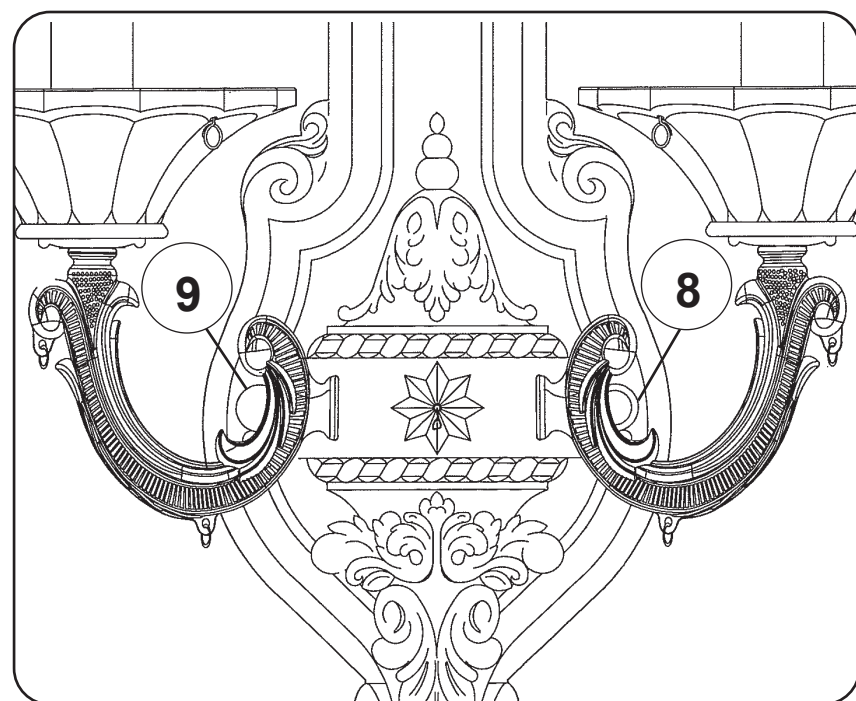
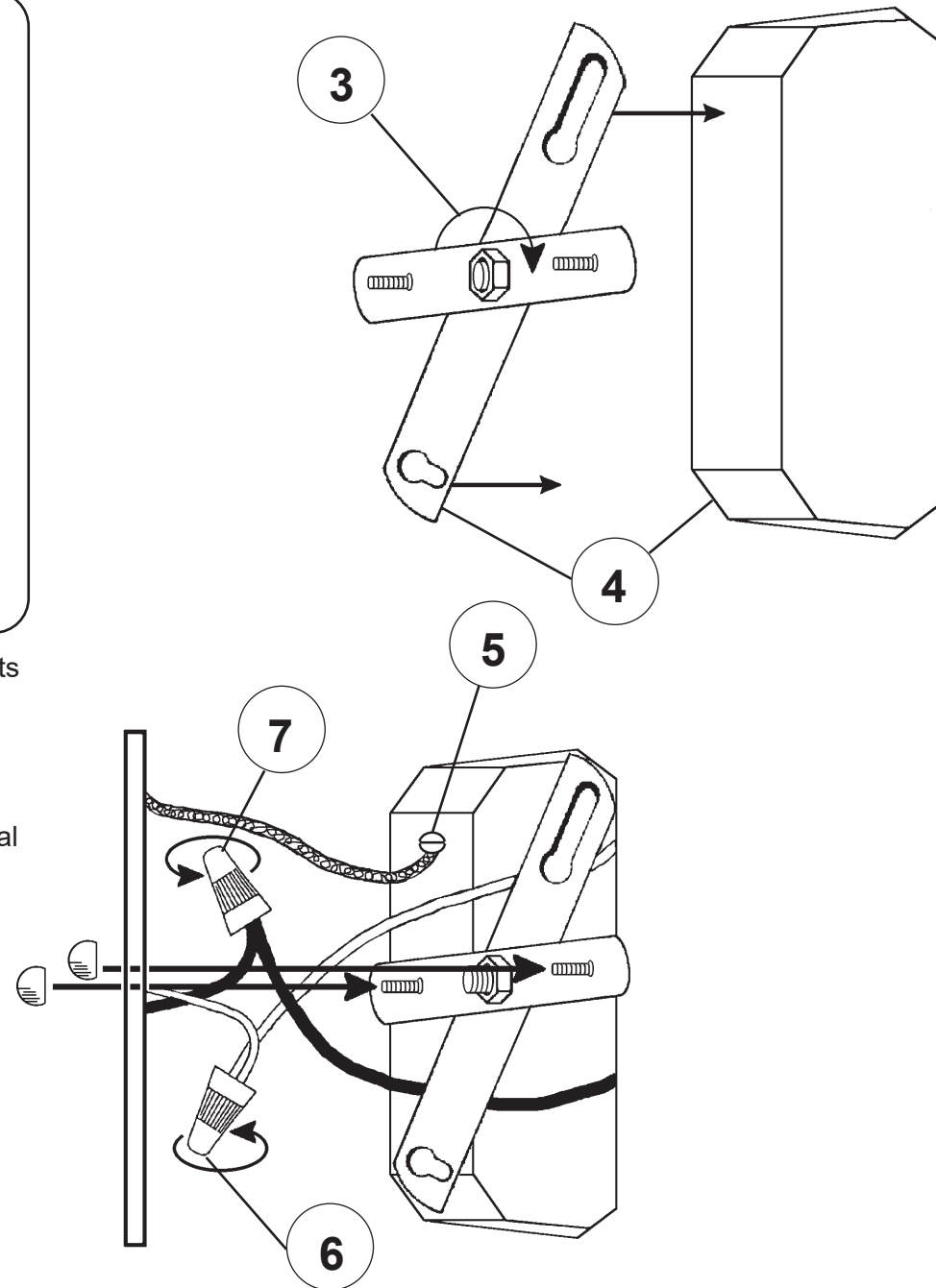

CHANDELIER 5070- _____ TRIM DIAGRAM
(Finish Option) (Trim Option)

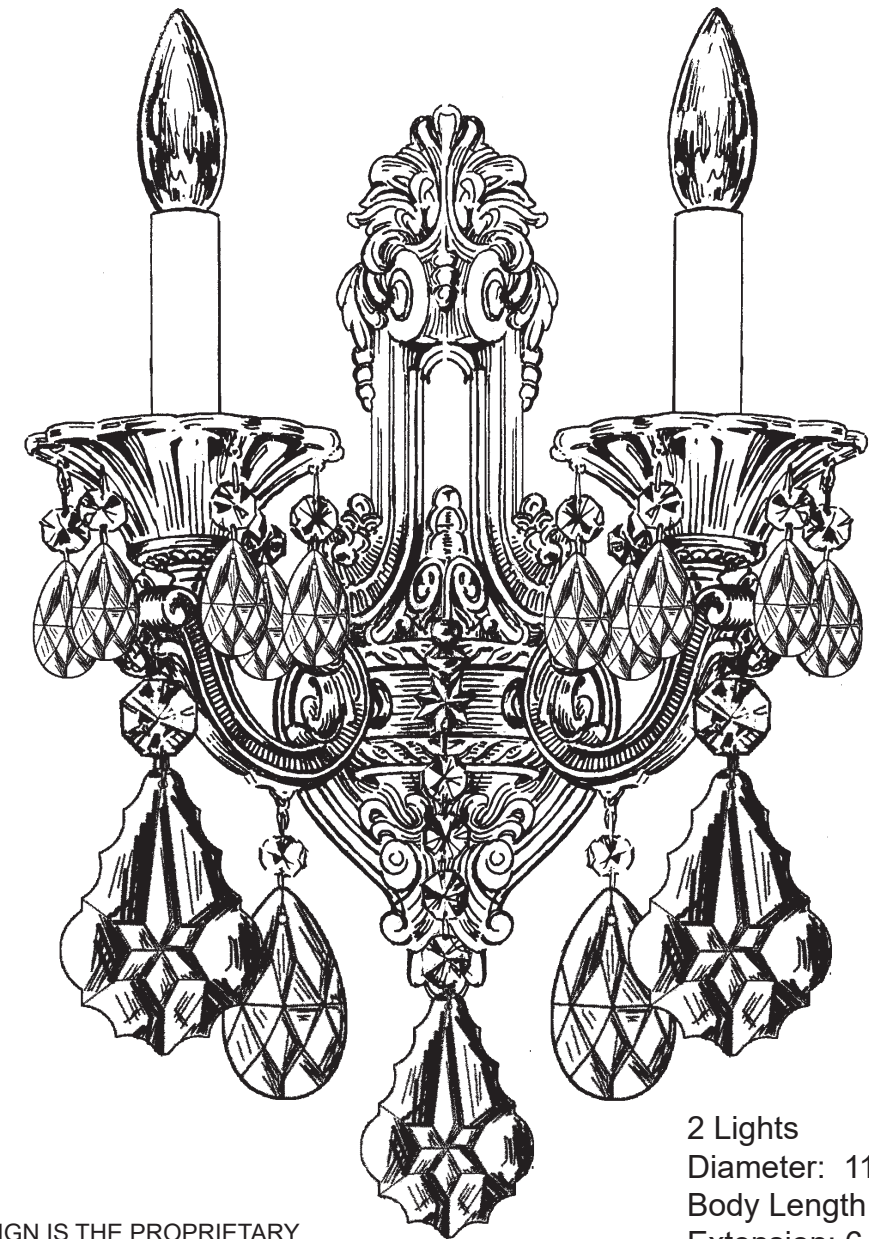

2 Lights
Diameter: 11-1/2"
Body Length: 16-1/2"
Extension: 6-1/2"
Hanging Weight: 5 lbs.

THIS DESIGN IS THE PROPRIETARY TRADE DRESS/TRADEMARK OF W SCHONBEK LLC.



SCHONBEK | 1870

**See diagram on back page
Follow steps in exact order
Save this trim diagram for future reference**

IMPORTANT
1 *Person who opens carton should record the following information for future service.*

CODE # _____	Four-digit number on outside of carton.
PACKER # _____	See crystal package label.
ORDER # _____	See crystal package label.



Instructions for crystal trimming
STEPS 10 - 14

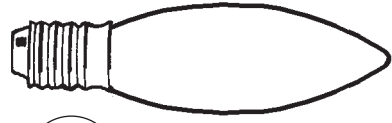

10

You will need 2 - B10
25 Watts Recommended
60 Watts Max

Install bulbs and be sure
to test fixture **BEFORE**
trimming.

