

CHANDELIER 9843-____R TRIM DIAGRAM

(Finish Option)

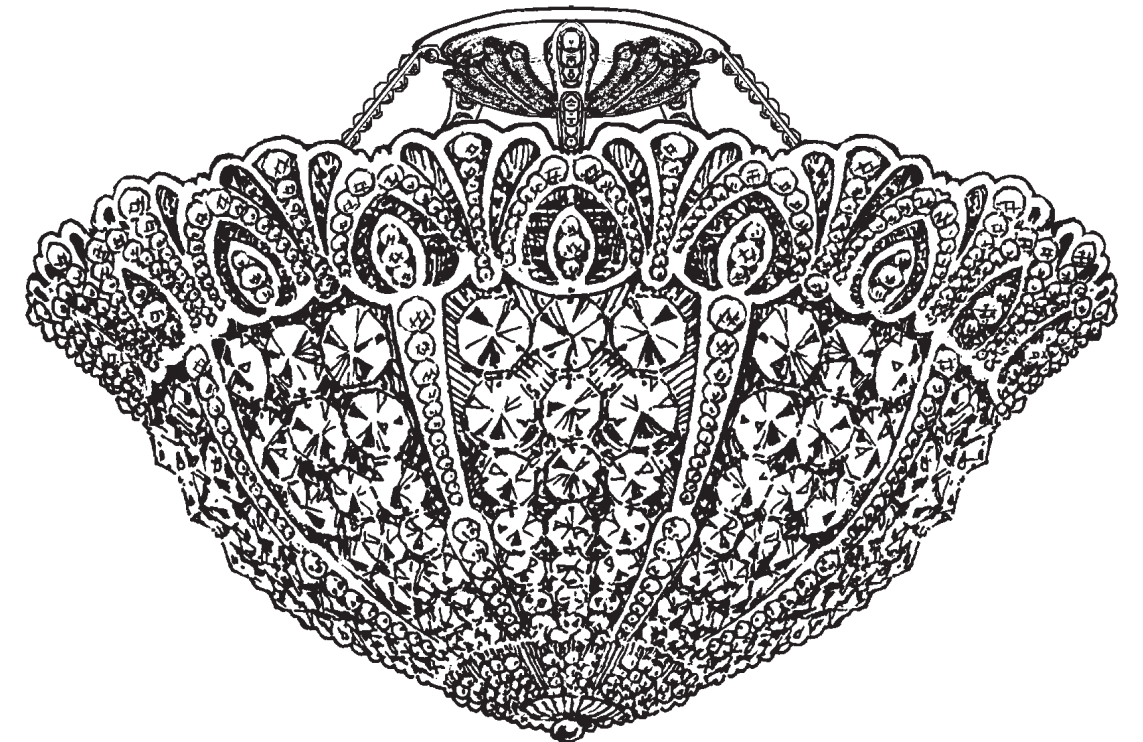

9 Lights
 Diameter: 20"
 Body Length: 13-1/2"
 Hanging Weight: 9 lbs.

THIS DESIGN IS THE PROPRIETARY TRADE DRESS/TRADEMARK OF W SCHONBEK LLC.



**See diagram on back page
 Follow steps in exact order
 Save this trim diagram for future reference**

IMPORTANT
1 Person who opens carton should record the following information for future service.
 CODE # _____ Four-digit number on outside of carton.
 PACKER # _____ See crystal package label.
 ORDER # _____ See crystal package label.

Instructions for electrician STEPS 2 - 11

WARNING:

2 **Electrical Danger Turn Power Off**

All electrical components must be installed by a licensed electrician in accordance with the National Electric Code and the appropriate local electrical codes.

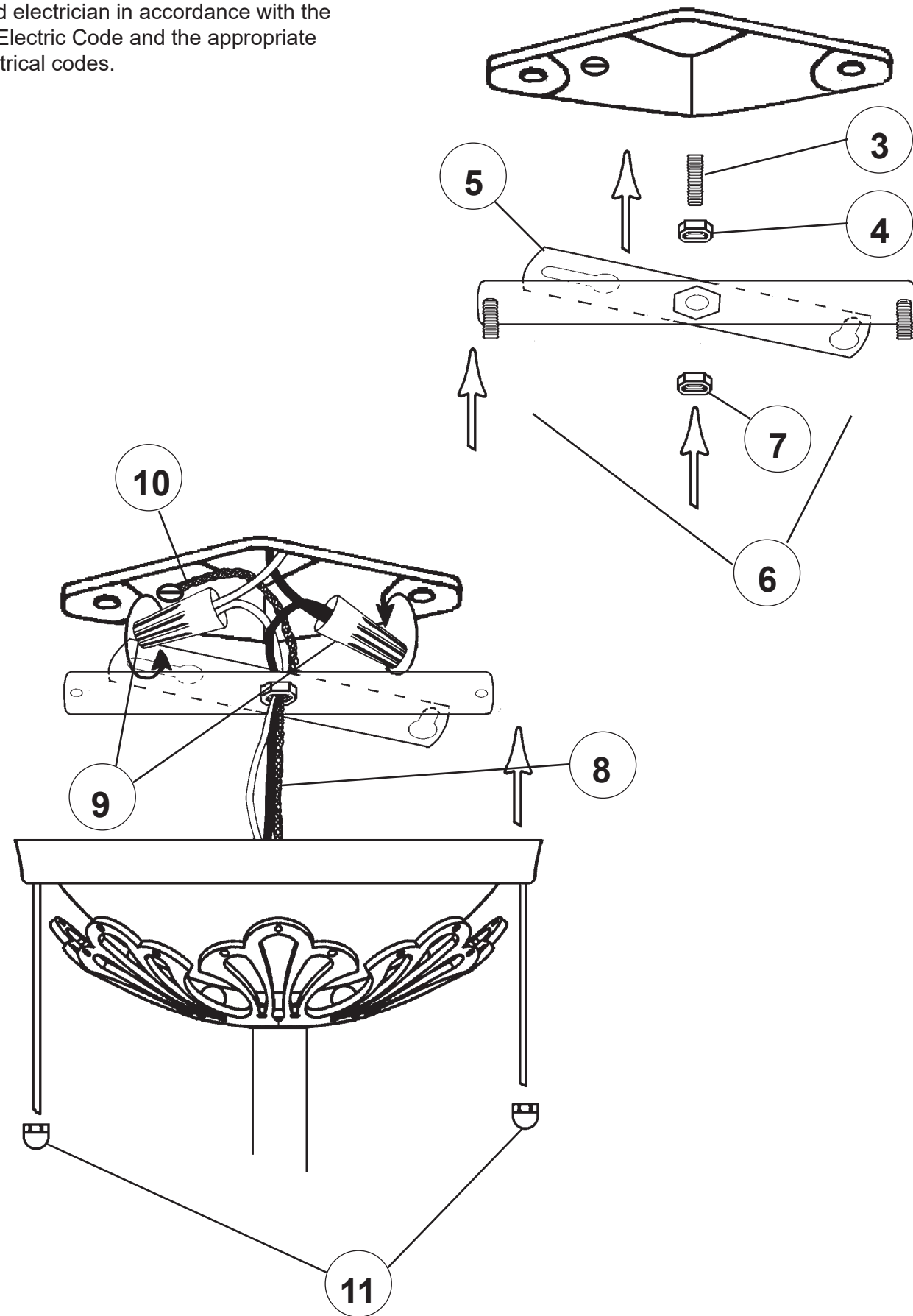

Instructions for crystal trimming

STEPS 12 - 13

12

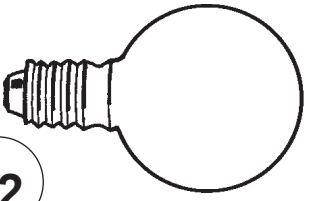

You will need 3 - G16-1/2
25 Watts Recommended
60 Watts Max



You will need 6 - B10
25 Watts Recommended
60 Watts Max

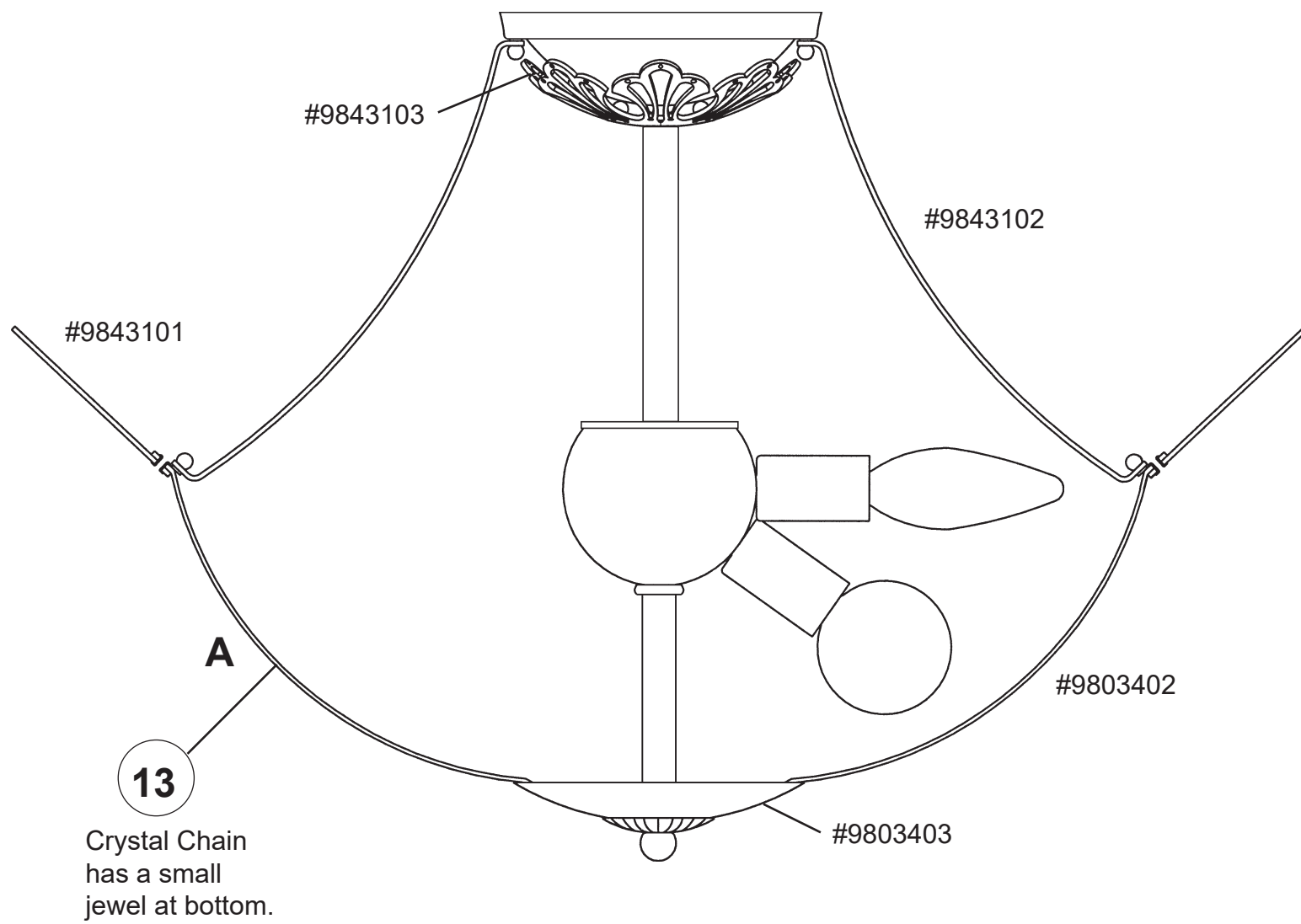

PART NUMBERS FOR SPARE PARTS

