

BARONET BN1016N-__ __O

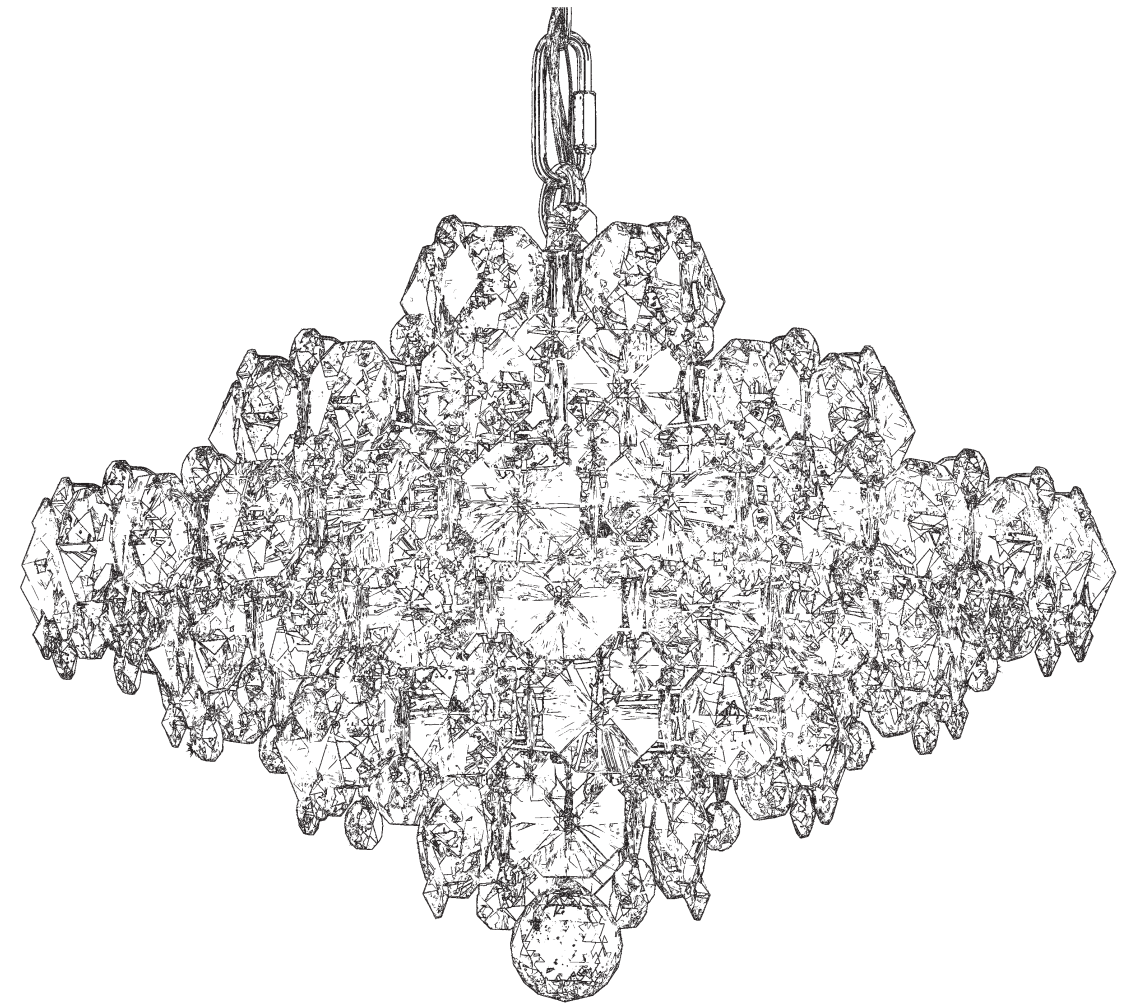











8 Lights
Diameter: 19"
Height: 15"
Hanging Weight: 22lbs.

THIS DESIGN IS THE PROPRIETARY
TRADE DRESS/TRADEMARK OF
W SCHONBEK LLC.

 **SCHONBEK** | 1870

 **SCHONBEK** | 1870

								
MAX 60 W	110-120 V							

WARNING:

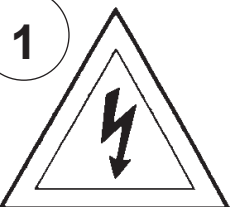
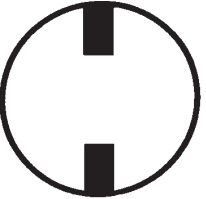
1  

Electrical Danger Turn Power Off

All electrical components must be installed by a licensed electrician in accordance with the National Electric Code and the appropriate local electrical codes.

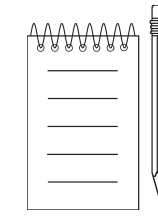
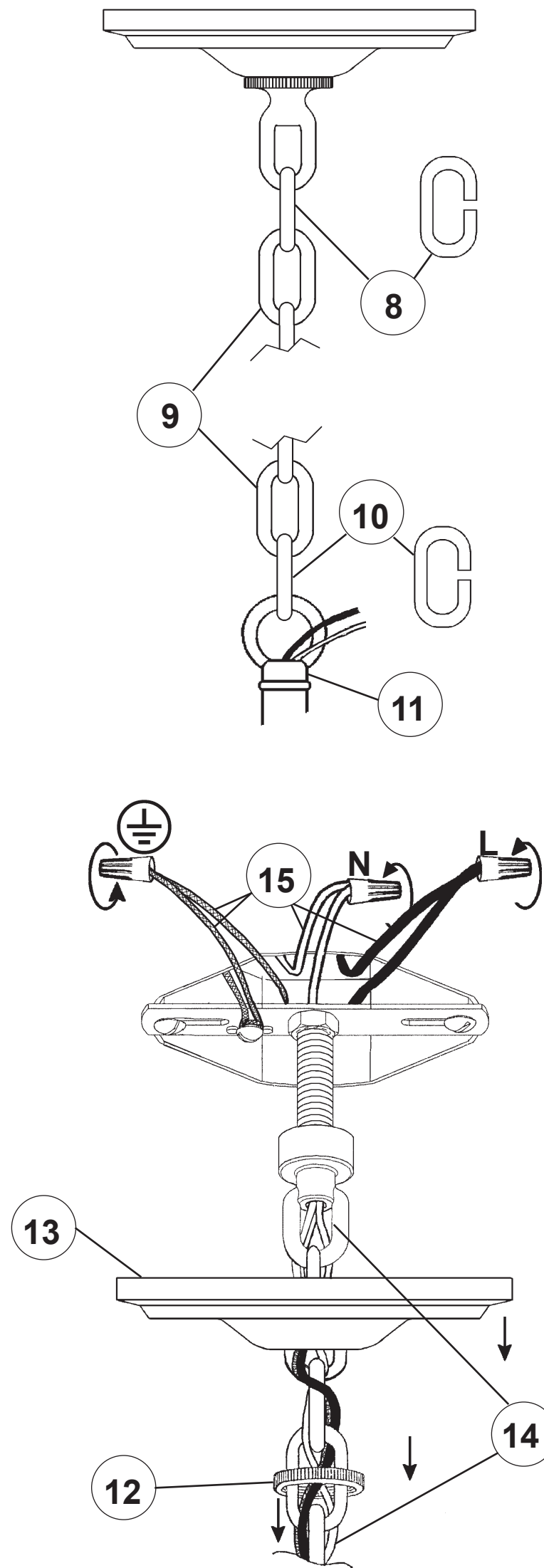
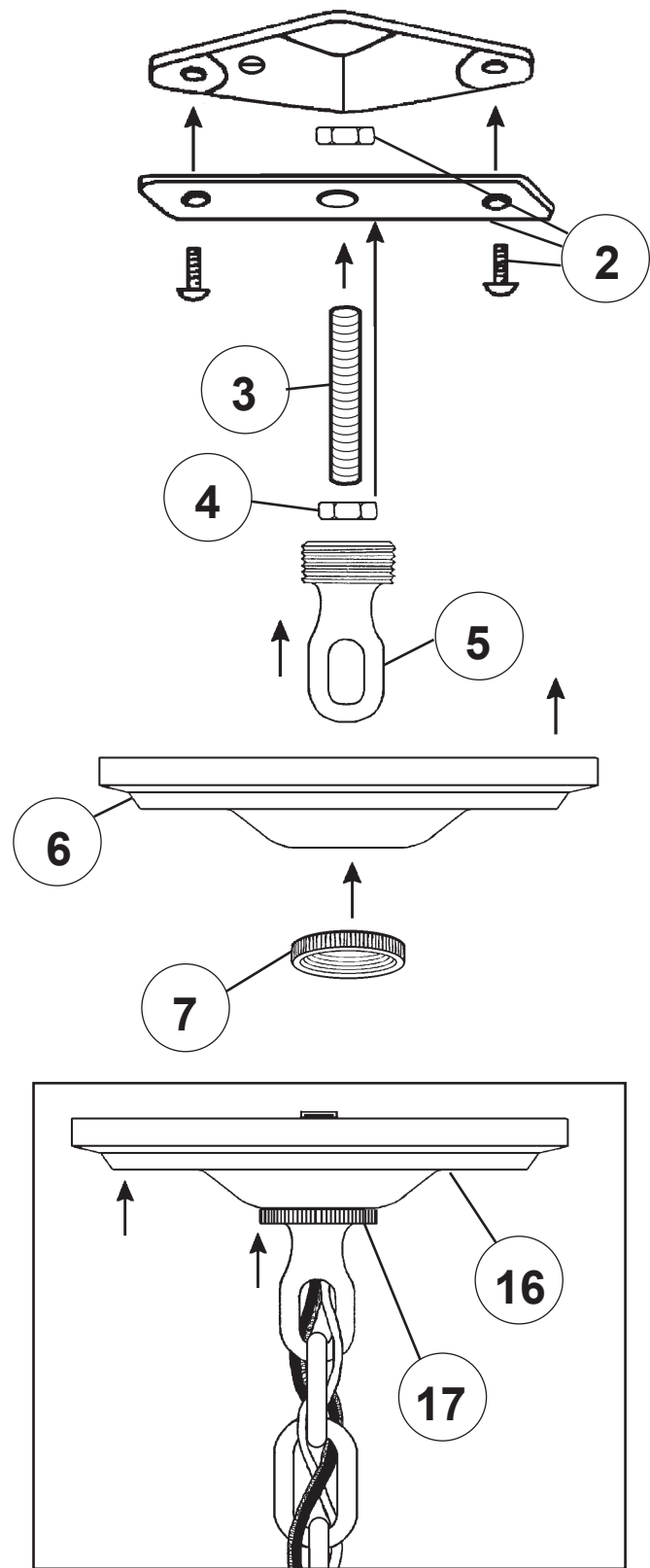

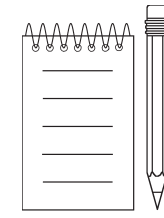
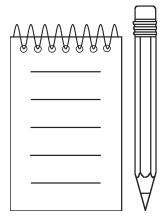

18

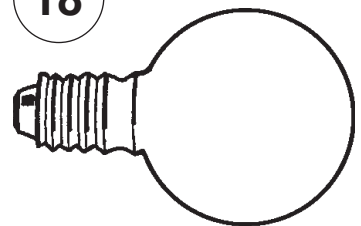

You will need 8 - G16-1/2
60 Watts Max

Install bulbs and be sure
to test fixture BEFORE
trimming.

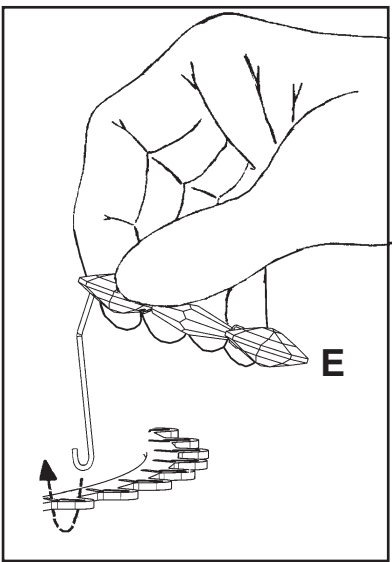

19

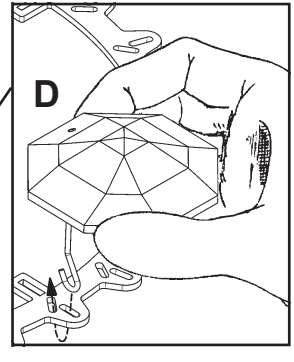

20

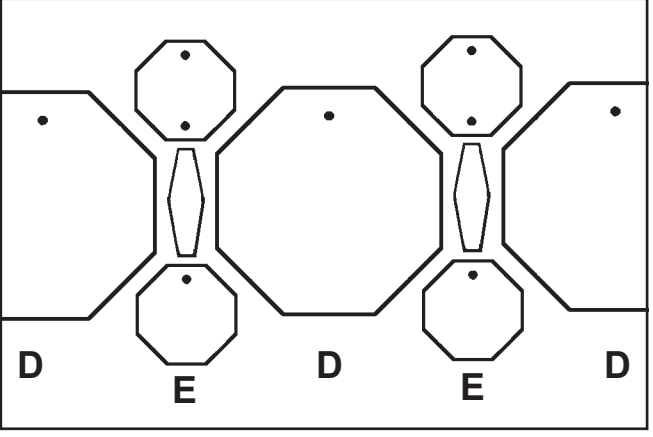

31

21

22

32

30

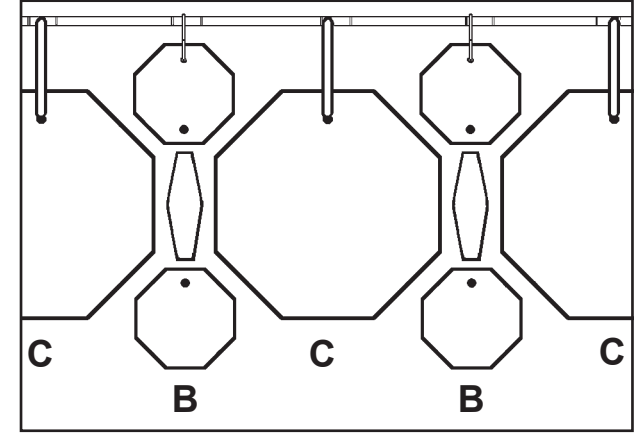

28

29

26

27

24

25

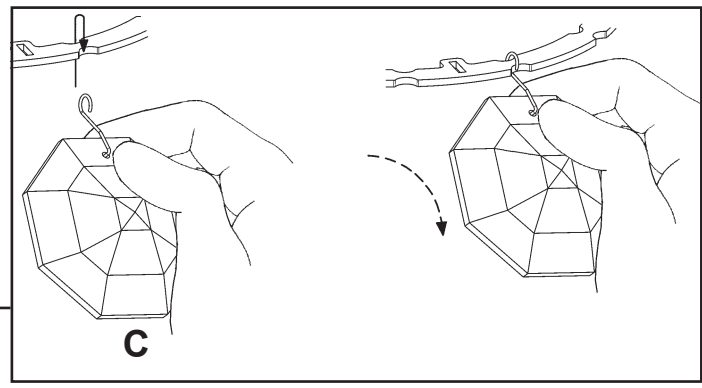
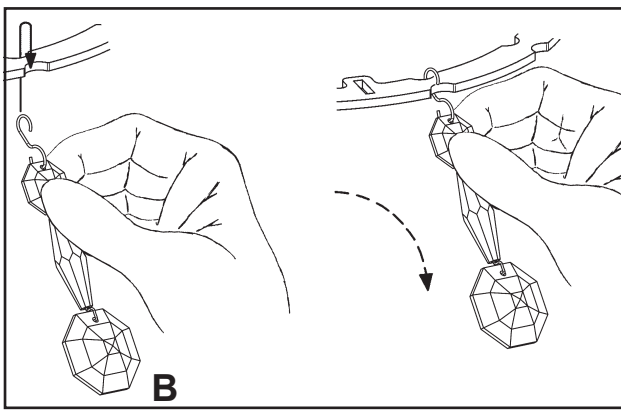

23

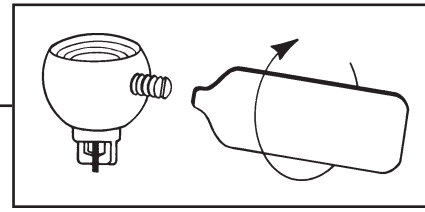

BARONET BN1016N- __ __ R













8 Lights
Diameter: 19"
Height: 15"
Hanging Weight: 22lbs.

THIS DESIGN IS THE PROPRIETARY
TRADE DRESS/TRADEMARK OF
W SCHONBEK LLC.

 **SCHONBEK** | 1870

 **SCHONBEK** | 1870

								
MAX 60 W	110-120 V							

WARNING:

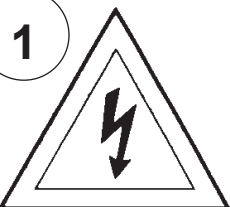
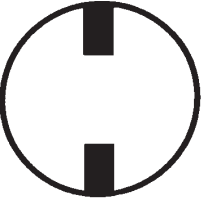
1  

Electrical Danger Turn Power Off

All electrical components must be installed by a licensed electrician in accordance with the National Electric Code and the appropriate local electrical codes.

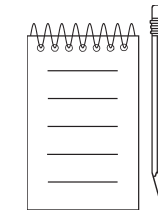
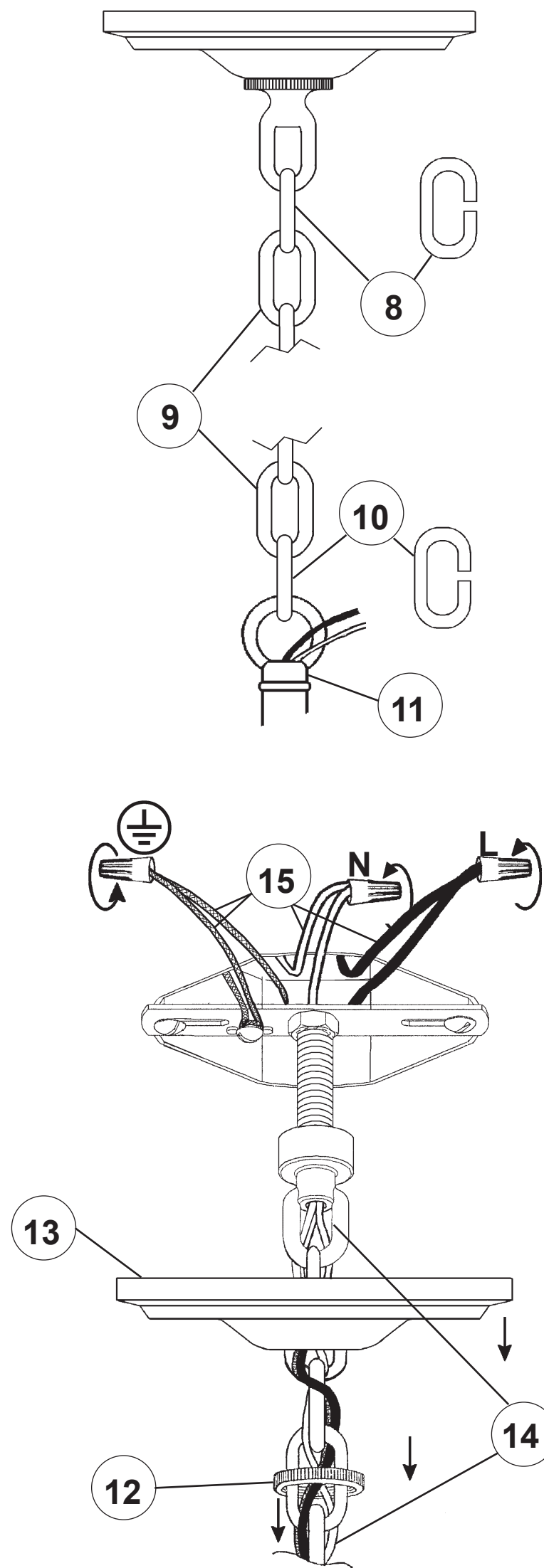
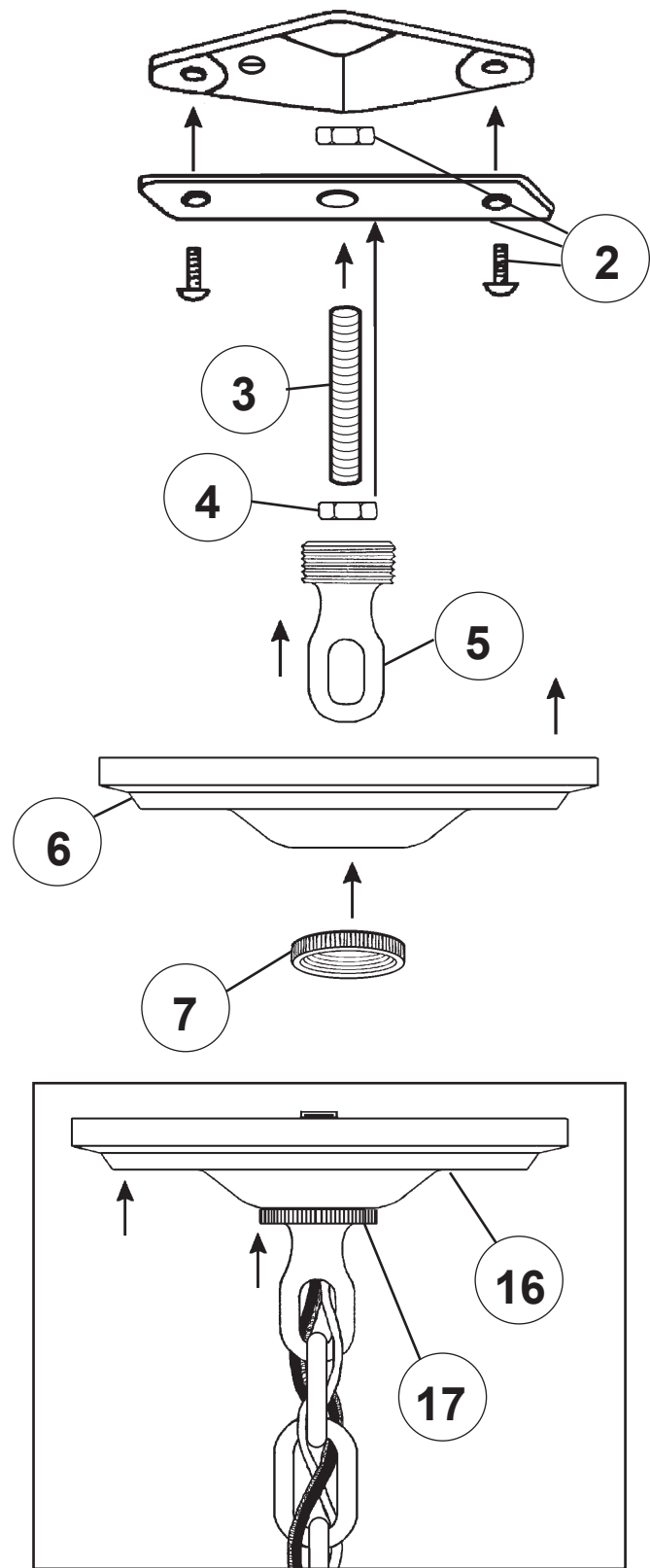

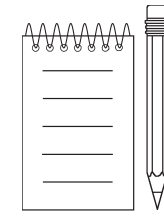
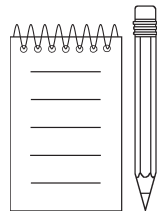

18

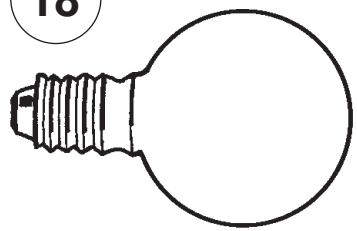

You will need 8 - G16-1/2
60 Watts Max

Install bulbs and be sure
to test fixture **BEFORE**
trimming.

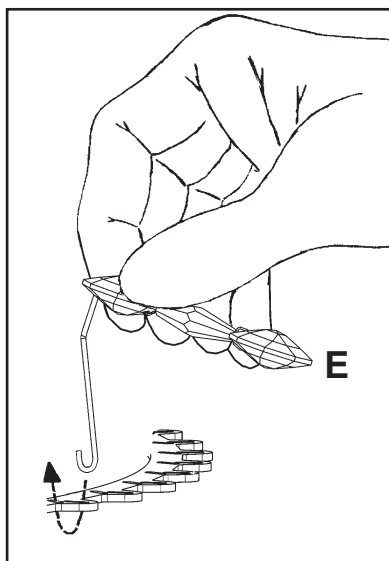

19

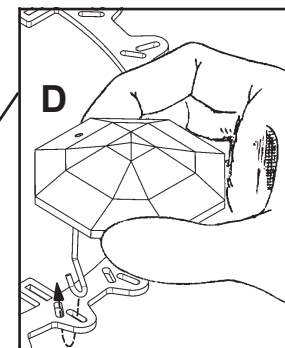
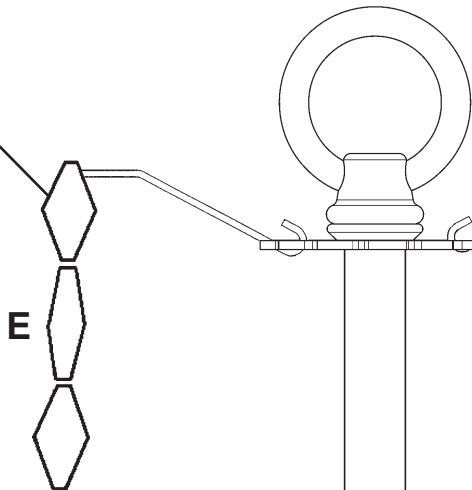

20

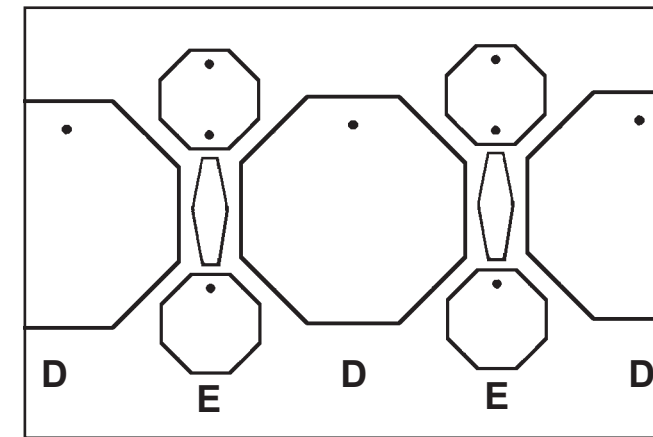

31

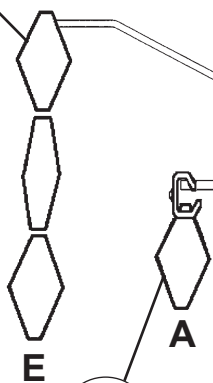

22

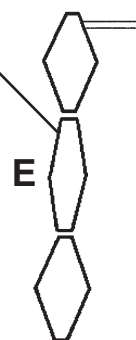

21

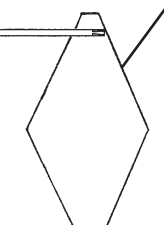

32

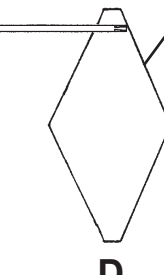

30



28



29

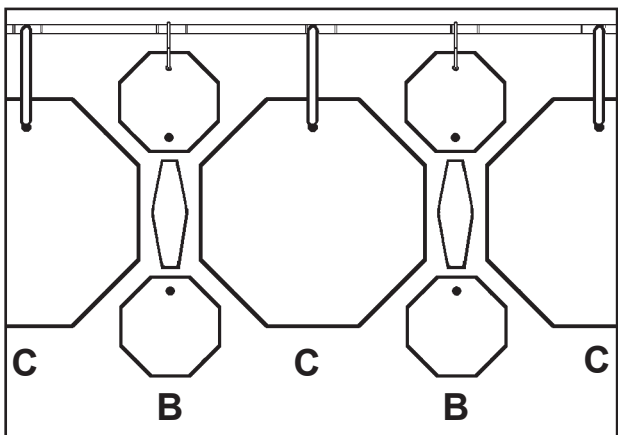
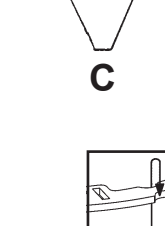

26



27

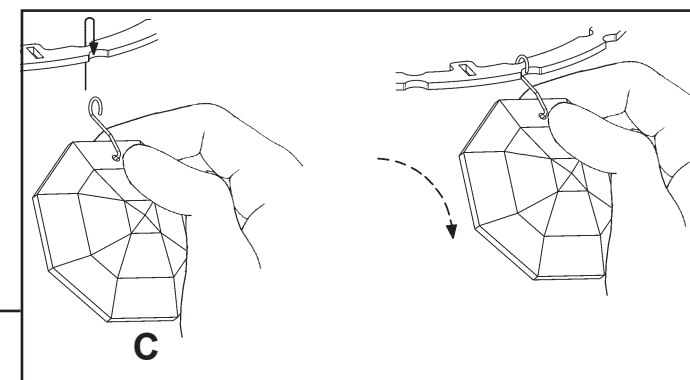
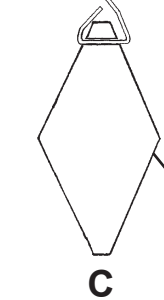

24

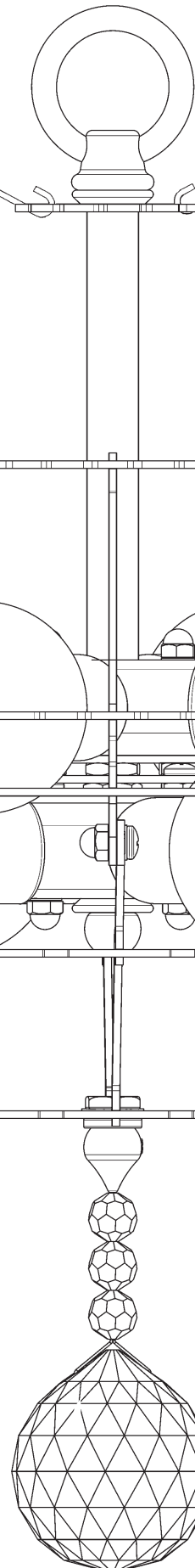
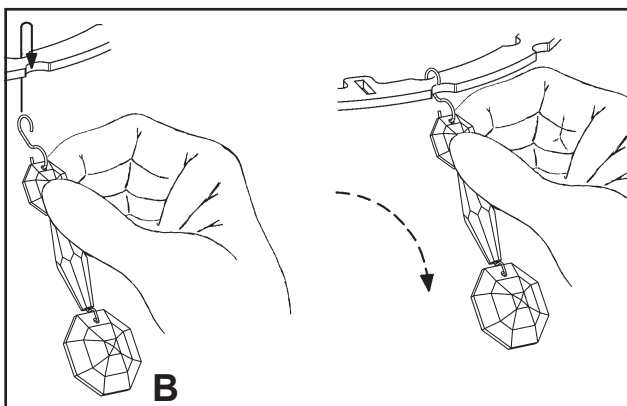

23

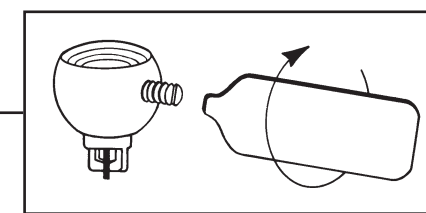

NR20119-**



BARONET BN1016N- __ __ S













8 Lights
Diameter: 19"
Height: 15"
Hanging Weight: 22lbs.

THIS DESIGN IS THE PROPRIETARY
TRADE DRESS/TRADEMARK OF
W SCHONBEK LLC.

 **SCHONBEK** | 1870

 **SCHONBEK** | 1870

								
MAX <u>60</u> W	110-120 V							

WARNING:

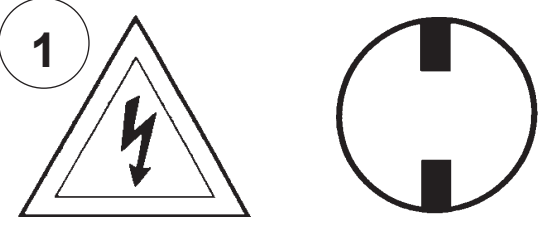
1 

Electrical Danger Turn Power Off

All electrical components must be installed by a licensed electrician in accordance with the National Electric Code and the appropriate local electrical codes.

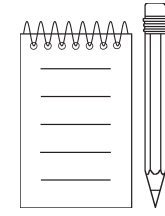
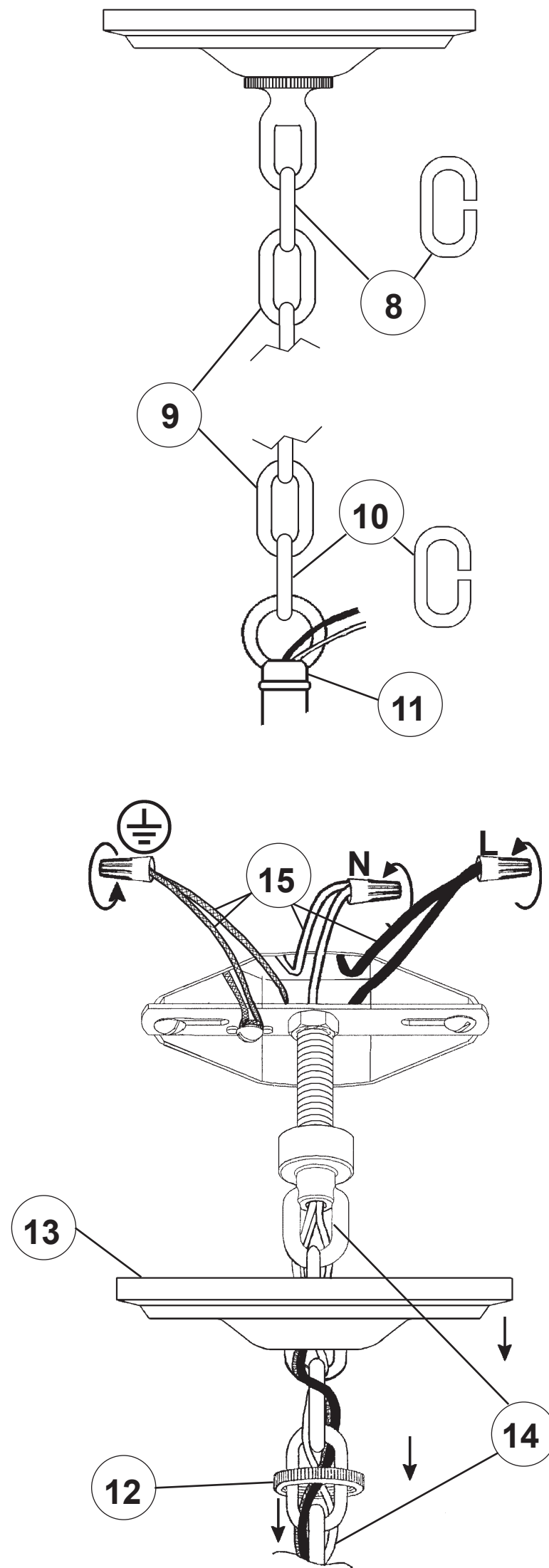
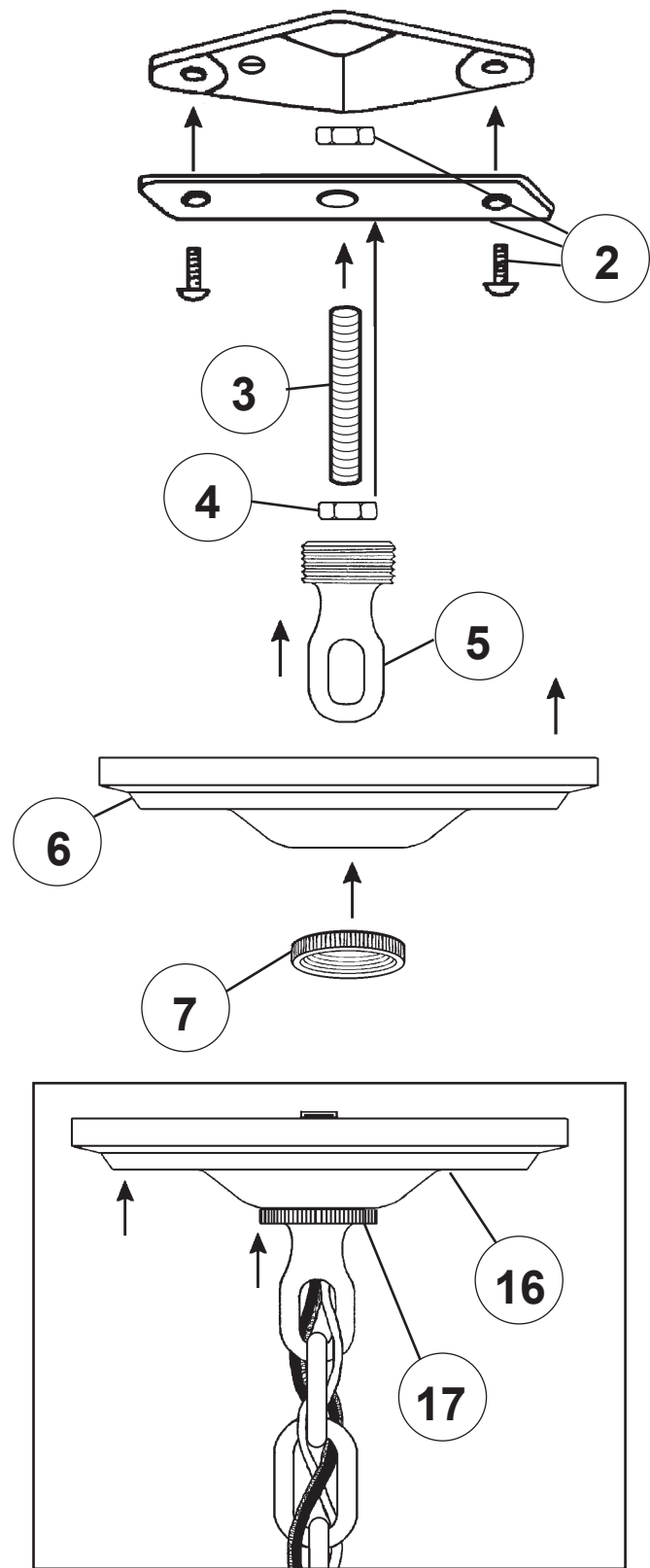

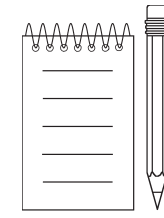
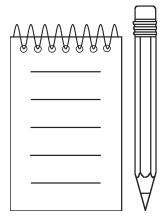

18

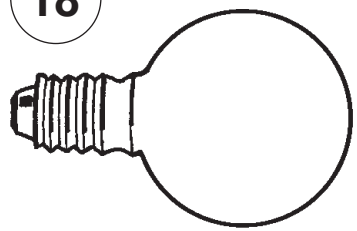

You will need 8 - G16-1/2
60 Watts Max

Install bulbs and be sure
to test fixture BEFORE
trimming.

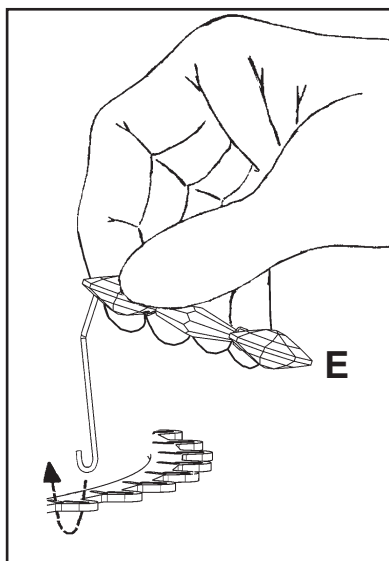

19

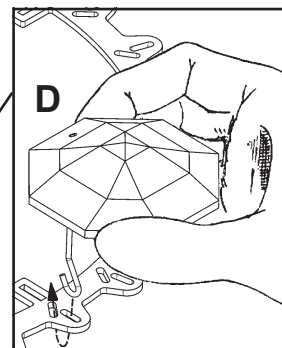
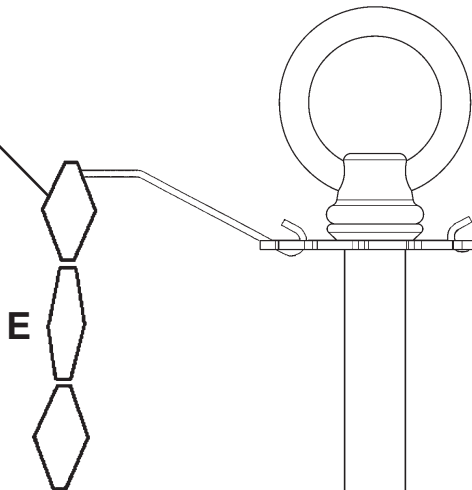

20

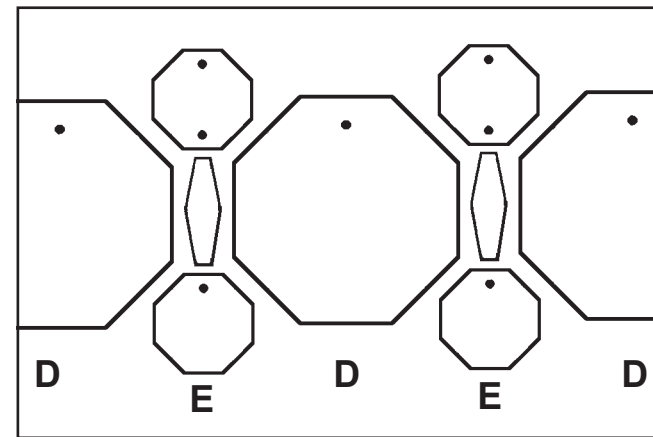

31

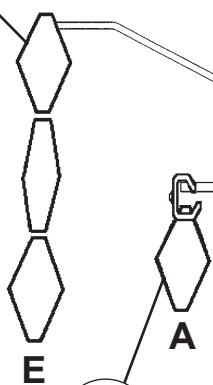

22

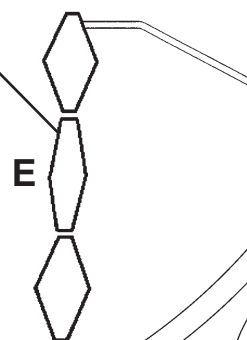

21



32

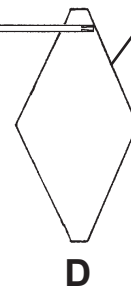

30



28



29

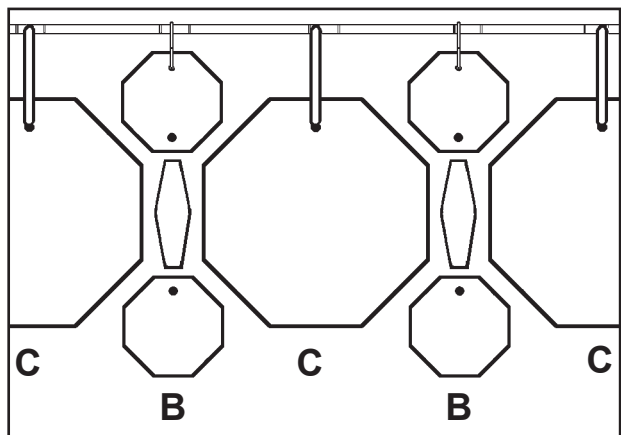
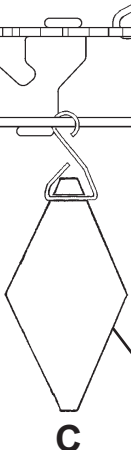

26



27

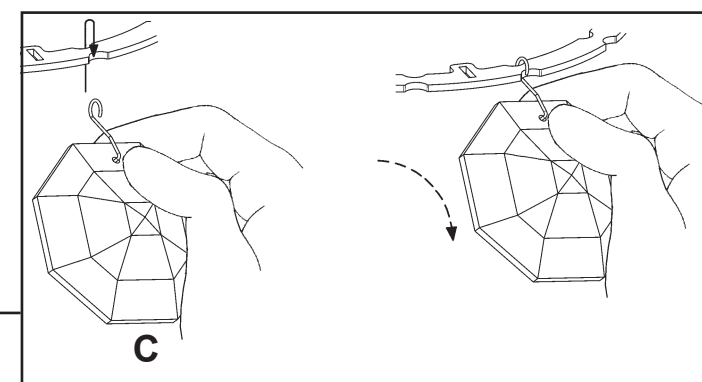
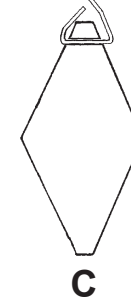

24

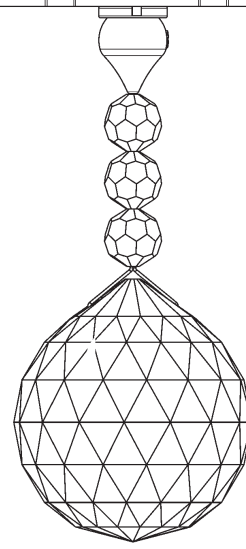

23

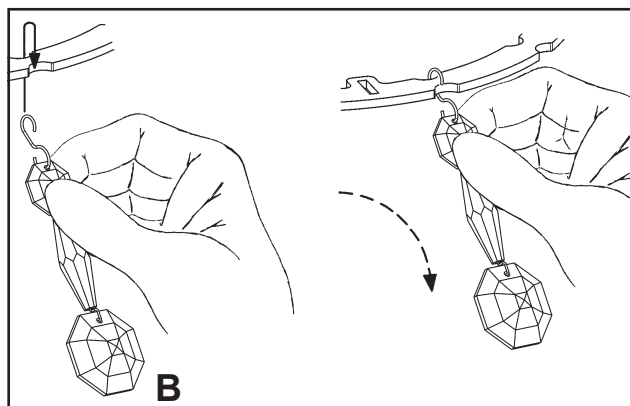
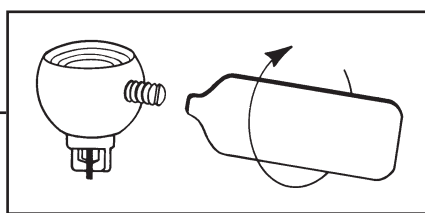

N20119-**

