

SONATINA ST1939N- __ __ H

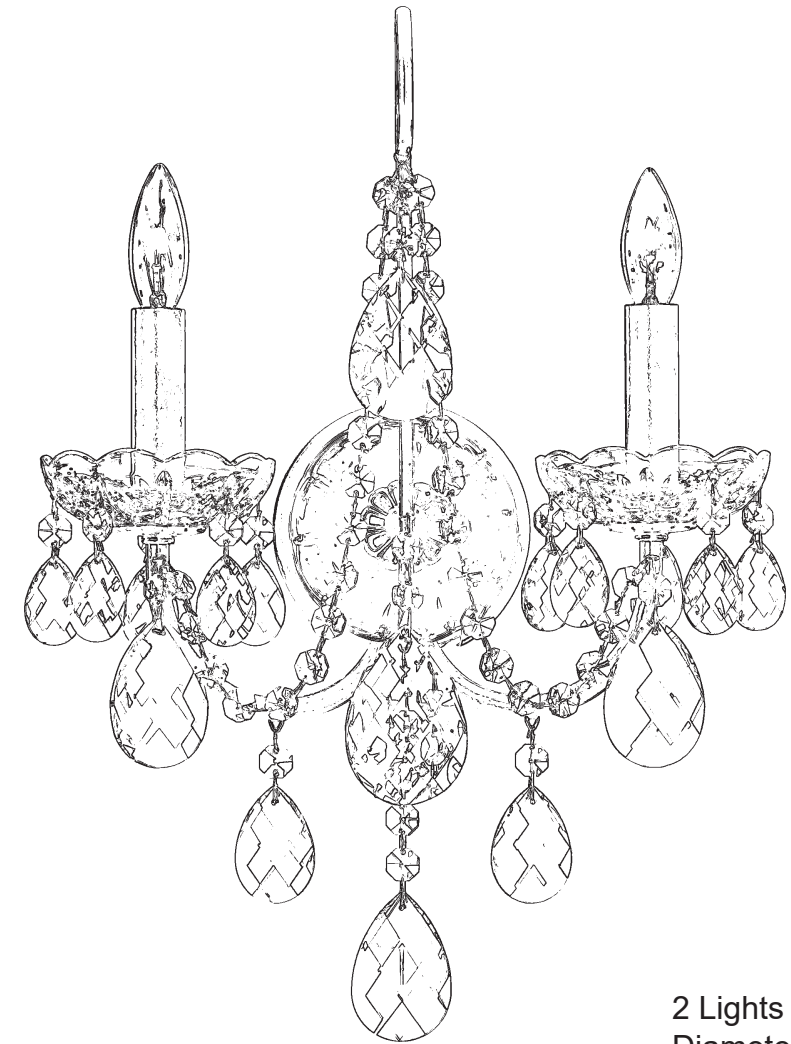











2 Lights
Diameter: 12-1/2"
Height: 17"
Extension: 5-1/2"
Hanging Weight: 3lbs.

THIS DESIGN IS THE PROPRIETARY
TRADE DRESS/TRADEMARK OF
W SCHONBEK LLC.

 **SCHONBEK** | 1870

 **SCHONBEK** | 1870

								
MAX <u>60</u> W	110-120 V							

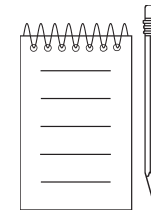
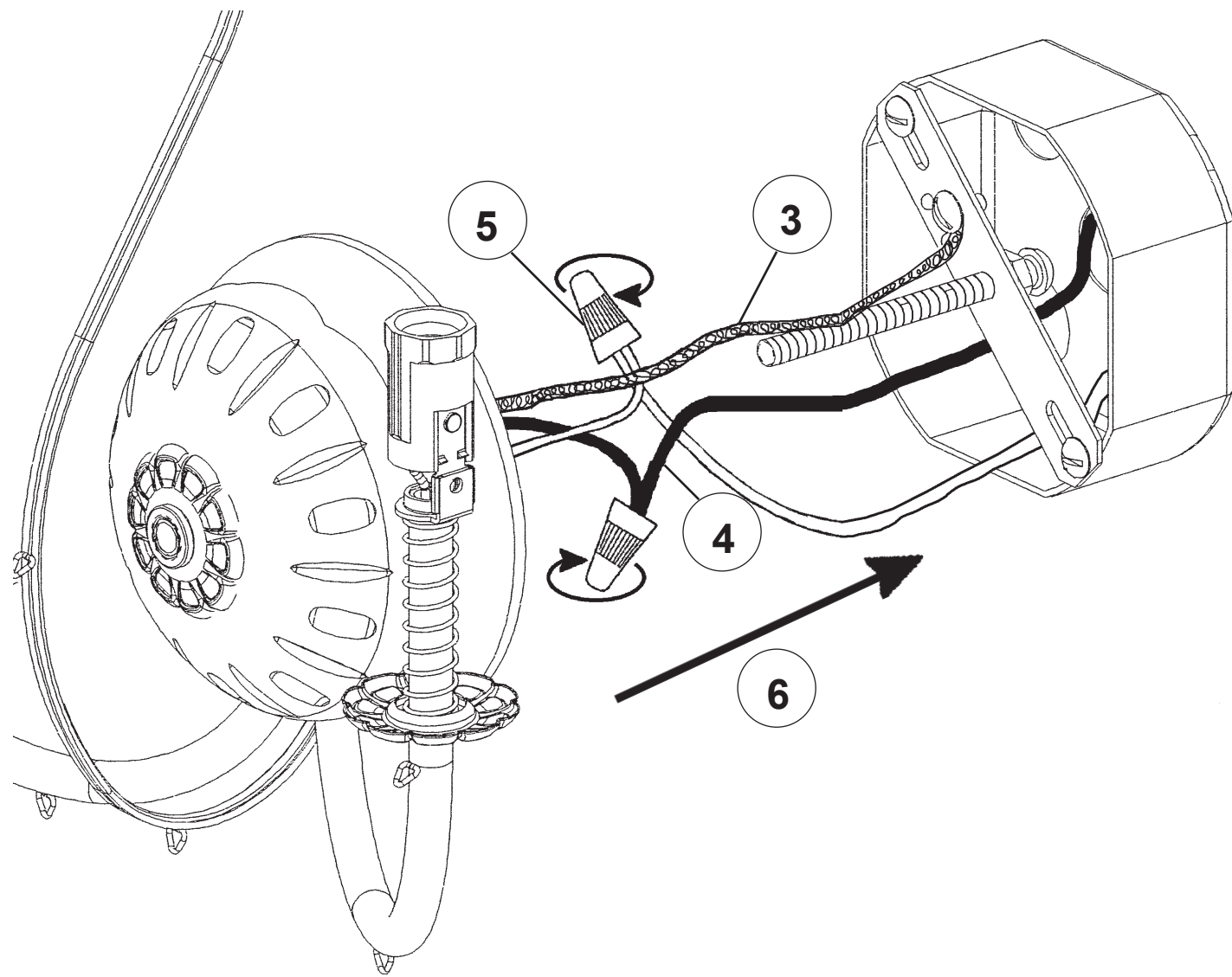
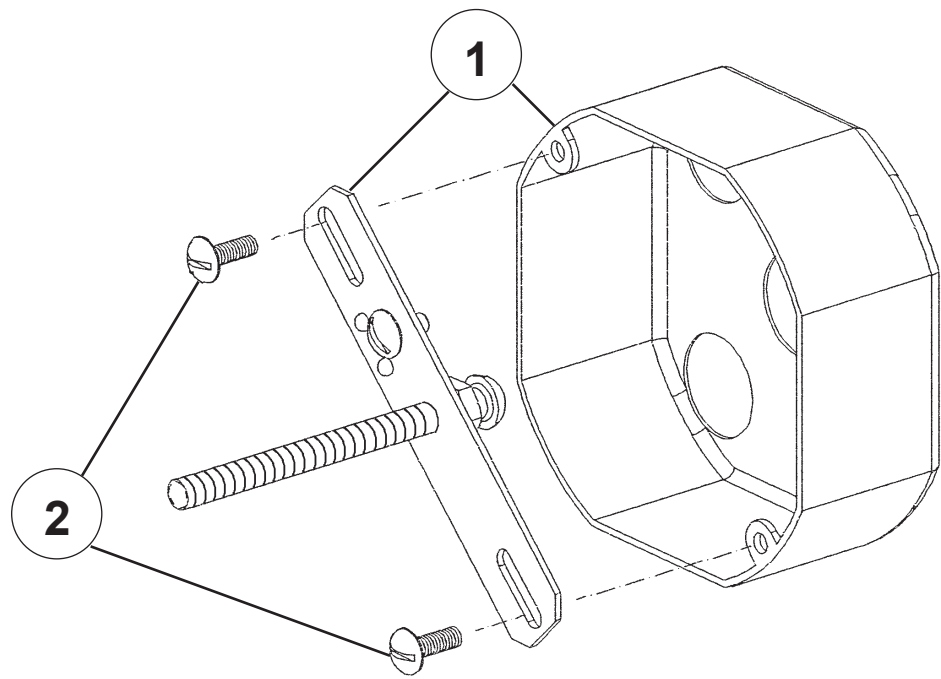

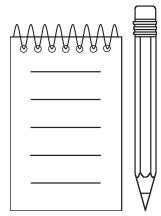

You will need 2 - B10
25 Watts Recommended
60 Watts Max

**Install bulbs and be sure
to test fixture BEFORE
trimming.**

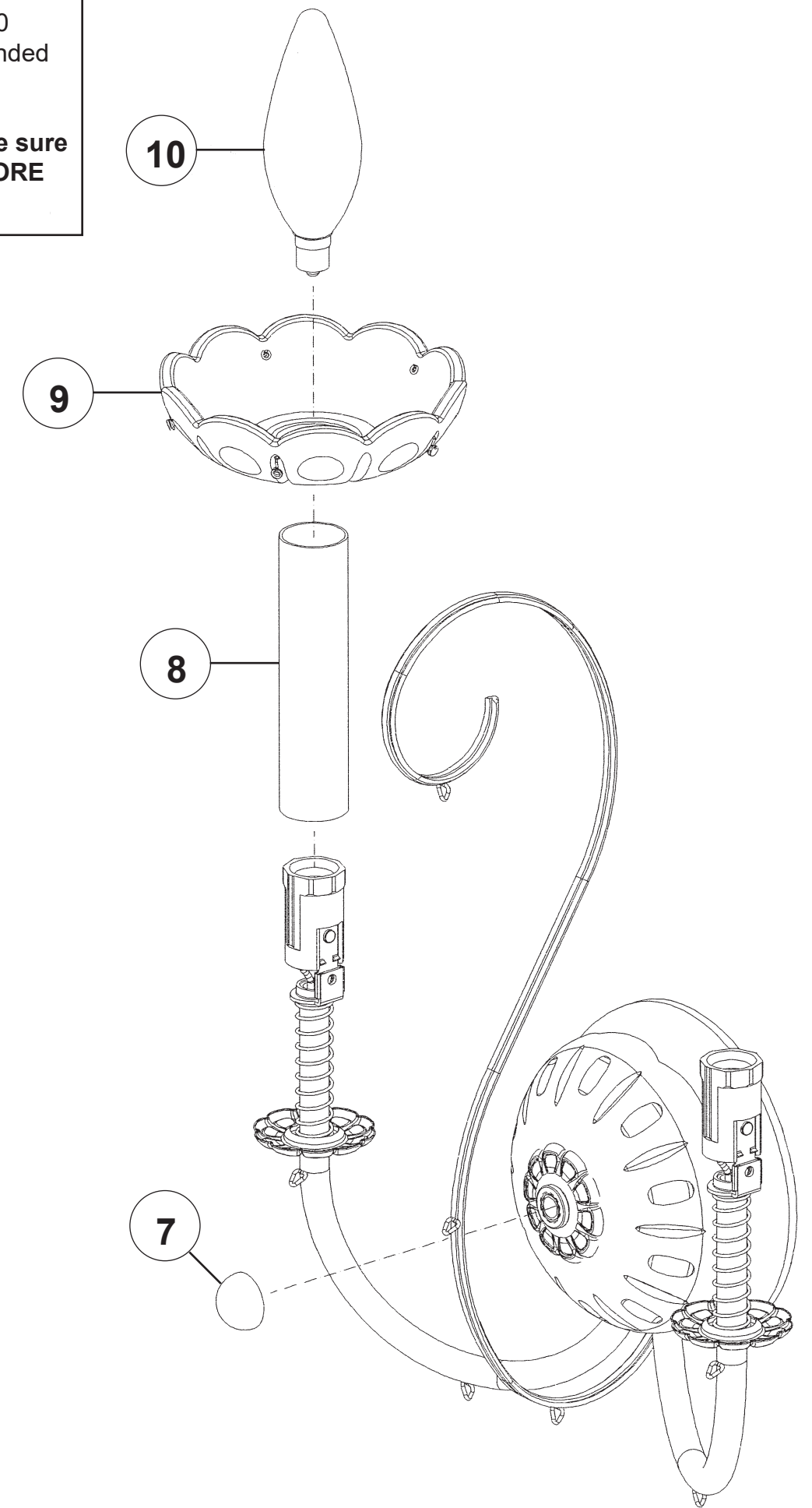

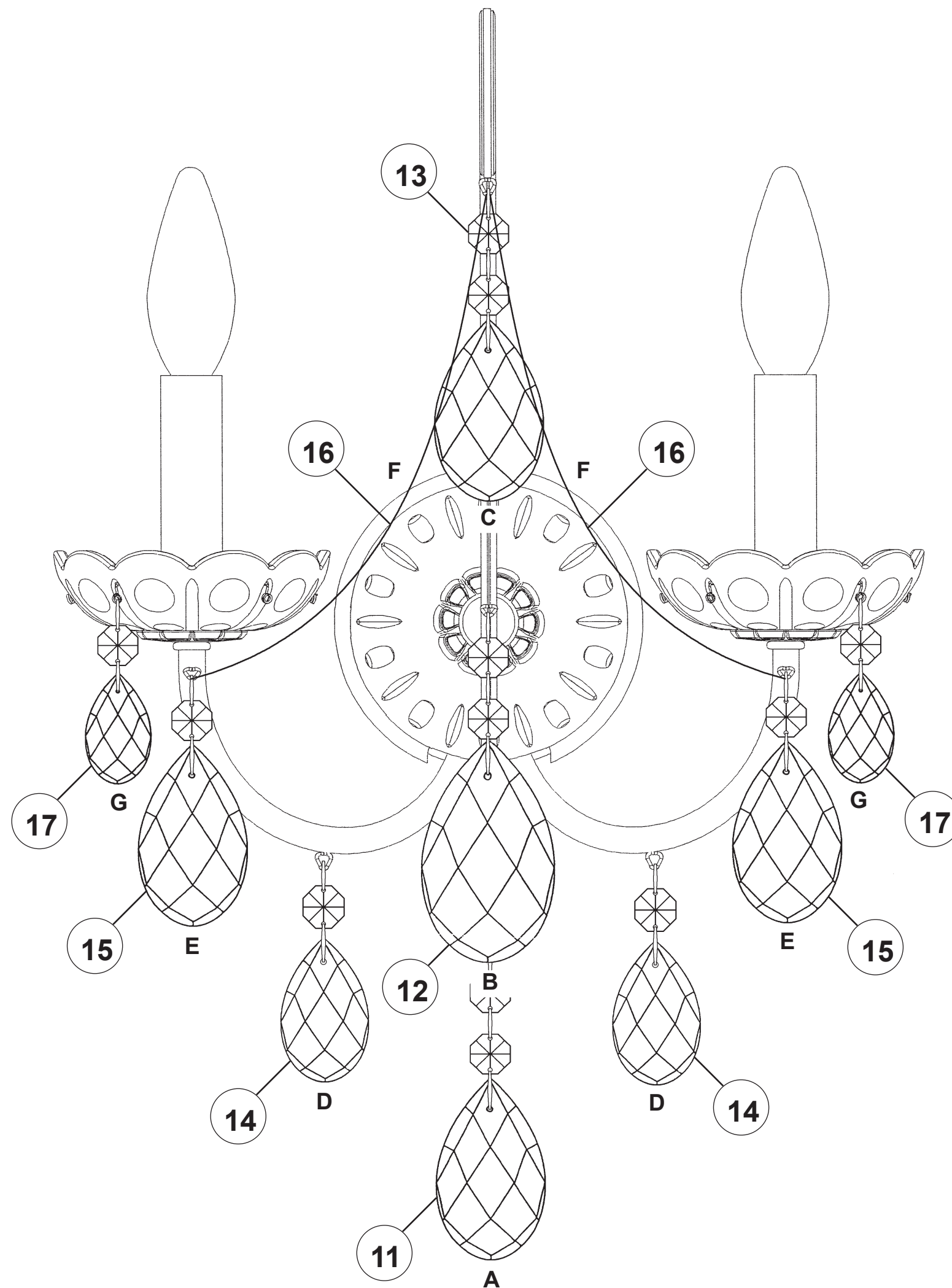

SONATINA ST1939N- __ __ S

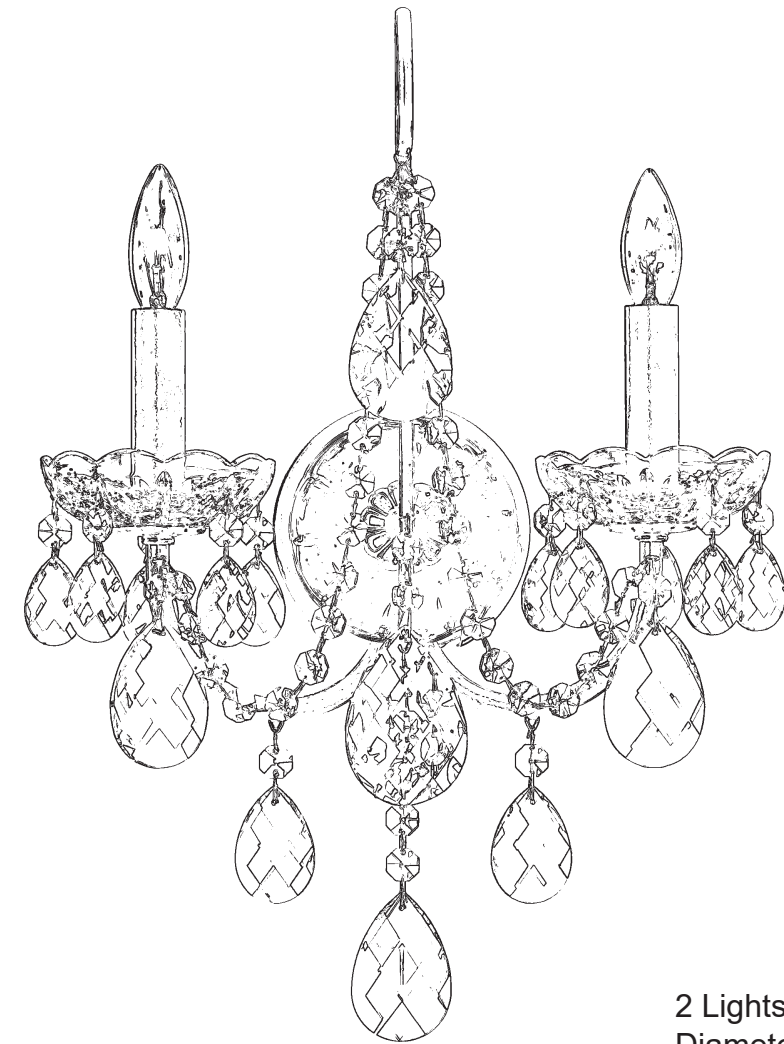











2 Lights
Diameter: 12-1/2"
Height: 17"
Extension: 5-1/2"
Hanging Weight: 3lbs.

THIS DESIGN IS THE PROPRIETARY
TRADE DRESS/TRADEMARK OF
W SCHONBEK LLC.

 **SCHONBEK** | 1870

 **SCHONBEK** | 1870

								
MAX <u>60</u> W	110-120 V							

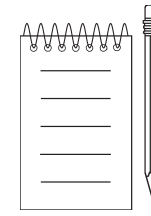
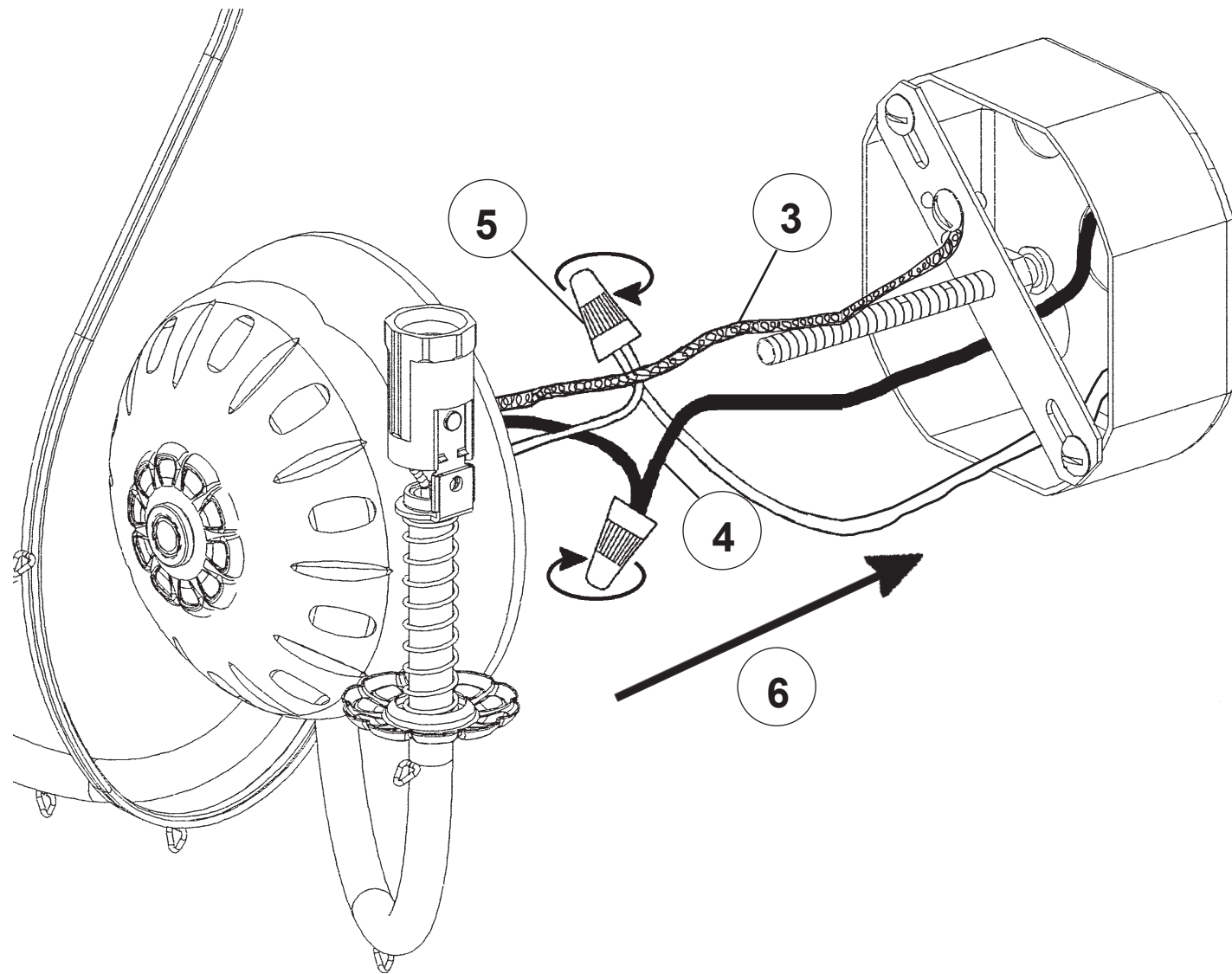
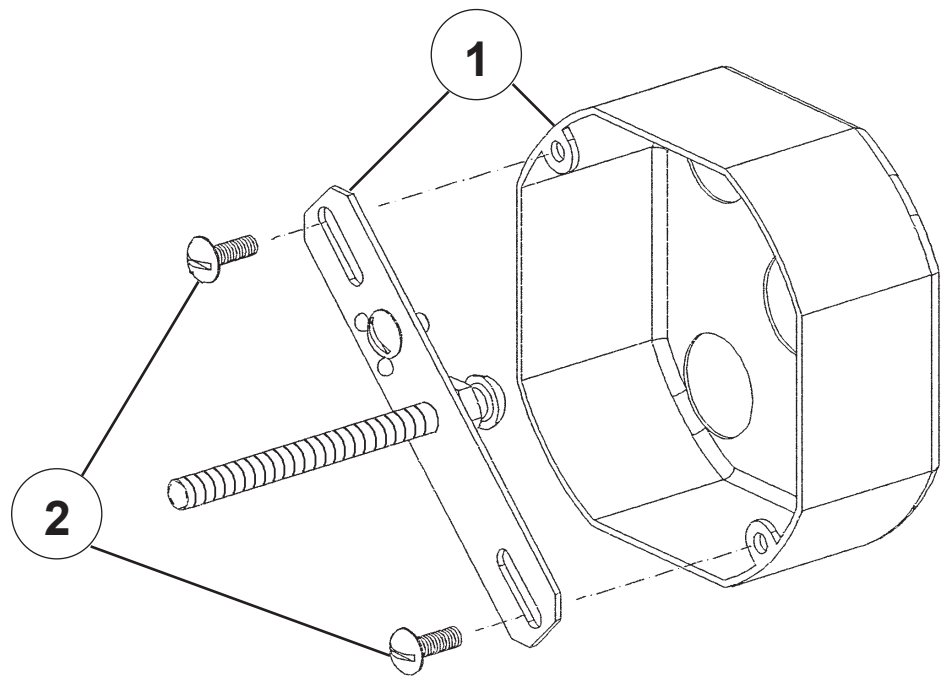

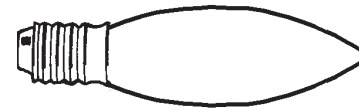
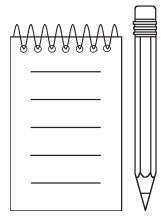

You will need 2 - B10
25 Watts Recommended
60 Watts Max

**Install bulbs and be sure
to test fixture BEFORE
trimming.**

