

BELLA ROSE TC1024N-__ __H

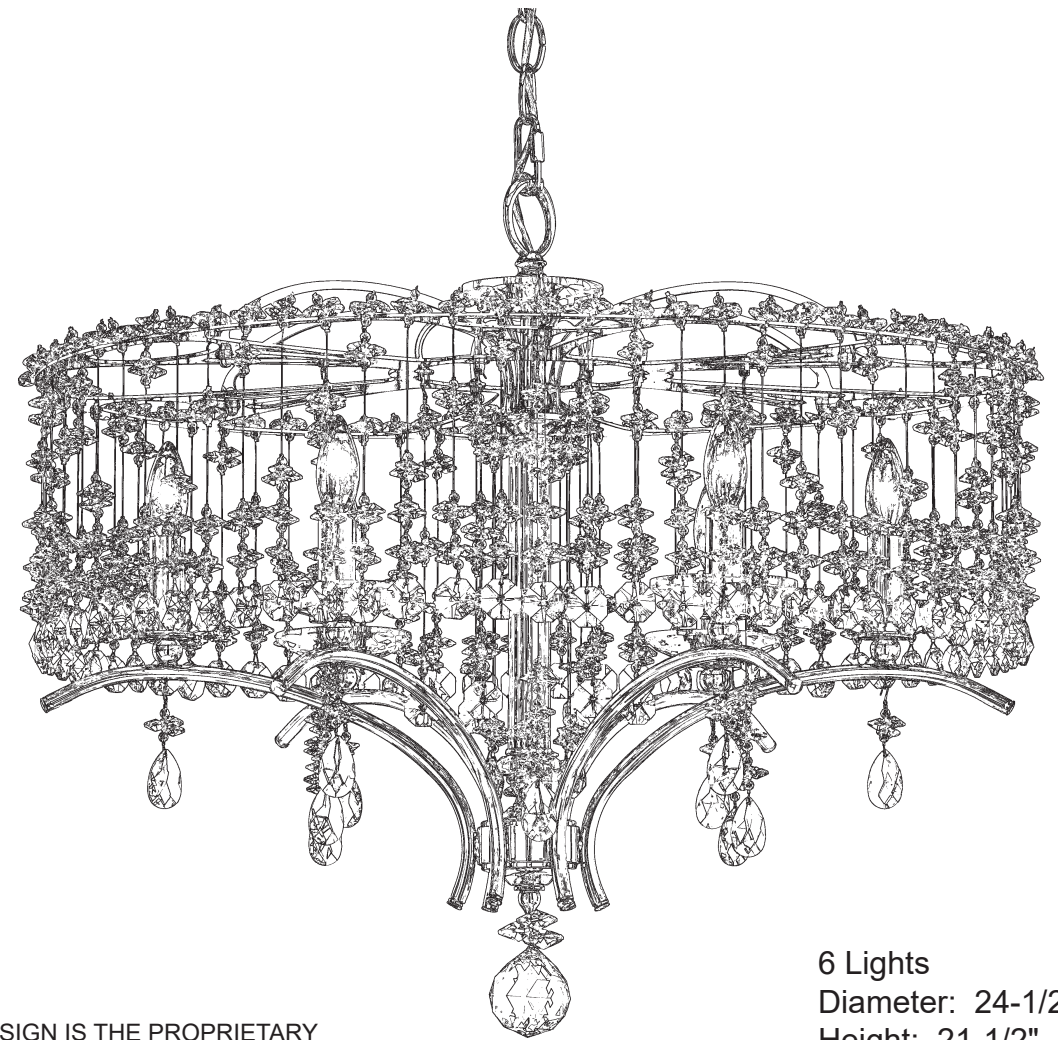











THIS DESIGN IS THE PROPRIETARY TRADE DRESS/TRADemark OF W SCHONBEK LLC.

6 Lights
Diameter: 24-1/2"
Height: 21-1/2"
Hanging Weight: 18lbs.

 **SCHONBEK** | 1870

 **SCHONBEK** | 1870

								
MAX 60 W	110-120 V							

WARNING:

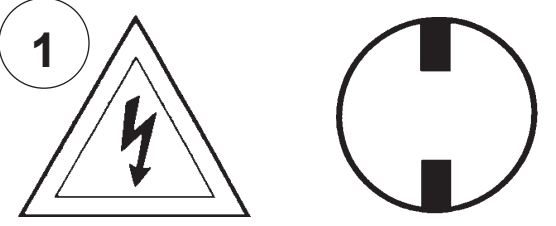
1 

Electrical Danger Turn Power Off

All electrical components must be installed by a licensed electrician in accordance with the National Electric Code and the appropriate local electrical codes.

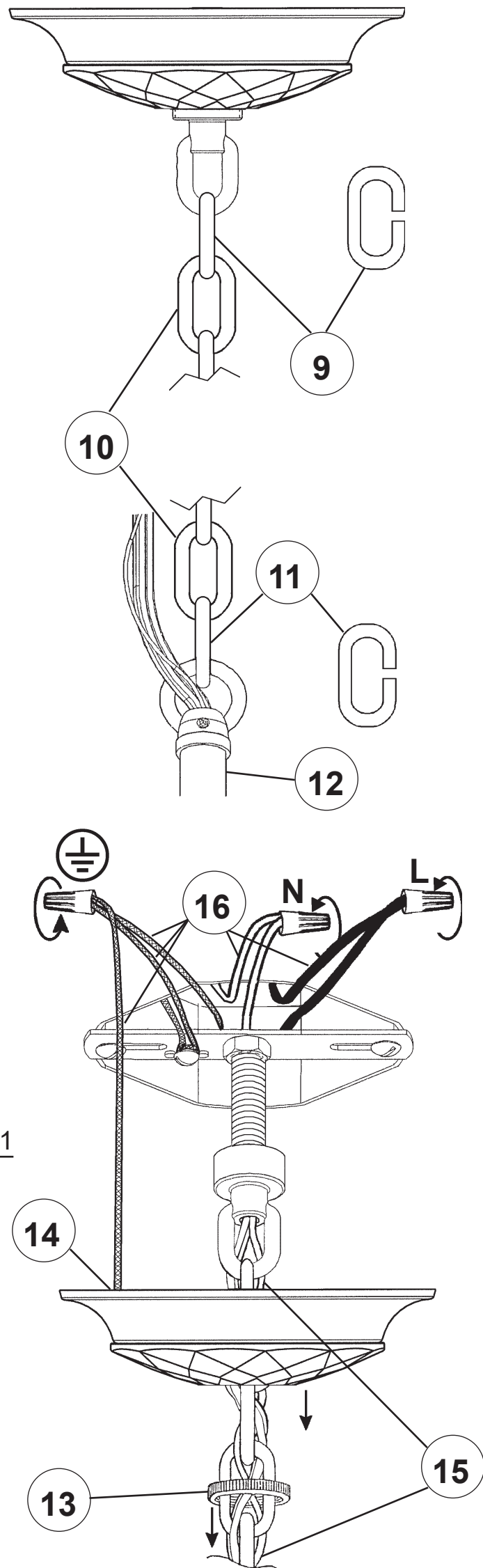
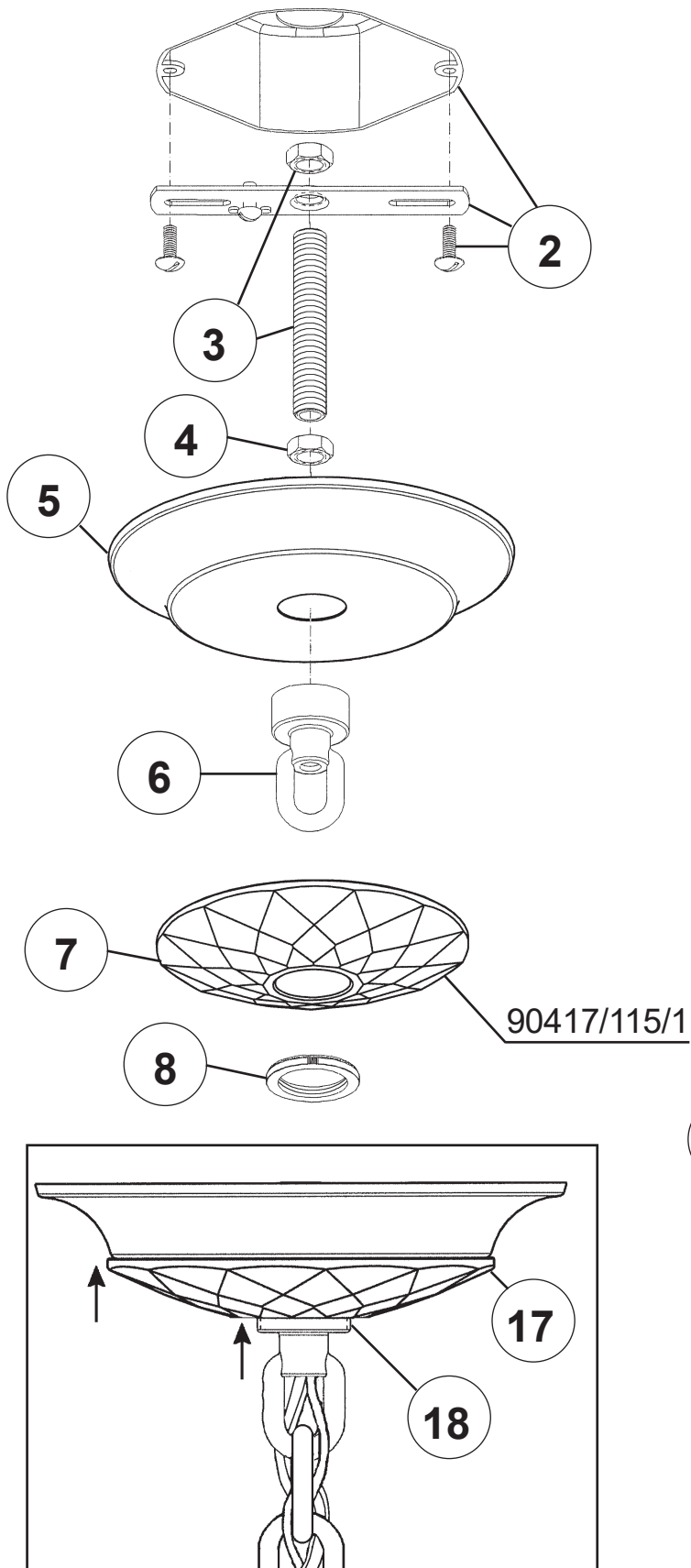

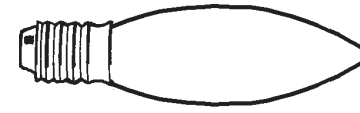
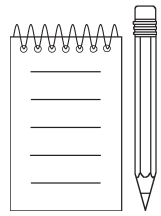

You will need 6 - B10
60 Watts Max

**Install bulbs and be sure
to test fixture BEFORE
trimming.**

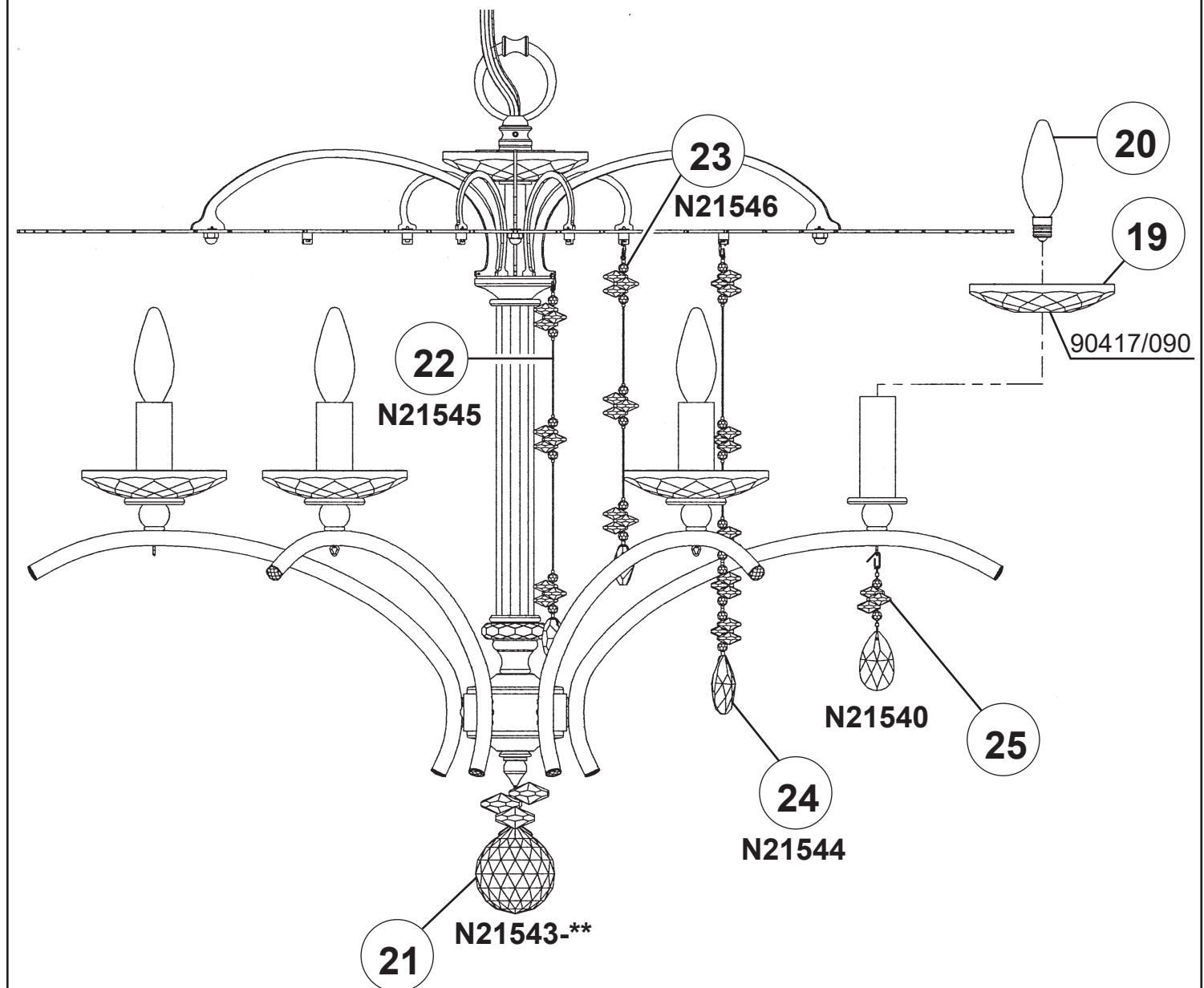

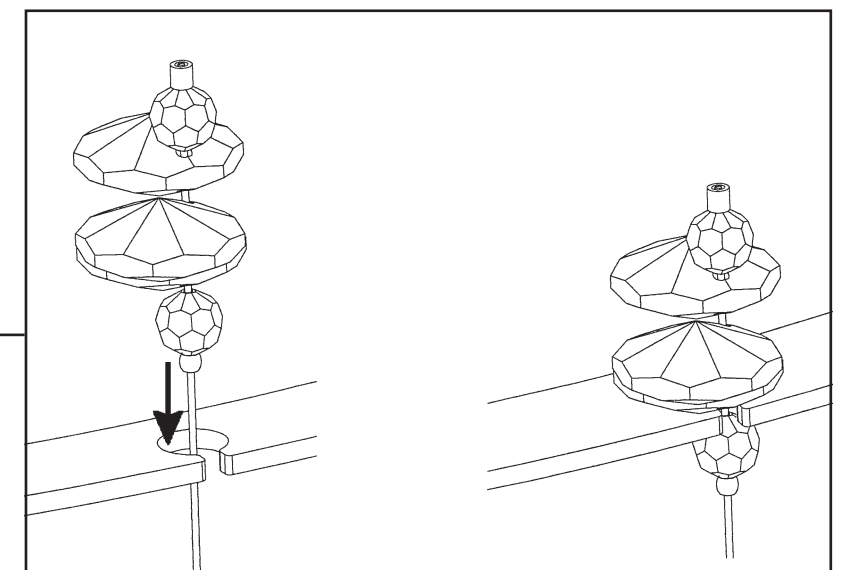
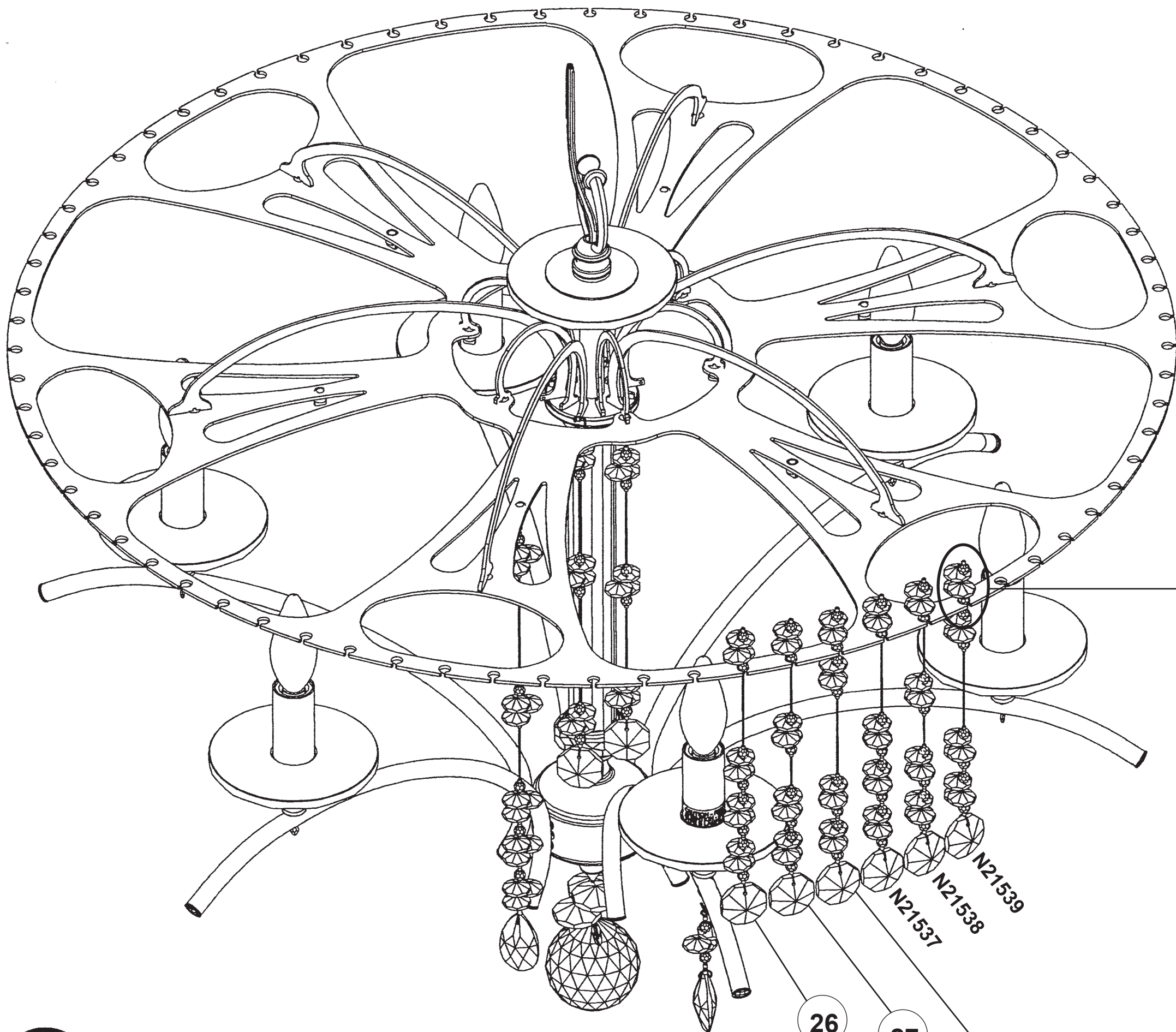

26
N21537

27
N21538

28
N21539

BELLA ROSE TC1024N-__ __R

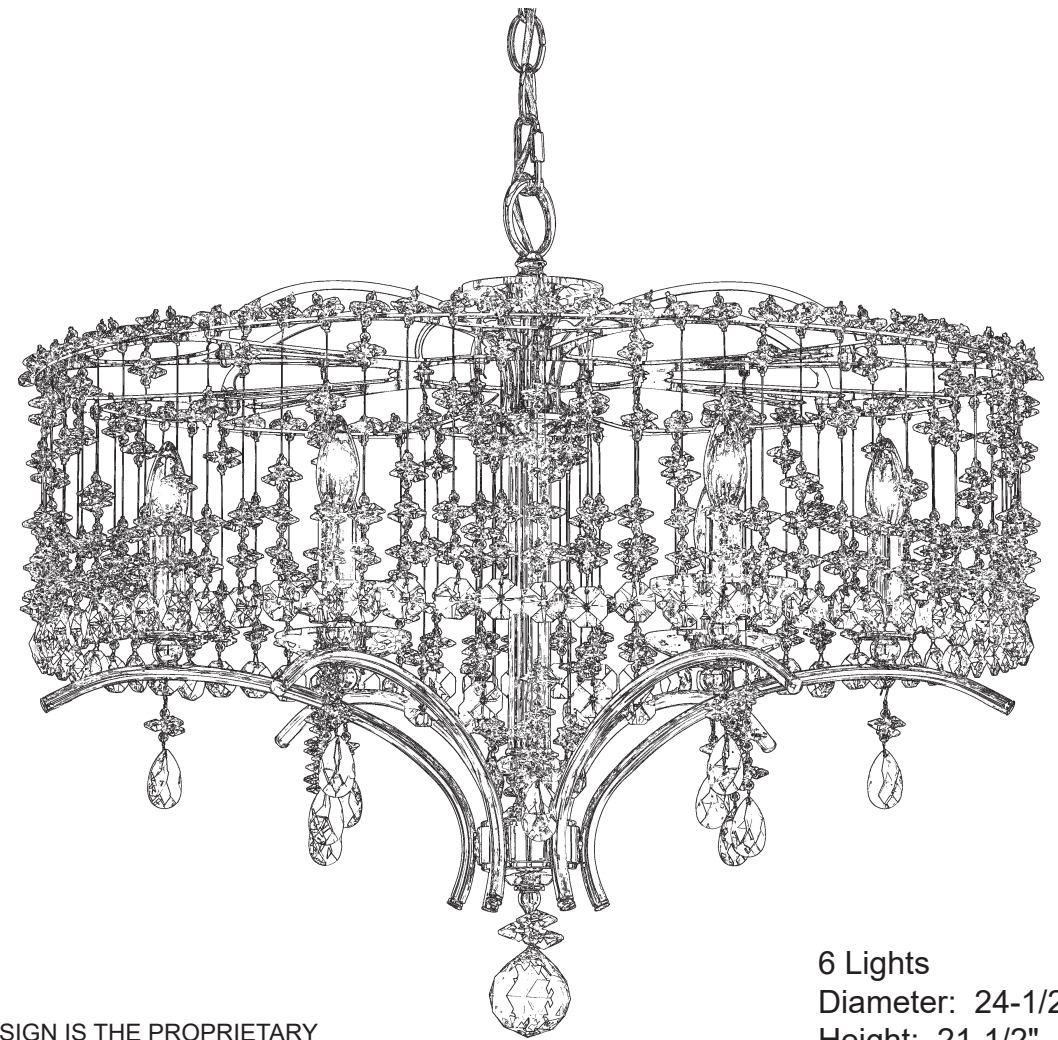











6 Lights
Diameter: 24-1/2"
Height: 21-1/2"
Hanging Weight: 18lbs.

THIS DESIGN IS THE PROPRIETARY
TRADE DRESS/TRADEMARK OF
W SCHONBEK LLC.

 **SCHONBEK** | 1870

 **SCHONBEK** | 1870

								
MAX 60 W	110-120 V							

WARNING:

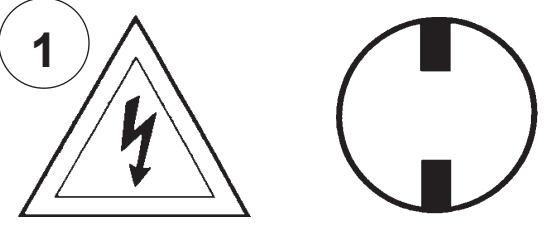
1 

Electrical Danger Turn Power Off

All electrical components must be installed by a licensed electrician in accordance with the National Electric Code and the appropriate local electrical codes.

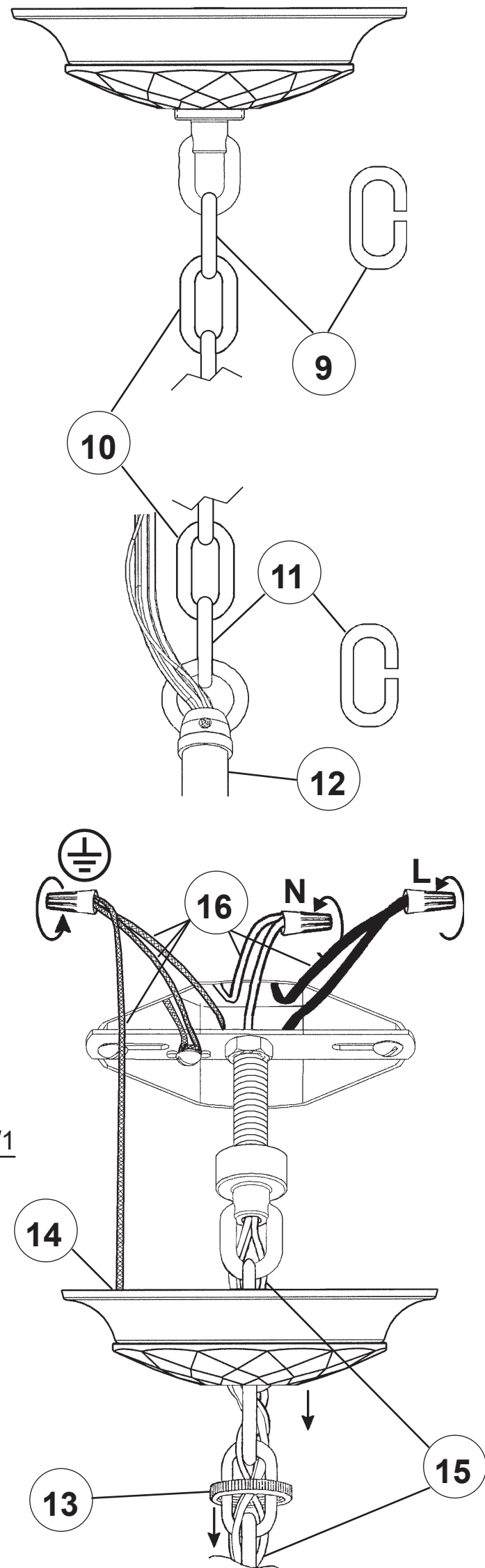
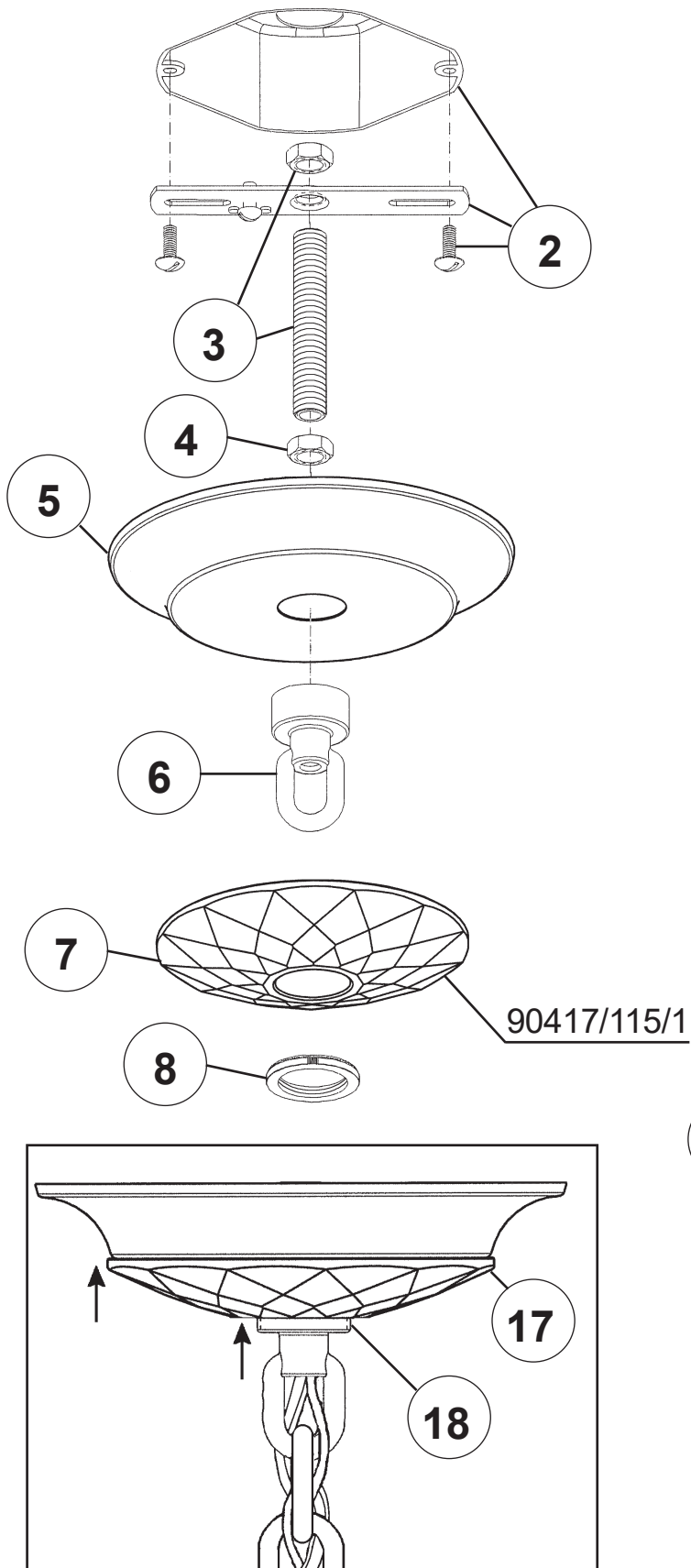

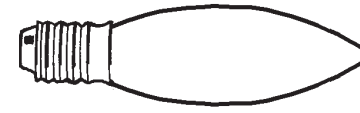
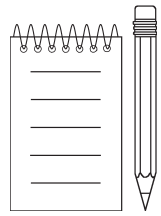

You will need 6 - B10
60 Watts Max

**Install bulbs and be sure
to test fixture BEFORE
trimming.**

